



20 PRIMLEY PARK WALK

LEEDS, LS17 7LB

£595,000
FREEHOLD

A rare chain-free opportunity to secure a substantial five-bedroom home in the heart of Alwoodley. Packed with potential, spacious rooms, and perfectly positioned in one of North Leeds' most desirable locations.

MONROE

SELLERS OF THE FINEST HOMES

Primley Park Walk, Leeds

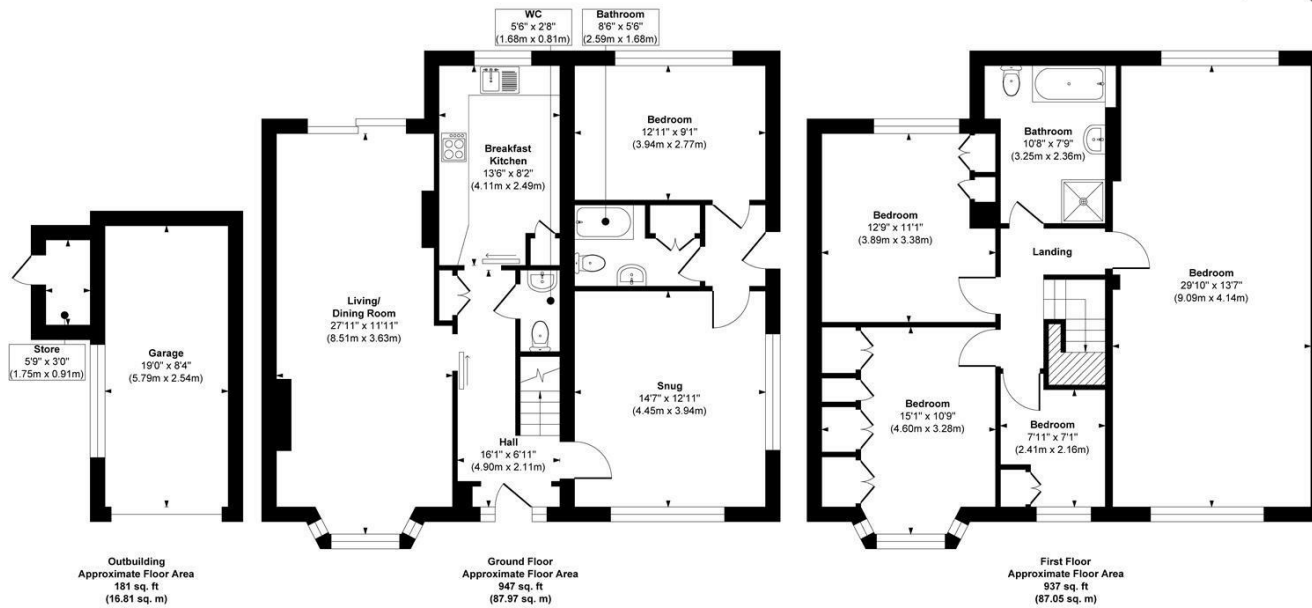

Approx. Gross Internal Floor Area 2065 sq. ft / 191.83 sq. m (Including Outbuilding)

Illustration for identification purposes only, measurements are approximate, not to scale.

Copyright © Show Home.

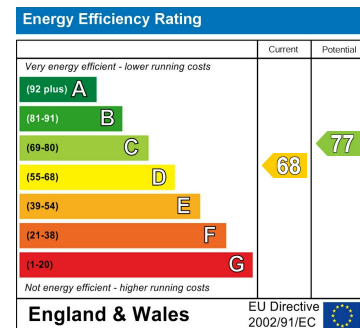
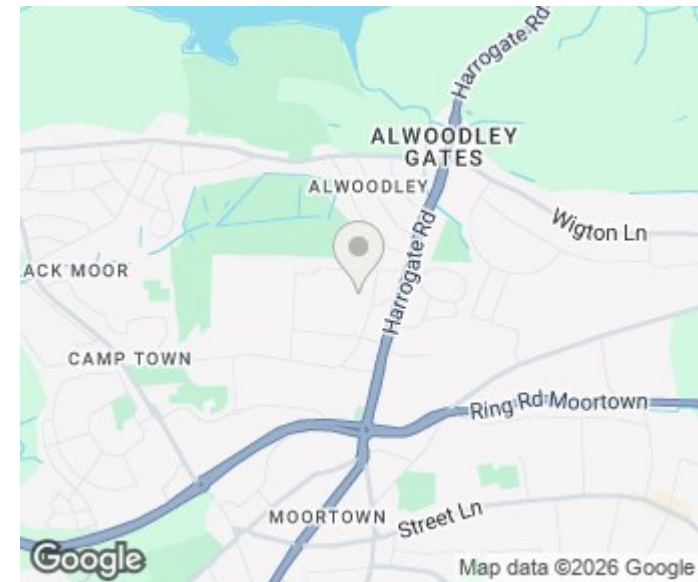

Agents Note: Whilst every care has been taken to prepare these particulars, they are for guidance purposes only. All measurements are approximate and are for general guidance purposes only and whilst every care has been taken to ensure their accuracy, they should not be relied upon and potential buyers/tenants are advised to recheck the measurements

Alwoodley Sales
716 King Lane Alwoodley
Leeds
West Yorkshire
LS17 7BA

0113 870 4443
hello@monroeestateagents.com
www.monroeestateagents.com

MONROE

SELLERS OF THE FINEST HOMES