



17 Somerset Avenue, Blackburn, BB1 9JD
£550,000

 5  4  4  D

17 Somerset Avenue, Blackburn, BB1 9JD

Situated in the highly regarded village of Wilpshire, on the edge of the Ribble Valley, this substantial Edwardian semi-detached residence offers an exceptional blend of period elegance and modern family living with the added benefit of a one bedroom attached annexe. Extending to just under 2,500 sq ft and arranged over three storeys, the property has been thoughtfully extended and beautifully maintained, creating a spacious and versatile home. Enjoying open views to the rear and presented in superb condition throughout, this is a rare opportunity to acquire a character-filled home in a sought-after residential setting.

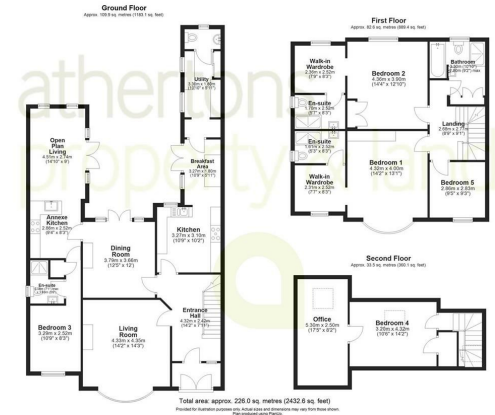

Energy Efficiency Rating		Environmental Impact (CO ₂) Rating	
	Current	Potential	
Very energy efficient - lower running costs			Very environmentally friendly - lower CO ₂ emissions
(92 plus) A			(92 plus) A
(81-91) B			(81-91) B
(69-80) C			(69-80) C
(55-68) D			(55-68) D
(39-54) E			(39-54) E
(21-38) F			(21-38) F
(1-20) G			(1-20) G
Not energy efficient - higher running costs			Not environmentally friendly - higher CO ₂ emissions
England & Wales	EU Directive 2002/91/EC	65	76
			England & Wales
			EU Directive 2002/91/EC

These particulars, whilst believed to be accurate are set out as a general outline only for guidance and do not constitute any part of an offer or contract. Intending purchasers should not rely on them as statements of representation of fact, but must satisfy themselves by inspection or otherwise as to their accuracy. No person in this firm's employment has the authority to make or give any representation or warranty in respect of the property.