



## Colne Road, TW2

£1,750 Per calendar month

A rarely available two bedroom, two bathroom warehouse flat. The accommodation is spread over two levels and there is a stunning living space with wooden flooring and bi-folding doors which lead out to a private decked area.

Perfectly located for both those who want the weekend stroll to Twickenham Green and the easy commute into the city from Twickenham Station which is under a mile away.

### Features

- Contemporary Apartment
- Two Bedrooms
- Two Bathrooms
- Stunning Living Space
- Integrated Kitchen
- Outside Space

# Colne Road, Twickenham, TW2

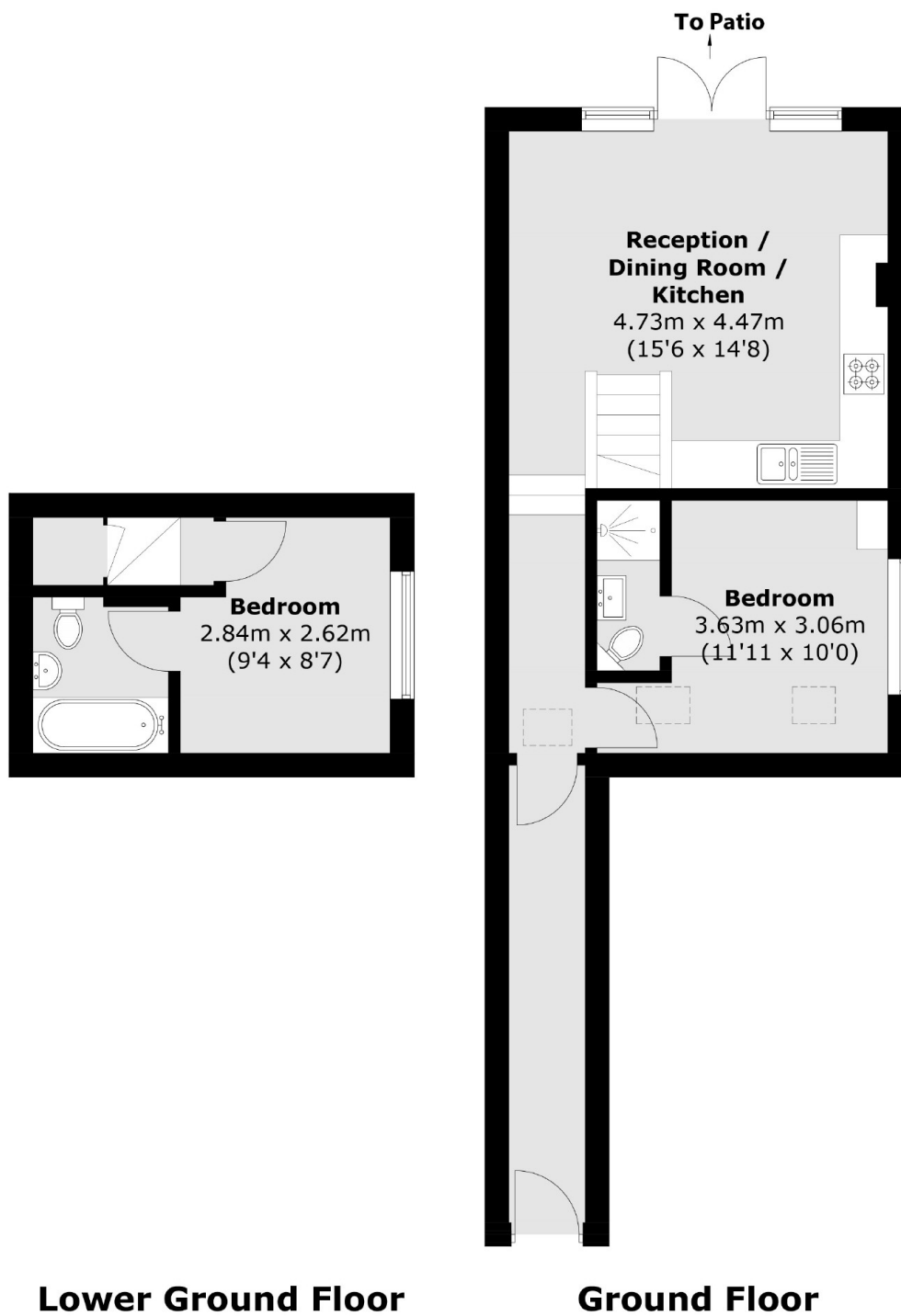

Total area (approx.): 55.8 sq. m (600.6 sq. ft)

**Dexters**

Twickenham  
84 Heath Road  
Twickenham  
TW1 4BW  
Lettings  
020 8744 2233

Energy Rating: D. We aim to make our particulars both accurate and reliable. However they are not guaranteed; nor do they form part of an offer or contract. If you require clarification on any points then please contact us, especially if you're traveling some distance to view. Please note that appliances and heating systems have not been tested and therefore no warranties can be given as to their good working order.

 **RICS** | Regulated  
Estate Agent  
and Letting Agent

dexters.co.uk