

Clifton Park View 15-21 Doncaster Gate, Rotherham, S65 1DE

£750 Per month

Zero Deposit Option Available

Nestled in the charming building of Clifton Park View, this delightful apartment offers a perfect blend of comfort and convenience. Located in the heart of Doncaster Gate, Rotherham, this property is ideal for those seeking a modern living space with easy access to local amenities.

The apartment is accessed via a private entrance door and features a well-proportioned reception room, providing a welcoming area for relaxation and entertainment. The bedroom is designed to be both cosy and functional, making it an excellent retreat after a long day. The bathroom is thoughtfully appointed, ensuring that all your daily needs are met with ease.

This property is perfect for individuals or couples looking for a low-maintenance lifestyle without compromising on quality. With its prime location, residents can enjoy the nearby parks, shops, and transport links, making it easy to explore the vibrant surroundings.

Do not miss the opportunity to make this charming space your own.

Floor Plan

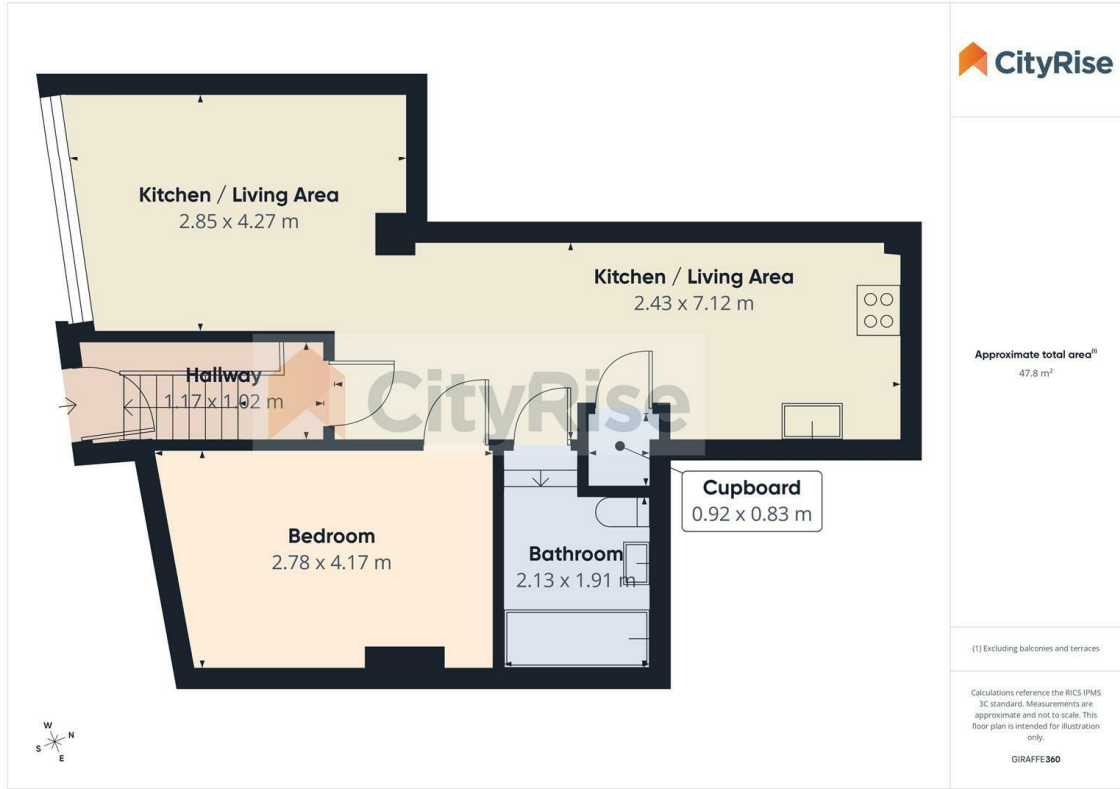

Area Map

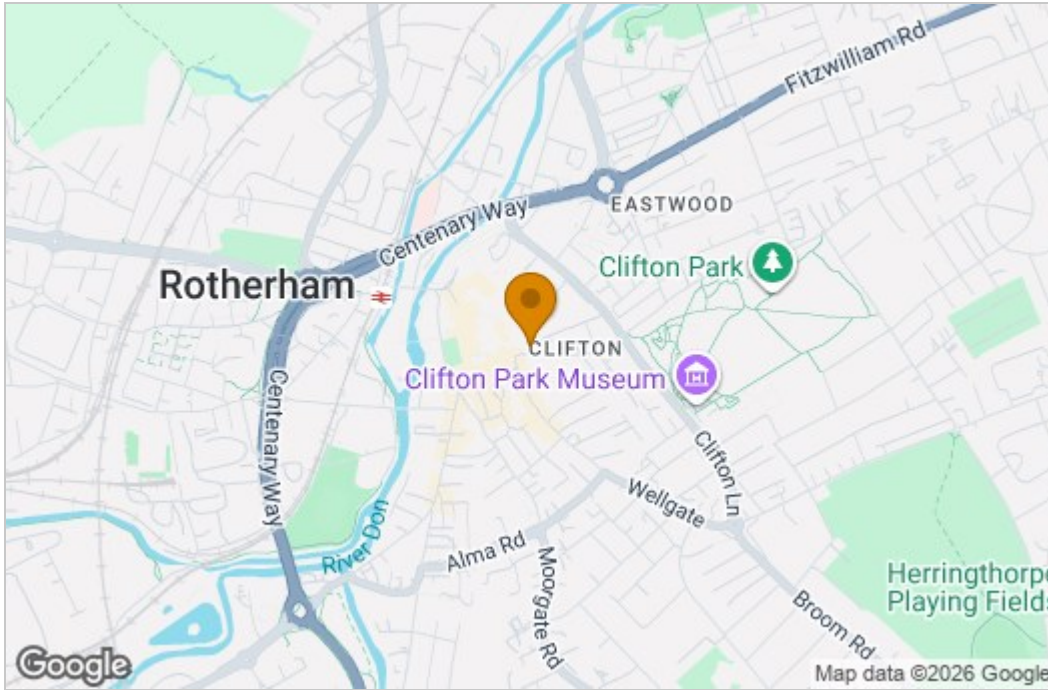

Energy Efficiency Graph

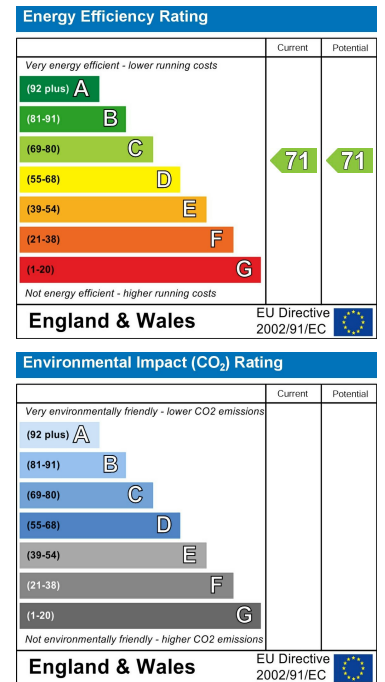

These particulars, whilst believed to be accurate are set out as a general outline only for guidance and do not constitute any part of an offer or contract. Intending purchasers should not rely on them as statements of representation of fact, but must satisfy themselves by inspection or otherwise as to their accuracy. No person in this firm's employment has the authority to make or give any representation or warranty in respect of the property.