

**HS HAIR & SON**



## Hamlet Court Road , Westcliff-on-Sea SS0 7EX

- Popular retirement complex
- Good size lounge/diner
- Westcliff station right outside the complex
- 24 hour emergency pull cord system
- Over 60's only please (a partner can be 55)
- One bedroom
- Hamlet Court Road on the doorstep
- Well-maintained block
- Double glazed
- Full lift service

**Guide Price £125,000 Leasehold**

Local Authority **Southend on Sea Borough Council**  
Council Tax Band **C**  
EPC Rating **B**

### Fourth Floor

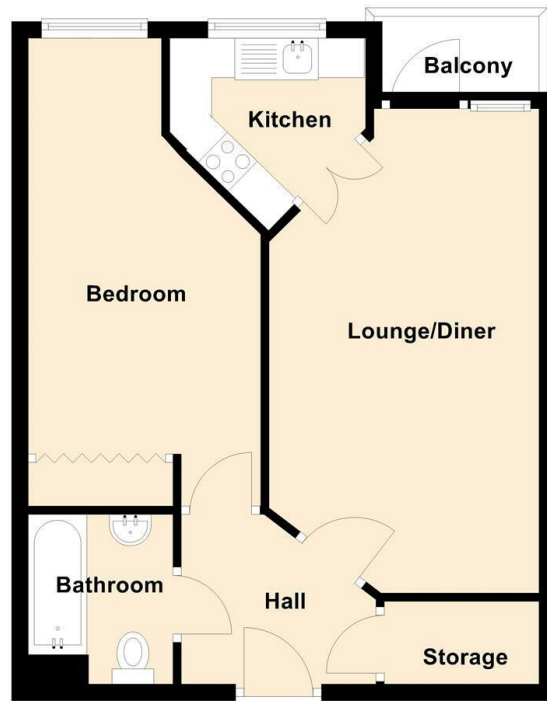

**Sales Office**  
190 London Road, Southend-On-Sea,  
Essex, SS1 1PJ

**Contact**  
01702 34 11 77  
<https://hairandson.co.uk/>

Agents Note: Whilst every care has been taken to prepare these particulars, they are for guidance purposes only. All measurements are approximate and for general guidance purposes only and whilst every care has been taken to ensure accuracy, they should not be relied upon and potential buyers/tenants are advised to recheck the measurements.