



The Glebe  
Camberley, GU17 9BA  
£385,000

## Property Details

 3 bedrooms

 1 baths

 EPC Rating TBC

 1128 sqft

 Blackwater Station (0.4 miles)

- No onward chain
- Three double bedrooms
- Downstairs cloakroom and bathroom upstairs
- Spacious living/dining room
- Kitchen
- Enclosed low maintenance rear garden
- Integral garage with potential to convert subject to regulations
- Very convenient for local shops and amenities at Blackwater
- Good local schools

This well-proportioned three-bedroom semi-detached house is located in the sought after area of The Glebe near to the heart of Blackwater. The property boasts an open plan living/dining room which leads to a conservatory. There is also a downstairs cloakroom and the kitchen. Upstairs you will find three spacious bedrooms and a family bathroom. The property also features off road parking for two cars, an integral garage and a private low maintenance rear garden. The house is conveniently located near to Blackwater train station, local schools, shops and amenities. With no onward chain this property offers a great opportunity for buyers looking for a hassle-free purchase.



## Property Details

### The Glebe

Approximate Gross Internal Area = 92.3 sq m / 994 sq ft  
Approximate Garage Internal Area = 12.4 sq m / 134 sq ft  
Approximate Total Internal Area = 104.7 sq m / 1128 sq ft

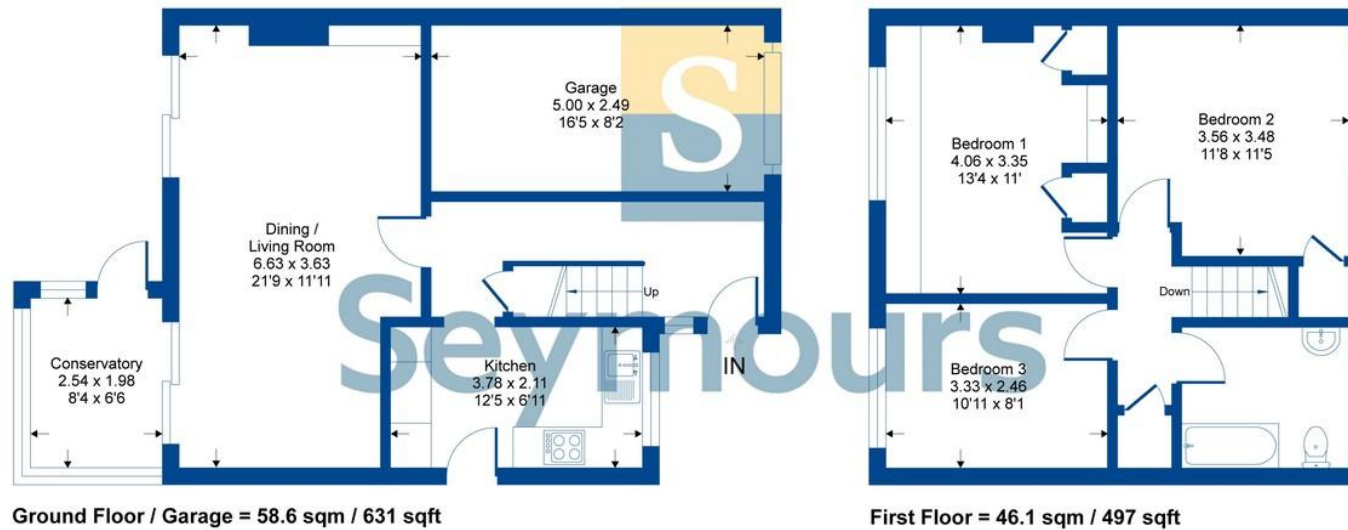

Whilst every attempt has been made to ensure the accuracy of the floor plan contained here, measurements of doors, windows, rooms and any other items are approximate and no responsibility is taken for any error, omission or mis-statement. This plan is for illustrative purposes only and should be used as such by any prospective purchaser.

Seymours Blackwater Office 6 Kings Parade, 34 London Road, Blackwater, Camberley, Surrey, GU17 9AA  
01276 534100 / james@seymours-blackwater.co.uk / seymours-estates.co.uk

The information contained in these Sales Particulars does not form part of any contract neither is any warranty given or implied by Seymours or their clients as to the accuracy of measurements of details stated. Every effort is made to ensure that our Sales Particulars are correct and reliable. We do not test service, systems and appliances and we are unable to verify they are in working order.