



32 BROOM FARM ROAD

Elsenham, Bishop's Stortford, CM22 6LD

£425,000



COMMERCIAL | RESIDENTIAL | LETTINGS

www.jamesandco.net

- Three Bedrooms
- Bathroom including Shower
- Two Reception Rooms
- Driveway Parking
- Garden
- Village Location
- Double Glazed
- Kitchen





Property Description

THE PROPERTY

**** COMING SOON **** Three bedroom mid terrace property.
Driveway parking.

Freehold

All main services connected

Council Tax Band C

EPC awaiting

THE LOCATION

Elsenham is a sizeable North Essex village with primary school, Tesco Express supermarket, hairdressing salon, fish and chip shop, post office/shop, village inn and mainline station to London Liverpool Street.

The village is approximately 4 miles from the market town of Bishop's Stortford where there are further shopping, educational and recreational amenities, including a mainline station.

The historic market town of Saffron Walden lies approximately 8 miles to the north of Elsenham and offers further comprehensive facilities.

ENTRANCE HALL

LIVING ROOM

18' 9" x 16' 9" (5.73m x 5.11m)

FAMILY ROOM

10' 5" x 9' 11" (3.20m x 3.04m)

KITCHEN

9' 11" x 7' 11" (3.04m x 2.43m)

FIRST FLOOR

LANDING

BEDROOM 1

13' 1" x 10' 11" (4.01m x 3.34m)

BEDROOM 2

12' 2" x 11' 8" (3.73m x 3.58m)

BEDROOM 3

BATHROOM

OUTSIDE

Garden and driveway parking.



Ground Floor

Approx. 52.0 sq. metres (559.9 sq. feet)

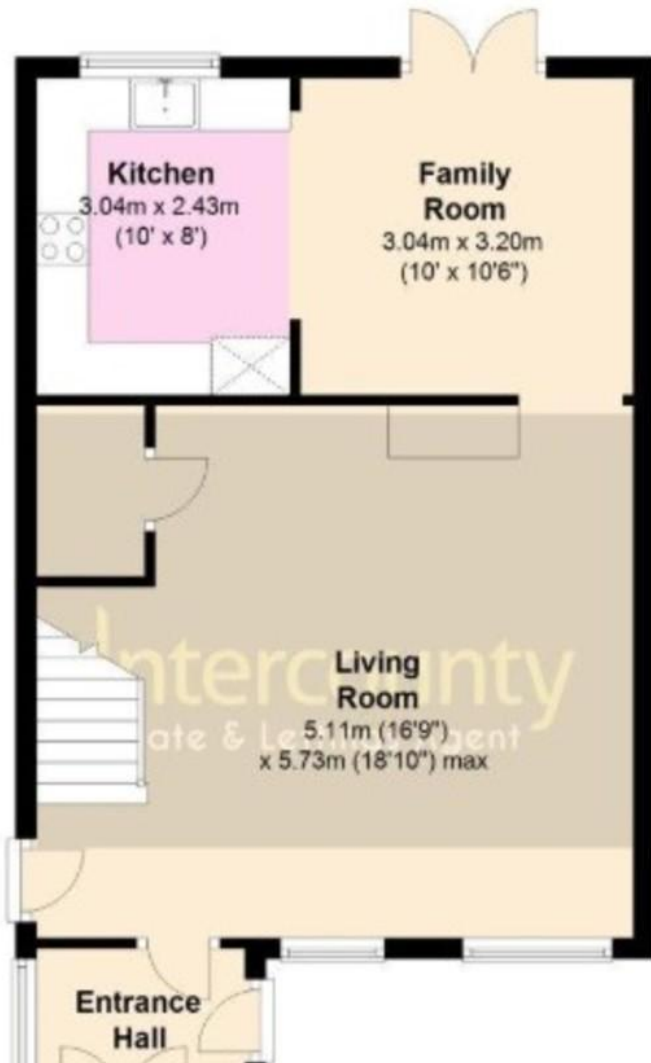

First Floor

Approx. 47.4 sq. metres (510.1 sq. feet)

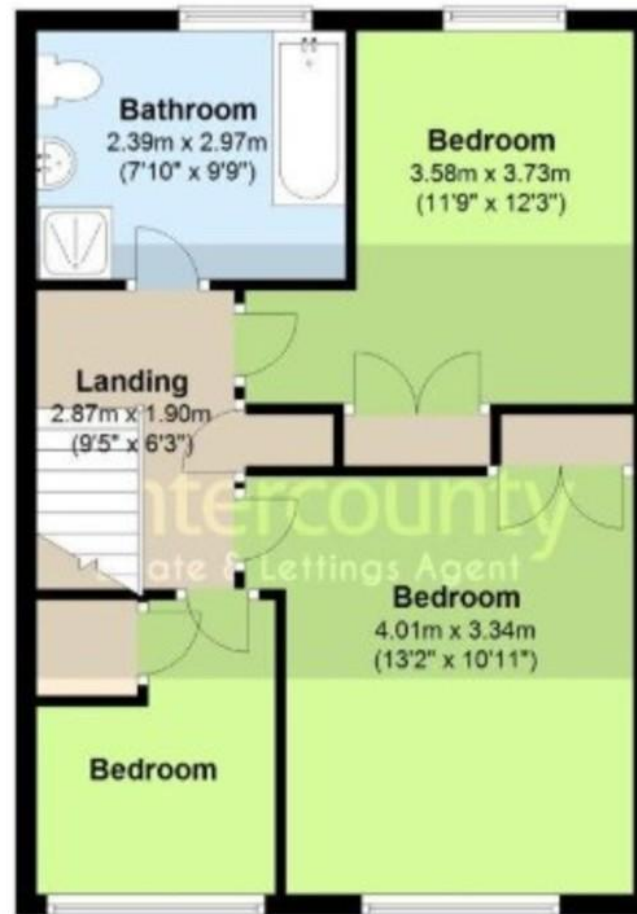

COUNCIL TAX BAND

Tax band C

TENURE

Freehold

LOCAL AUTHORITY

Uttlesford District Council

Agents Note: Whilst every care has been taken to prepare these sales particulars, they are for guidance purposes only. All measurements are approximate and for general guidance purposes only and whilst every care has been taken to ensure their accuracy, they should not be relied upon and potential buyers are advised to recheck the measurements.

JAMES&CO

4 Stortford Road, Dunmow, Essex, CM6 1DA

01371 876678

info@jamesandco.net

www.jamesandco.net

