

Property Details

17E College Medway, Dalkeith,
Midlothian, EH22 3FS

Offers Over **£210,000**



Property Photos

17E College Medway, Dalkeith, Midlothian, EH22 3FS



Creation Date
21/05/2026

Property Photos

17E College Medway, Dalkeith, Midlothian, EH22 3FS



Creation Date
21/05/2026

Property Photos

17E College Medway, Dalkeith, Midlothian, EH22 3FS



Creation Date
21/05/2026

Property Photos

17E College Medway, Dalkeith, Midlothian, EH22 3FS



Creation Date
21/05/2026

Property Floor Plans

17E College Medway, Dalkeith, Midlothian, EH22 3FS

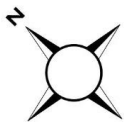
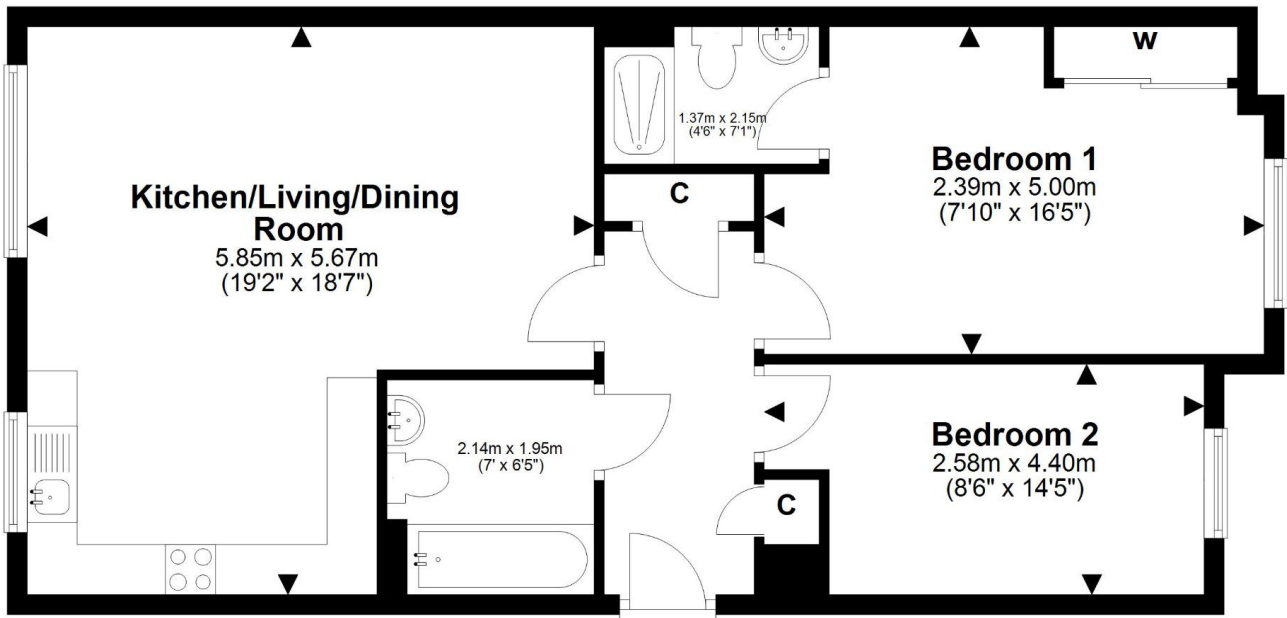

This plan is for illustrative purposes only and should only be used as such by a prospective purchaser.
For details of the internal floor area, please refer to the Home Report.

Creation Date

21/05/2026

Property Info

17E College Medway, Dalkeith, Midlothian, EH22 3FS

Property Type

Flats / Apartments

Property Style

Apartment

Bedrooms

2

Bathroom

2

Receptions

1

Tenure Type

Freehold

Floor Area

775 Sq Ft

Agency Type

Sole

Parking

Private

Type

Sales

Electricity

Mains Supply

Creation Date

21/05/2026

Property Info

17E College Medway, Dalkeith, Midlothian, EH22 3FS

Water Supply

Mains

Sewerage

Mains Supply

Heating

Gas Central

Broadband

-

Accessibility

-

Restrictions

-

Condition

Good

Flooded In Last Five Years

No

Current Annual Ground Rent

-

Current Service Charge

-

Rent Review Period (Year)

-

Creation Date

21/05/2026

Property Info

17E College Medway, Dalkeith, Midlothian, EH22 3FS

Ground Rent Percentage Increase

-

Service Review Period (Year)

-

Lease End Date

-

Price Qualifier

Offers Over

Price

£210,000

Land Size

-

Age of Property

-

Year Built

-

New Home

No

Creation Date

21/05/2026

Property Features

17E College Medway, Dalkeith, Midlothian, EH22 3FS

Feature 1

Beautifully Maintained And Generously Proportioned Two-bedroom First-floor Apartment

Feature 2

Exclusive Modern Development

Feature 3

Ideally Suited To First-time Buyers, Professionals, Downsizers Or Investors Seeking A Property In A Sought-after Commuter Location

Feature 4

Spacious Open-plan Living, Dining And Kitchen Area

Feature 5

Generous Principal Bedroom With En-suite Shower Room

Feature 6

Second Double Bedroom

Feature 7

Spacious Modern Family Bathroom With A White Three-piece Suite

Feature 8

Allocated Parking Space

Feature 9

Gas Central Heating And Double Glazing

Feature 10

Communal Garden Grounds

Creation Date

21/05/2026

Property Description

17E College Medway, Dalkeith, Midlothian, EH22 3FS

17E College Medway, Dalkeith, Midlothian, EH22 3FS

Watermans are delighted to present this beautifully maintained and generously proportioned two-bedroom first-floor apartment, peacefully positioned within an exclusive modern development in the highly desirable Eskbank area of Midlothian. Tucked away in a quiet cul-de-sac, the property offers contemporary living in a prime location close to excellent local amenities, Eskbank railway station and the nearby towns of Bonnyrigg and Dalkeith.

Presented in true walk-in condition, this stylish home is ideally suited to first-time buyers, professionals, downsizers or investors seeking a property in a sought-after commuter location.

The accommodation comprises a secure entry system leading to a welcoming reception hallway with excellent built-in storage. Fully tiled modern flooring in all rooms, carpeted bedrooms aside, and neutral modern decor throughout provides welcoming touches and a 'move straight in' feel. At the heart of the home is a bright and spacious open-plan living, dining and kitchen area enhanced by a large double window with Juliet balcony creating an ideal space for both relaxing and entertaining. Feature lighting completes the modern feel of the room. The fitted kitchen is well-appointed with a range of wall and base white gloss units with grey laminate worktop, gas hob, extractor hood, oven and integrated appliances including a dishwasher, washing machine, and fridge freezer. The generous principal bedroom is decorated with neutral tones, benefits from carpeted flooring, mirrored fitted wardrobes and a contemporary en-suite shower room with double shower cubicle. The second double bedroom is equally spacious and well presented completed with carpeted flooring. A spacious modern family bathroom with a white three-piece suite, mains shower over bath, contemporary tiling and chrome towel rail completes the accommodation.

Further benefits include gas central heating, double glazing, an allocated parking space, additional visitor parking, communal garden grounds, and secure bin and bike storage.

Creation Date

21/05/2026

Property Description

17E College Medway, Dalkeith, Midlothian, EH22 3FS

Included in the sale are all fitted floor coverings, light fittings, blinds where fitted, and integrated kitchen appliances including the oven, hob, washing machine, dishwasher, and fridge freezer.

The highly desirable and historical area of Eskbank is a much sought-after location within Midlothian providing a vast range of houses and buildings dating back to Edwardian and Victorian times with additional new build housing estates, providing the choice for a vast range of potential purchasers. There are a range of local shops and recreational facilities within easy reach including golf courses and sporting facilities with the neighbouring towns of Dalkeith, Lasswade and Bonnyrigg providing further choice. A wider selection of retail outlets can be found close-by at Fort Kinnaird, Straiton Retail Park, and Cameron Toll. The area is served by a variety of supermarkets, restaurants and leisure facilities. Local schooling is excellent with the highly acclaimed King's Park and Lasswade Primary schools nearby with High School Education available in Lasswade High and Dalkeith Campus. Eskbank is popular with commuters with easy access to the City Bypass with regular public transport links to the City Centre. The borders rail line provides a fast and efficient link between the Borders, Midlothian and Edinburgh with Eskbank having its own train station further enhancing the area and providing a marvellous alternative for commuters.

Early viewing is highly recommended to fully appreciate the quality, space, and excellent location this fantastic property has to offer.

Viewing by appointment only. Call Neil Reid at Watermans 7 days on 0131 547 7075

Creation Date

21/05/2026