



75 Earls Mill Road

Plympton, Plymouth, PL7 2BX

£240,000



Centrally-located terraced home - ideally situated, with easy access to local amenities, schools & bus routes. It briefly consists of an entrance porch, lounge & separate dining room, kitchen, 3 bedrooms, family bathroom & an attic room. The property also benefits from off-street parking (accessed from a rear lane) with gardens to both front & rear.



75 EARLS MILL ROAD, PLYMPTON, PLYMOUTH PL7 2BX

ACCOMMODATION

Obscured uPVC double-glazed door opening into the entrance porch.

ENTRANCE PORCH 5'7" x 4'0" (1.72 x 1.24)

Door opening into the lounge. uPVC double-glazed windows to the front and side elevations.

LOUNGE 14'7" x 13'1" (4.47 x 4.01)

Gas fire set onto a tiled hearth with inset surround and wooden mantel over. Stairs ascending to the first floor landing. uPVC double-glazed window to the front elevation with views out over Plympton and beyond. Door opening to the dining room.

DINING ROOM 10'0" x 7'10" (3.05 x 2.40)

Under-stairs cupboard. 2 further storage cupboards (one wall-mounted housing the boiler). uPVC double-glazed windows to the rear elevation. uPVC double-glazed patio door opening to the garden. Open plan access into the kitchen.

KITCHEN 9'10" x 6'2" (3.01 x 1.89)

Fitted with a modern range of matching base and wall-mounted units incorporating a roll-edged wood-effect laminate worktop with inset one-&-a-half bowl stainless-steel sink unit and mixer tap. Inset 4-burner gas hob with extractor over. Integrated oven. Spaces for washing machine and upright fridge/freezer. Complementary brick-effect tiling to the walls. uPVC double-glazed window to the rear elevation.

FIRST FLOOR LANDING 8'2" x 6'0" (2.49 x 1.84)

Doors providing access to the first floor accommodation. Drop-down loft hatch providing access to the attic room.

BEDROOM ONE 14'6" x 8'4" (4.43 x 2.56)

uPVC double-glazed window to the front elevation with views out over Plympton.

BEDROOM TWO 9'4" x 8'4" (2.86 x 2.55)

uPVC double-glazed window to the rear elevation overlooking the garden.

BEDROOM THREE 9'9" x 6'0" (2.99 x 1.83)

Built-in over-stairs storage cupboard. uPVC double-glazed window to the front elevation.

BATHROOM 6'0" x 5'5" (1.83 x 1.67)

Matching suite comprising a curved panelled bath with an electric shower over, pedestal wash handbasin with mixer tap and close-coupled wc. Fully-tiled walls. Electric shaving point. Obscured uPVC double-glazed window to the rear elevation.

ATTIC ROOM 13'2" x 10'4" (4.02 x 3.17)

Wooden-framed Velux window.

OUTSIDE

The property is approached via steps ascending to the front door, bordered on one side by a tiered garden laid mainly to stone chippings, with mature shrubs, trees and decorative pot plants. The rear garden includes an area laid to decking, with a brick-paved patio and steps ascending to the off-road parking.

COUNCIL TAX

Plymouth City Council

Council Tax Band: B

PLYMPTON SERVICES

The property is connected to all the mains services: gas, electricity, water and drainage.

WHAT3WORDS

///waters.finishing.detect

Area Map



Floor Plans

GROUND FLOOR

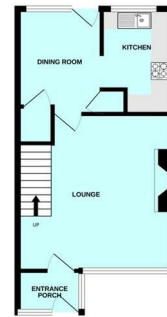

1ST FLOOR

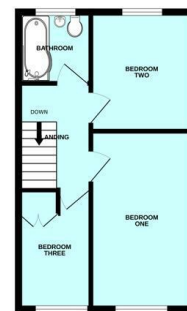

Energy Efficiency Graph

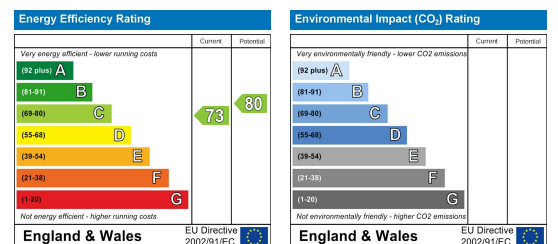

These particulars, whilst believed to be accurate are set out as a general outline only for guidance and do not constitute any part of an offer or contract. Intending purchasers should not rely on them as statements of representation of fact, but must satisfy themselves by inspection or otherwise as to their accuracy. No person in this firm's employment has the authority to make or give any representation or warranty in respect of the property.