

## Lynton Road, SE1

£4,500 Per calendar month

A rare opportunity to rent this four bedroom, three bathroom Victorian terraced house that has recently been completely renovated and re-figured to create a modern home.

Lynton Road is a quiet tree lined road in Bermondsey. Close to the array of bars and independent stores on Bermondsey street, the closest stations are London Bridge and Bermondsey.

### Features

- Four Bedroom House
- Victorian Terrace
- Three Bathrooms
- Private Garden
- Newly Refurbished
- High Quality Finish

# Lynton Road, London, SE1

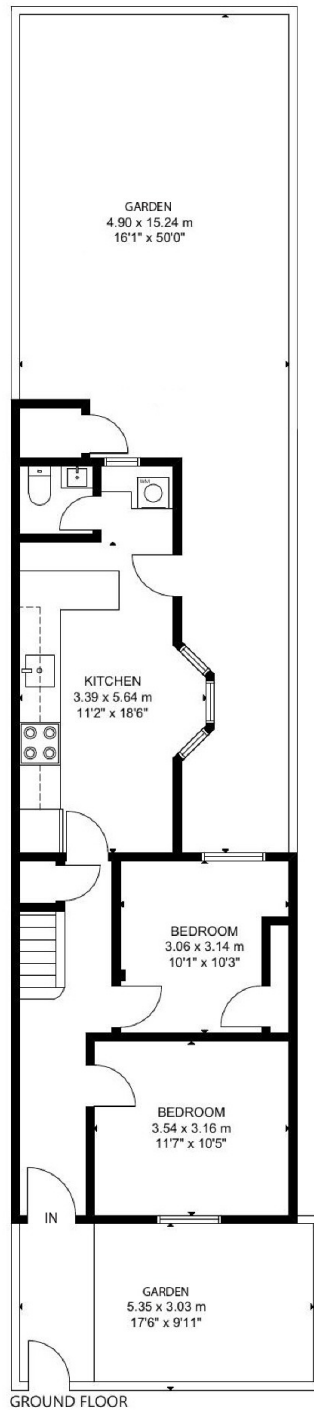

Lynton Road SE1  
Gross Internal Area:  
104 Sq.m - 1115 Sq.ft.

**Dexters**



Prepared for Dexters Estate Agents  
[www.dexters.co.uk/property-lettings](http://www.dexters.co.uk/property-lettings)  
Whilst every attempt has been made to ensure the accuracy of this Lettings floor plan measurements of doors, windows, rooms & Sq footage are approximate. For Identification Purposes only. The actual property will vary. Price on application for a 90 day Licence to use this lettings Plan 020022022. Not to scale.  
Photography, Floorplan, Virtual Tours, Inventory,  
Video & EPC's by [www.steele.london](http://www.steele.london) email:  
[patricia@steele.london](mailto:patricia@steele.london) Tel. 07847219401

**Dexters**

Tower Bridge  
50 Shad Thames  
London  
SE1 2LY  
Lettings  
0207 650 5105

Energy Rating: D. We aim to make our particulars both accurate and reliable. However they are not guaranteed; nor do they form part of an offer or contract. If you require clarification on any points then please contact us, especially if you're traveling some distance to view. Please note that appliances and heating systems have not been tested and therefore no warranties can be given as to their good working order.



[dexters.co.uk](http://dexters.co.uk)