



Chamberlayne Road, NW10

£3,400 Per week

This stunning three double bedroom, two bathroom property with a superbly modern open plan kitchen and living room. The property faces the internal courtyard, giving you a quite living experience with all the amenities at your fingertips.

Close to local shops, bars and restaurants, the nearest stations are Kensal Rise, Queens Park and Kensal Green.

Features

- High Ceilings
- Spacious
- New Build
- Modern
- Allocated parking
- Communal Roof terrace

Chamberlayne Road, London, NW10

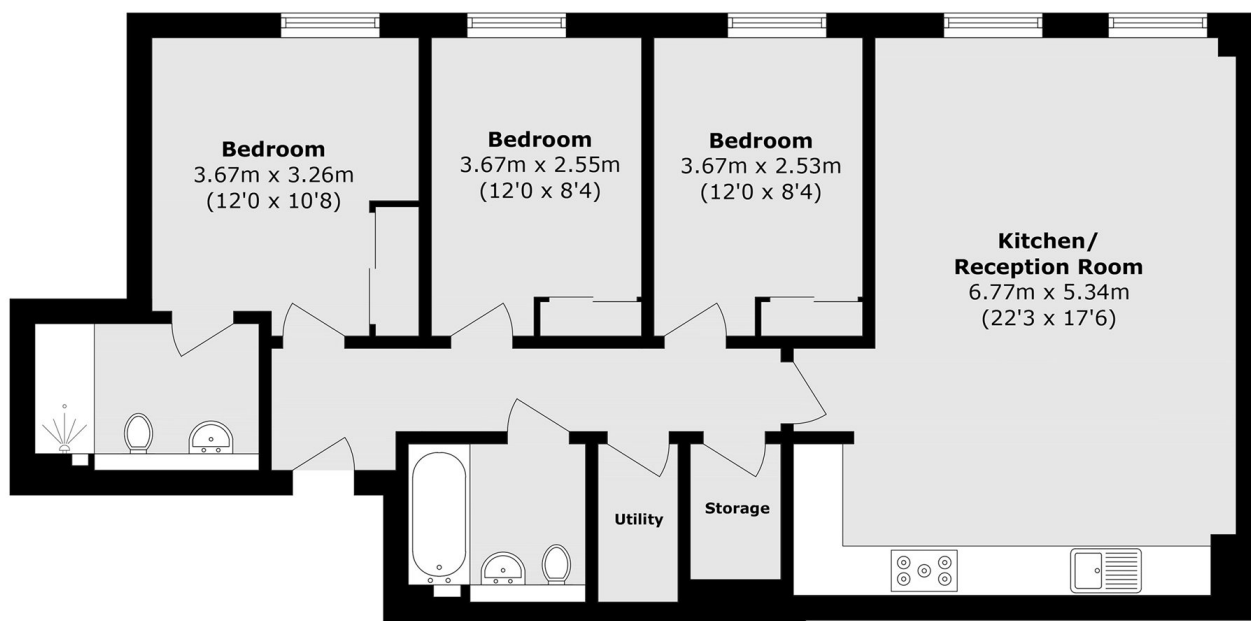

Total area (approx.): 87.1 sq. m (937.5 sq. ft)