

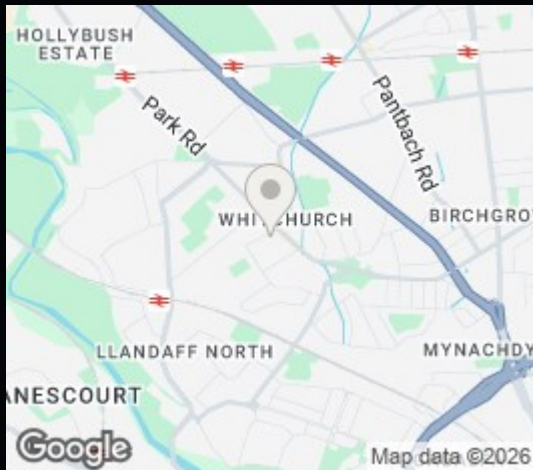

159, College Road,
Llandaff North,
Cardiff,
CF14 2NS

2 Bed Flat - First Floor

£1,100 Per Calendar
Month



With great views across the City of Cardiff, this pleasant and bright two bedroom first floor flat enjoys a central location that is within a gentle walk of Whitchurch Village and Llandaff North. Very well appointed throughout, the property is being offered unfurnished with kitchen appliances and benefits from gas central heating and double glazing. On road parking. Council Tax band B. EPC rating D. Available February 2026 for initial minimum twelve month term.



2



1



1



D

£1,100 Per Calendar Month

CONTACT

EMAIL

lettings@thomashwood.com

TELEPHONE

02920 626252

WEBSITE

| Energy Efficiency Rating | | |
|---|-------------------------|-----------|
| | Current | Potential |
| Very energy efficient - lower running costs | | |
| (92 plus) A | | |
| (81-91) B | | |
| (69-80) C | | |
| (55-68) D | 64 | 72 |
| (39-54) E | | |
| (21-38) F | | |
| (1-20) G | | |
| Not energy efficient - higher running costs | | |
| England & Wales | | |
| | EU Directive 2002/91/EC | |

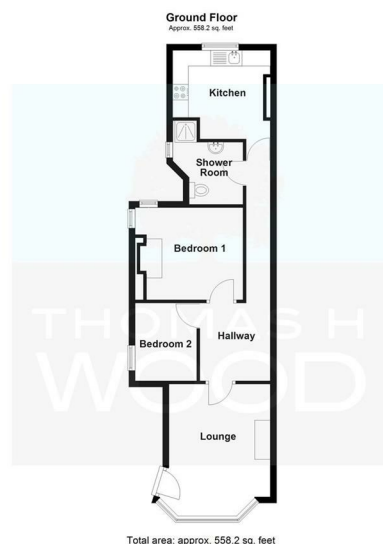

Total area: approx. 558.2 sq. feet