



Stonehaugh | Netherton | NE65 7HD

£350,000

Set within the picturesque village of Netherton, this substantial four-bedroom detached bungalow combines spacious accommodation, extensive gardens, and outstanding access to Northumberland's breathtaking countryside.

RMS | Rook
Matthews
Sayer



DETACHED BUNGALOW

PICTURESQUE VILLAGE LOCATION

GENEROUS CORNER PLOT

BEAUTIFUL GARDENS

SOLAR PANELS

DETACHED DOUBLE GARAGE

NO ONWARD CHAIN

AMPLE OFF-ROAD PARKING

For any more information regarding the property please contact us today

Nestled within the picturesque village of Netherton, this spacious four-bedroom detached bungalow enjoys a wonderful corner plot position with extensive gardens wrapping around the front and side of the property, creating an attractive outdoor setting.

The accommodation offers generous and versatile living space, including a bright and welcoming living room with pleasant views over the front garden. In addition, there is a second reception room, formerly a garage, which provides valuable extra living space and currently accommodates additional kitchen appliances, offering flexibility to suit a variety of needs.

Externally, the property benefits from ample off-road parking for multiple vehicles, together with a detached double garage, making it ideal for families, hobbyists, or those requiring additional storage.

Netherton is a charming and peaceful Northumberland village, located approximately six miles north-west of Rothbury and on the edge of the stunning Northumberland National Park. Surrounded by beautiful countryside, it offers an idyllic retreat for those seeking a quieter pace of life, while providing easy access to an abundance of walking routes, outdoor pursuits, and some of the county's most breathtaking landscapes.

Main hall

UPVC double-glazed entrance door, double door storage cupboard, coving to ceiling, loft access hatch, doors to bedrooms, bathroom, living room, and dining kitchen

Living room 18'4 x 15'8 (5.59m x 4.78m)

Double-glazed sliding patio doors to front garden, radiators, stone fireplace with an electric fire, decorative coving to ceiling

Dining kitchen 9'7 x 22' (2.92m x 6.71m)

Fitted kitchen cabinets incorporating; electric hob, double electric oven, twin bowl sink, space dishwasher, central heating boiler.

Part-tiled walls, pantry, coving to ceiling, radiator, double door storage cupboard, UPVC double-glazed windows, door to rear hall and door to main hall.

Bathroom

Bath, pedestal wash-hand basin, close-coupled W.C., radiator, coving to ceiling, ceiling downlights, fully-tiled walls, UPVC frosted double-glazed window.

T: 01665 510044

Branch alnwick@rmsestateagents.co.uk

RMS | Rook
Matthews
Sayer

Bedroom one (front) 11'2 x 11'8 (3.40m x 3.56m)

UPVC double-glazed window, radiator, coving to ceiling, built-in double door wardrobe.

Bedroom two (rear) 9'8 x 10'2 (2.95m x 3.10m)

UPVC double-glazed window, radiator, coving to ceiling, built-in double wardrobe.

Bedroom three (front) / dining room 11'6 x 11'9 (3.51m x 3.58m)

UPVC double-glazed window, radiator, double door wardrobe, decorative coving

Bedroom four (rear) 7'11 x 9'8 (2.41m x 2.95m)

UPVC double-glazed window, radiator, coving to ceiling

Rear hall

UPVC double-glazed external door and window, radiator, coving to ceiling, storage cupboard, doors to; W.C., converted garage, kitchen

W.C.

Low-level WC, wash-hand basin with tiled splash-back, UPVC double-glazed frosted window

Family room/reception room 9'6 x 19'5 (2.90m x 5.92m)

UPVC double-glazed window, fitted kitchen base units incorporating; single drainer sink, space for washing machine, space for a fridge freezer

Double garage 21 x 19'5 (6.40m x 5.92m)

Electric up & over garage door, light and electric power sockets, workbench, UPVC double-glazed frosted windows, car inspection pit, loft access hatch for storage.

MINING

The North East region is famous for its rich mining heritage and therefore it will be beneficial to conduct a mining search. Confirmation should be sought from a conveyancer as to its effect on the property, if any.

PRIMARY SERVICES SUPPLY

Electricity: Mains & Solar panels

Water: Mains

Sewerage: Mains

Heating: Oil Central Heating

Broadband: None

Mobile Signal Coverage Blackspot: No

Parking: Garage/Driveway

TENURE

Freehold – It is understood that this property is freehold, but should you decide to proceed with the purchase of this property, the Tenure must be verified by your Legal Adviser

COUNCIL TAX BAND: D**EPC RATING: D**

AL009487/DM/HH/23.06.2026/V.2

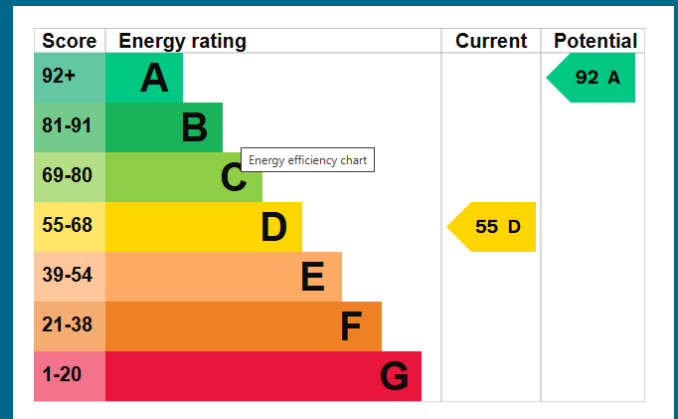



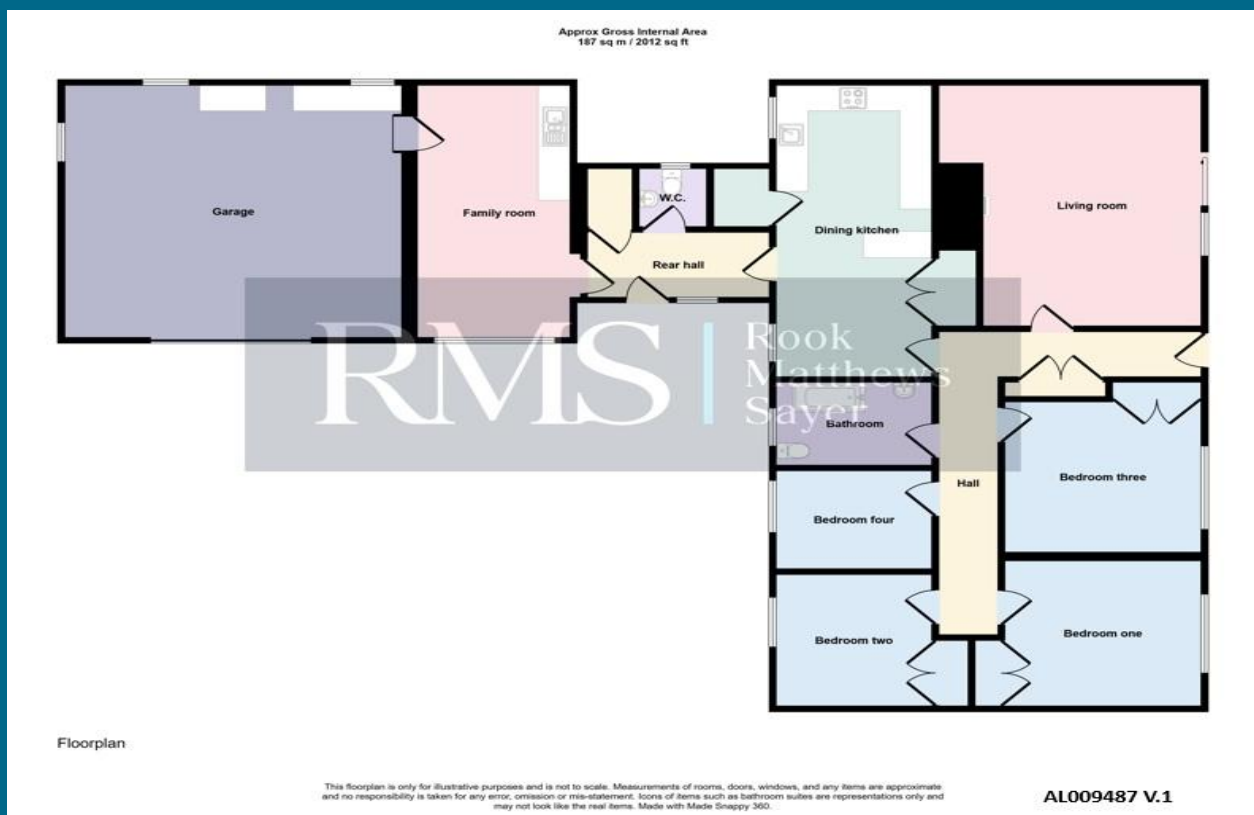

Money Laundering Regulations – intending purchasers will be asked to produce original identification documentation at a later stage and we would ask for your co-operation in order that there will be no delay in agreeing the sale. We will also use some of your personal data to carry out electronic identity verification. This is not a credit check and will not affect your credit score.

Important Note: Rook Matthews Sayer (RMS) for themselves and for the vendors or lessors of this property, whose agents they are, give notice that these particulars are produced in good faith, are set out as a general guide only and do not constitute part or all of an offer or contract. The measurements indicated are supplied for guidance only and as such must be considered incorrect. Potential buyers are advised to recheck the measurements before committing to any expense. RMS has not tested any apparatus, equipment, fixtures, fittings or services and it is the buyer's interests to check the working condition of any appliances. RMS has not sought to verify the legal title of the property and the buyers must obtain verification from their solicitor. No persons in the employment of RMS has any authority to make or give any representation or warranty whatever in relation to this property.



T: 01665 510044

Branch alnwick@rmsestateagents.co.uk

RMS | Rook
Matthews
Sayer