

Head Office:
Dixon Kelley Estate Agents
1 Penn Court
Station Road, West Moors
Dorset. BH22 0JJ

DORSET PARK HOMES

DRAFT

www.dorsetparkhomes.com

Telephone: 01202 877511

34 Gladelands Park, Ringwood Road, Ferndown, Dorset. BH22 9BW



Lissett Park Home with Scope to Improve

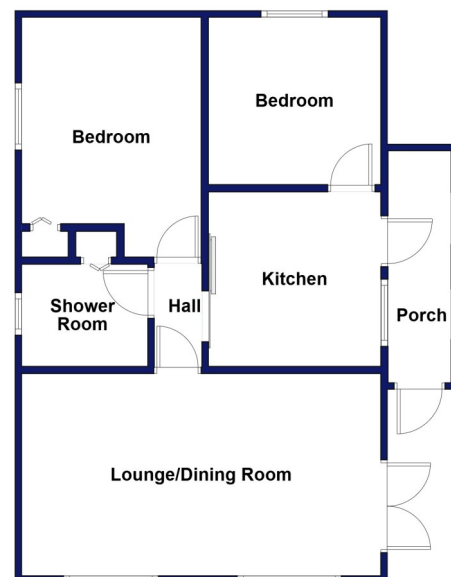

This drawing has been prepared for diagrammatic purpose only. Not to scale

2 Bedroom Park Home approx 30' x 20'

Accommodation & approximate room dimensions:

- Lissett Park Home
- Enclosed Porch
- Lounge/Dining Room: approx 18'8" x 10'9". Feature electric fireplace & doors to garden.
- Kitchen: Range of floor and wall cupboards. Space for fridge/freezer & washing machine. Oil fired central heating boiler.
- Inner Hall
- Bedroom 1: approx 12'9" x 9'2". Built-in wardrobes
- Bedroom 2: approx 9'2" x 9'2". Built-in wardrobe.
- Shower Room: Wet room style shower with thermo-static shower. Wash basin & WC.
- Oil Central Heating (system untested)
- PVCu Double-Glazing
- Garden: Laid to lawn. Metal Shed.
- Parking for 1 car in close by parking zone
- Age Restriction 50+ No Pets Allowed
- Convenient location close to local amenities, major supermarkets & regular bus services.

Close to amenities



Price £59,950

Pitch Fee: approx £tba per month

Subject to Annual Review

Council Tax Band: 'A'

Tenure: 1983 Mobile Homes Act Agreement

VIEWING STRICTLY BY APPOINTMENT WITH THE VENDOR'S AGENT Dorset Park Homes 01202 877511

IMPORTANT NOTE: These particulars are believed to be correct but their accuracy is not guaranteed. They do not form part of any contract. Nothing in these particulars shall be deemed to be a statement that the property is in good structural condition or otherwise, nor that any of the services, appliances, equipment or facilities are in good working order or have been tested. Purchasers should satisfy themselves on such matters prior to purchase Ref.W05191

The recommended specialist in Park Home sales
Proprietor: Simon Dixon

