



Hormead Road

Maida Vale, W9

£4,000 per month
(£923.08 per week)

SHORT LET A charming two bedroom apartment with its own private garden positioned on this quiet residential street in a great location.

CHESTERTONS



Hormead Road

Maida Vale, W9

- SHORT LET
- Maida Vale / Notting Hill
- Two Bedrooms
- Lots of Storage
- Private Patio Overlooking Regent's Canal
- Great Location



SHORT LET

A charming two bedroom apartment with its own private garden positioned on this quiet residential street set within a converted Victorian building.

Finished to a high specification throughout, with abundant natural light and spanning approximately 630 square feet the accommodation comprises a bright reception room, a separate fully fitted kitchen, two bedrooms with abundant storage, family bathroom and a charming patio garden to the rear which overlooks the Regent's Canal.

Minimum Term: 1 months
Deposit Required: 4 weeks (subject to tenancy length)
Local Authority: City Of Westminster
Council Tax Band: D
EPC Rating: D
Furnished

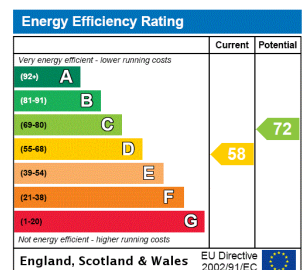

Chestertons Little Venice Lettings

26 Clifton Road
 Maida Vale
 London
 W9 1SX
 littlevenicelettingsusers@chestertons.co.uk
 02072662369
 chestertons.co.uk

Additional tenant charges apply (fees apply to non-AST tenancies only)
 Tenancy Agreement Fee: £300
 References per Tenant/Guarantor: £60
 Inventory check (approx. £100 – £250 inc. VAT)
 chestertons.co.uk/property-to-rent/applicable-fees

Hormead Road,
Maida Vale, W9

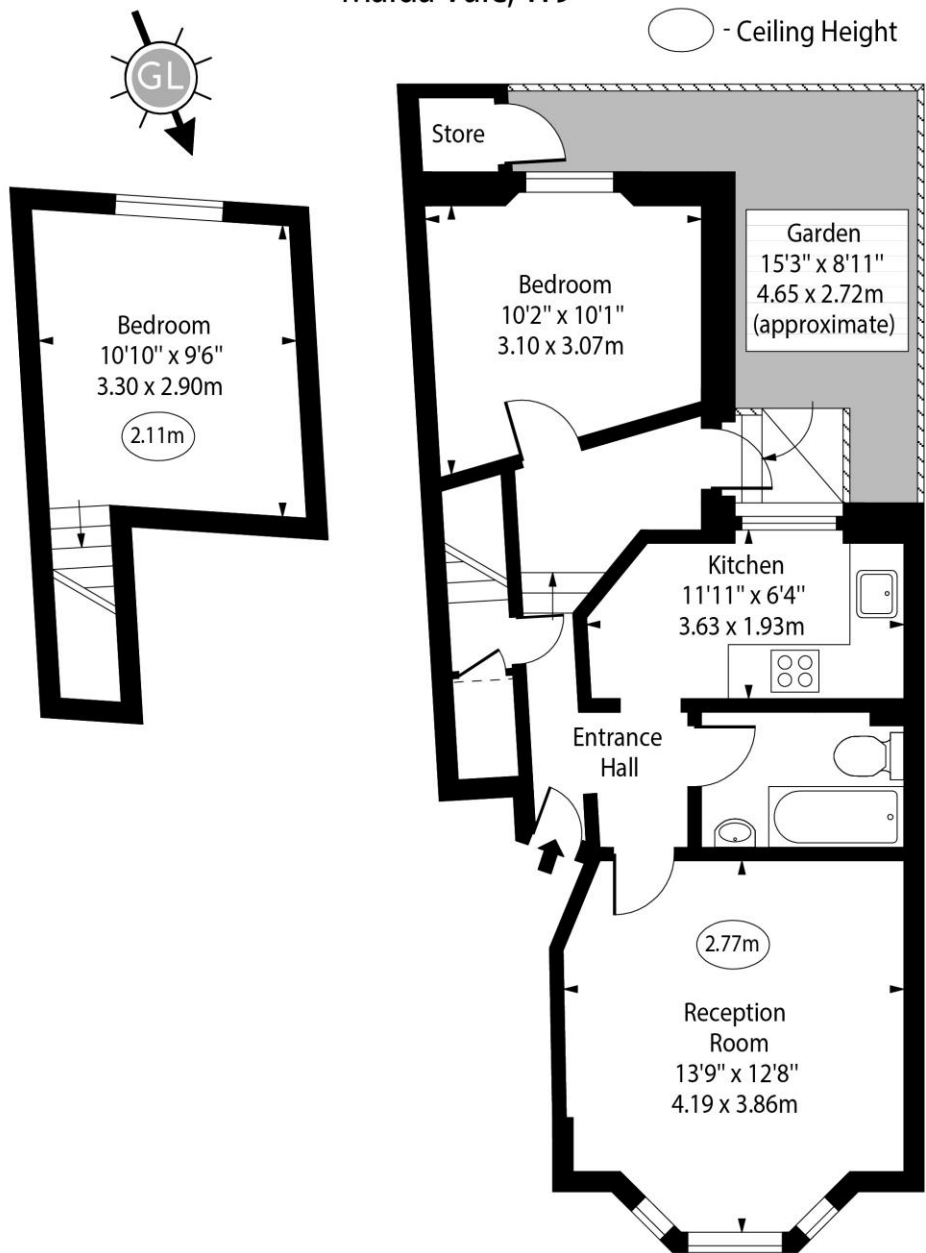

Lower Ground Floor

Ground Floor

Approx Gross Internal Area

622 Sq Ft - 57.78 Sq M

Approx. Floor Area Including Restricted Heights

630 Sq Ft - 58.53 Sq M

For Illustration Purposes Only - Not To Scale

www.goldlens.co.uk

Ref. No. 025530E

Chesterton UK Services Limited trading as Chestertons for themselves and for the vendor of this property whose agents they are, give notice that (i) these particulars do not constitute any part of an offer or contract, (ii) all statements contained within these particulars are made without responsibility on the part of Chestertons or the vendor, (iii) whilst made in good faith, none of the statements contained within these particulars are to be relied upon as a statement or representation of fact, (iv) any intending purchasers must satisfy themselves by inspection or otherwise as to the correctness of each of the statements contained within these particulars, (v) the vendor does not make or give either Chestertons or any person in their employment any authority to make or give representation or warranty whatsoever in relation to this property. Wide angle lenses may be used. ©Copyright Chestertons | Chesterton Global Ltd | Registered Office 5th Floor, The Lantern, 75 Hampstead Road, London, NW1 2PL Registered Company Number 05334580.



This paper is
100% recyclable