

# Lynmouth Drive

Ruislip • Middlesex • HA4 9BZ

Guide Price: £525,000



coopers  
est 1986

# Lynmouth Drive

Ruislip • Middlesex • HA4 9BZ

Coopers are delighted to present this three-bedroom, 'B' Type Manor home in a prime Ruislip Manor location. The ground floor features a 30ft open-plan kitchen/reception/dining room, utility room, and direct garden access with a handy outbuilding. Upstairs offers two well-sized bedrooms, a dressing room, and family bathroom, while the top floor boasts a spacious double bedroom with w.c. Just a short walk to Ruislip Manor station (Metropolitan & Piccadilly lines), local shops, cafés, and excellent schools, this home blends space, potential and convenience.

CHAIN FREE

TERRACED 'B' TYPE MANOR HOME

THREE BEDROOMS

FAMILY BATHROOM

THROUGH LOUNGE

GALLEY KITCHEN

PRIVATE REAR GARDEN

OFF STREET PARKING

QUIET LOCATION

1,292 SQ.FT. TOTAL

These particulars are intended as a guide and must not be relied upon as statements of fact. Your attention is drawn to the Important Notice on the last page.





# Lynmouth Drive, Ruislip, HA4

Approximate Area = 1123 sq ft / 104.3 sq m

Limited Use Area(s) = 80 sq ft / 7.4 sq m

Outbuilding = 89 sq ft / 8.2 sq m

Total = 1292 sq ft / 119.9 sq m

For identification only - Not to scale

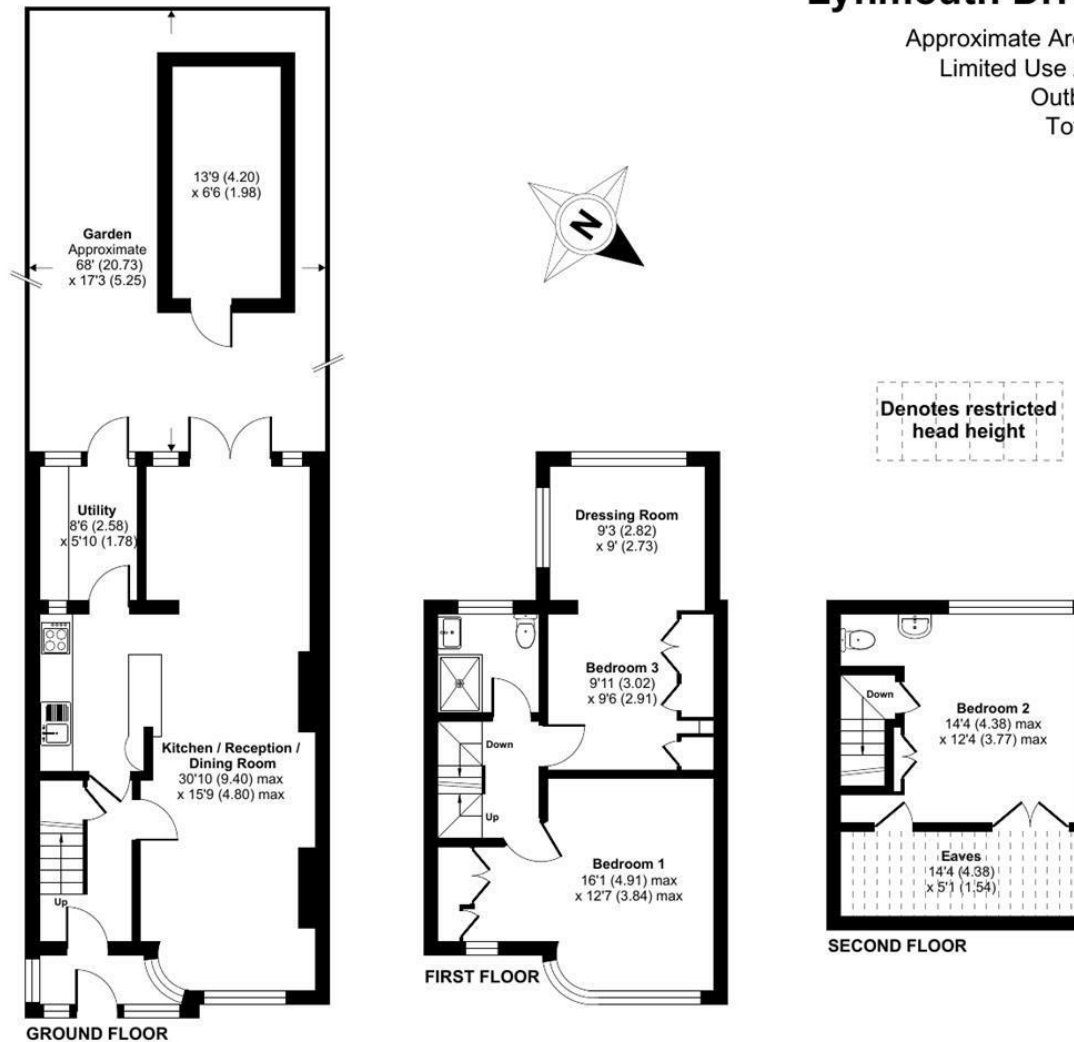

Floor plan produced in accordance with RICS Property Measurement 2nd Edition, Incorporating International Property Measurement Standards (IPMS2 Residential). © n/checom 2025. Produced for Coopers. REF: 1353903

**coopers**  
est 1986

**coopers**  
est 1986

71 Victoria Road, Ruislip Manor,  
Middlesex, HA4 9BH  
ruislipmanor@coopersresidential.co.uk

CoopersResidential.co.uk

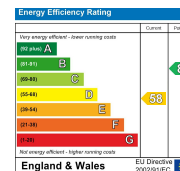

Important Notice: These particulars, whilst believed to be accurate are set out as a general outline only for guidance and do not constitute any part of an offer or contract. Intending purchasers should not rely on them as statements or representation of fact, but must satisfy themselves by inspection or otherwise has the authority to make or give any representation or warranty in respect of the property.