



## Beverley Court, Shipton Road, York £1,100 Per Month

Stephensons are pleased to offer for rent this stunning one bedroom first floor apartment. Situated in an exclusive new development on the outskirts of York City Centre, and offered for rent unfurnished, an early viewing is strongly advised.



The building is accessed via a secure key coded front door which leads to a staircase or lift providing access to the first floor. On entering the apartment itself you are greeted by a spacious open plan kitchen living area, boasting high end fixtures and fittings, integrated fridge freezer, dishwasher, oven, microwave, and hob as well as stylish parquet flooring with south facing sash windows allowing in an abundance of natural light.

The well proportioned double bedroom is accessed via the inner hall with another south facing sash window.



The stunning house shower room benefits from a large walk-in waterfall shower, wash basin with vanity unit under, low flush wc and heated towel rail.

Completing the internal accommodation is a large airing cupboard housing the gas central heating boiler, with ample space and plumbing for a washing machine and tumble dryer.



Beverley House, Beverley Court, Shipton Road, York, YO30 5FZ

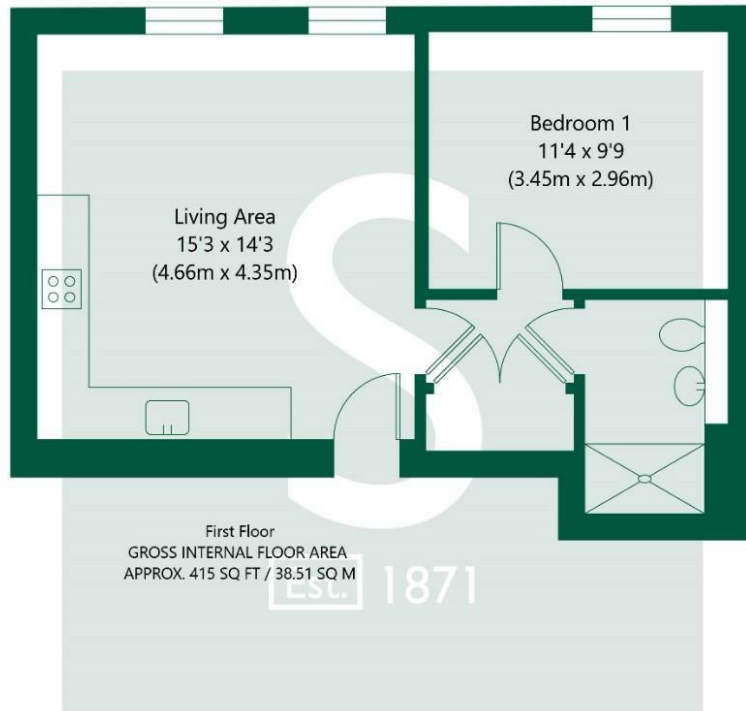

NOT TO SCALE - FOR ILLUSTRATIVE PURPOSES ONLY  
 APPROXIMATE GROSS INTERNAL FLOOR AREA 415 SQ FT / 38.51 SQ M  
 All Measurements and fixtures including doors and windows are approximate and should be independently verified.  
 www.exposurepropertymarketing.com © 2026

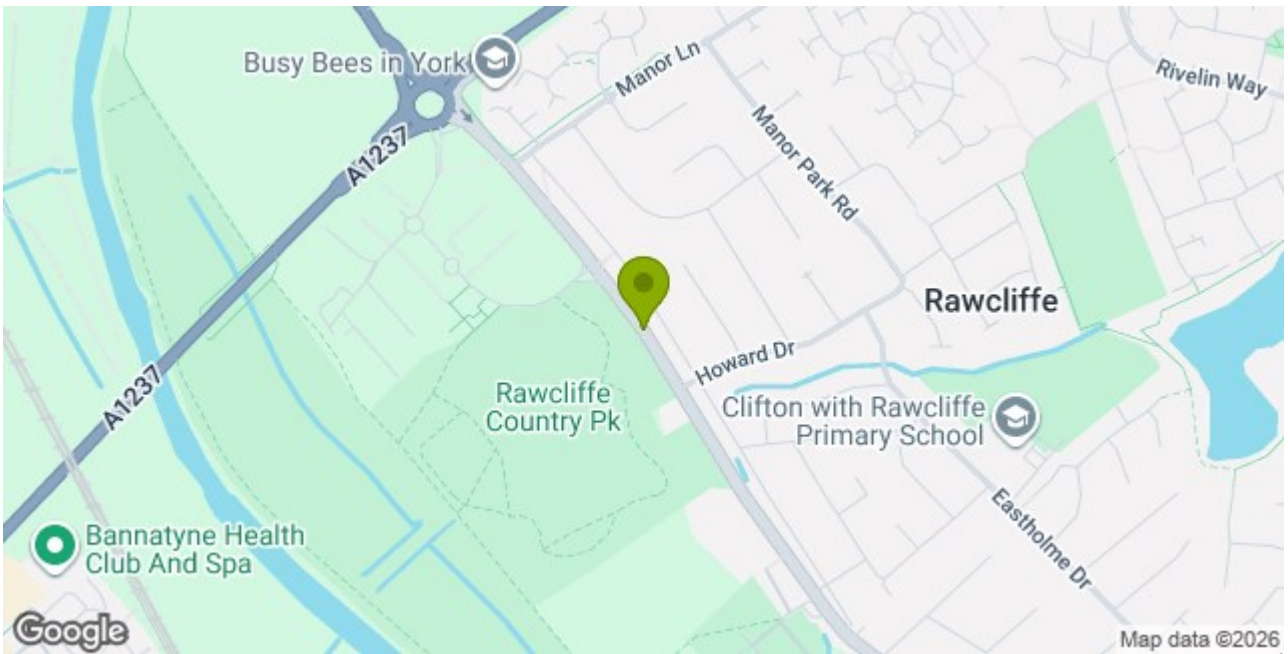

**Stephensons**

York	01904 625533
Knarborough	01423 867700
Selby	01757 706707
Boroughbridge	01423 324324
Easingwold	01347 821145
York Auction Centre	01904 489731
Haxby	01904 809900

**Partners**

- J F Stephenson MA (cantab) FRICS FAAV
- I E Reynolds BSc (Est Man) FRICS
- R E F Stephenson BSc (Est Man) MRICS FAAV
- N J C Kay BA (Hons) pg dip MRICS
- O J Newby MNAEA
- J E Reynolds BA (Hons) MRICS
- R L Cordingley BSc FRICS FAAV
- J C Drewniak BA (Hons)

**Associates**

N Lawrence

