

Mortlake High Street, SW14

£425,000

At approximately 614 sq ft, this bright and spacious two-bedroom apartment presents an excellent opportunity for first-time buyers, as a pied-à-terre, or as a rental investment. The property is accessed via a well-maintained communal entrance hall with entry phone system, with stairs leading to the second-floor landing. The accommodation comprises a welcoming entrance hall, a generous reception room with direct access to a covered balcony, a well-proportioned kitchen, a principal double bedroom, a second double bedroom, and a family bathroom.

Located for the extensive shopping and leisure amenities of East Sheen including Waitrose and a number of restaurants and cafes, together with bus routes giving access to Richmond, Putney and Barnes. Mortlake mainline station which provides regular services to London Waterloo is approximately 0.4 miles away.

Features

- Two Double Bedrooms
- Private Balcony
- No Onward Chain
- Close to Rail Links
- Quiet Location
- Large Kitchen

Mortlake High Street, London, SW14

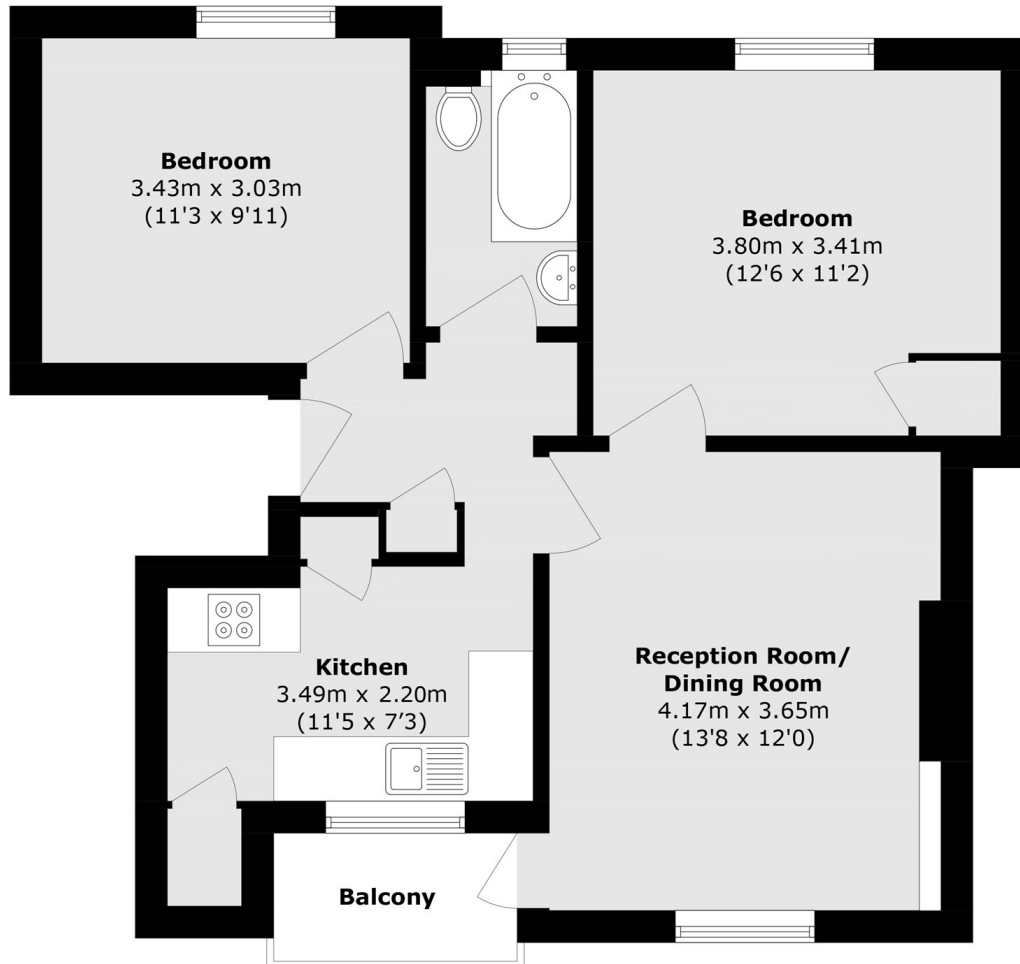

Total area (approx.): 57.1 sq. m (614.6 sq. ft)

Balcony area (approx.): 3.0 sq. m (32.3 sq. ft)