



Connells

Turnstone Gardens
Southampton



Property Description

Connells are proud to present this well-maintained two-bedroom home in the popular area of Lordswood with NO CHAIN, offering a generous living space throughout, making it a fantastic choice for first time buyers.

Upon entering, you'll find the bright and airy living room, making it a great space for both relaxing and entertaining, with large windows allowing in plenty of natural light. From here, you have direct access to the spacious, fitted kitchen with ample dining space, neutral cabinetry, both freestanding and integrated appliances and rear garden access. The large rear garden is low-maintenance with a handy garage accessed from the rear as well as gated rear access into garden.

Upstairs, the property benefits from a storage cupboard on the landing and two well-proportioned bedrooms with built-in allowing you to maintain a clutter-free home. The family bathroom is fitted with a three-piece suite, including a bath with an attached shower for added convenience. Further benefits to this property include gas central heating, a garage, driveway parking and is being offered with no chain.

This property is within close proximity to Ofsted-rated schools, Southampton General Hospital, and has easy access to the M27/M3 motorways and frequent bus services to the city. Lordswood also offers local parks and green spaces, a quiet residential area, and excellent shopping options nearby, including West Quay. The New Forest is a short drive

away, providing a great escape.

Hallway

Lounge

13' 5" x 12' 10" (4.09m x 3.91m)

Kitchen/Diner

12' 10" x 10' 10" (3.91m x 3.30m)

Spacious with Neutral Cabinetry, Integrated & Freestanding Appliances and Rear Garden Access

Stairs Leading To First Floor

Landing

Has Built-In Storage

Bedroom 1

12' 10" x 9' 6" (3.91m x 2.90m)

Has Built-In Storage

Bedroom 2

9' 6" x 6' 11" (2.90m x 2.11m)

Has Built-In Storage

Bathroom

Three-Piece with Toilet, Hand-Wash Basin & Bath with Attached Shower







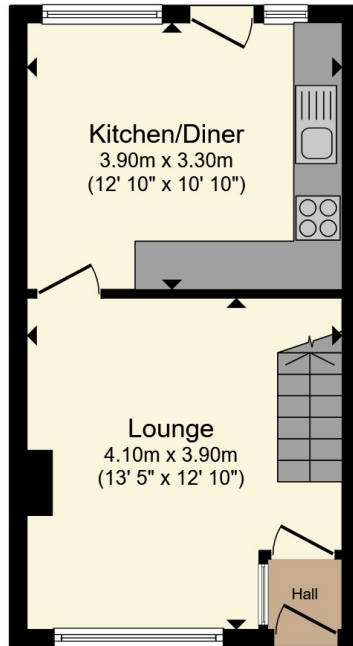

Ground Floor

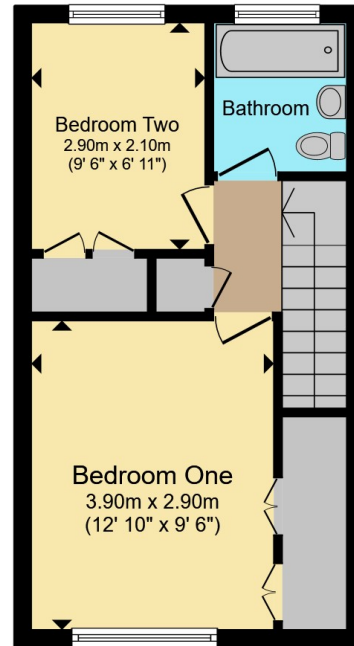

First Floor

Total floor area 58.5 m² (630 sq.ft.) approx

This floor plan is for illustrative purposes only. It is not drawn to scale. Any measurements, floor areas (including any total floor area), openings and orientation are approximate. No details are guaranteed, they cannot be relied upon for any purpose and they do not form part of any agreement. No liability is taken for any error, omission or misstatement. A party must rely upon its own inspection(s). Powered by www.propertybox.io



To view this property please contact Connells on

T 02380 789 351
E shirley@connells.co.uk

409 Shirley Road Shirley
 SOUTHAMPTON SO15 3JD

EPC Rating: C Council Tax
 Band: B

Tenure: Freehold

view this property online connells.co.uk/Property/SSR312746



1. MONEY LAUNDERING REGULATIONS Intending purchasers will be asked to produce identification documentation at a later stage and we would ask for your co-operation in order that there will be no delay in agreeing the sale. 2. These particulars do not constitute part or all of an offer or contract. 3. The measurements indicated are supplied for guidance only and as such must be considered incorrect. Potential buyers are advised to recheck measurements before committing to any expense. 4. We have not tested any apparatus, equipment, fixtures, fittings or services and it is in the buyers interest to check the working condition of any appliances.

Connells Residential is registered in England and Wales under company number 1489613, Registered Office is Cumbria House, 16-20 Hockliffe Street, Leighton Buzzard, Bedfordshire, LU7 1GN. VAT Registration Number is 500 2481 05.

See all our properties at www.connells.co.uk | www.rightmove.co.uk | www.zoopla.co.uk

Property Ref: SSR312746 - 0005