

KEYSTONE



Burlington Road, Ipswich, IP1 2EU

£795 Per Month

- Part Furnished One Bedroom Flat - Ground Floor
- Kitchen With Integrated Appliances
- Permit Parking Available
- NEW KITCHEN, BATHROOM, CARPETS & DECORATION THROUGHOUT
- Shower Room
- AVAILABLE 28/08/26
- ENCLOSED COURTYARD GARDEN
- Open Plan Living/Kitchen
- EPC RATING D

GROUND FLOOR

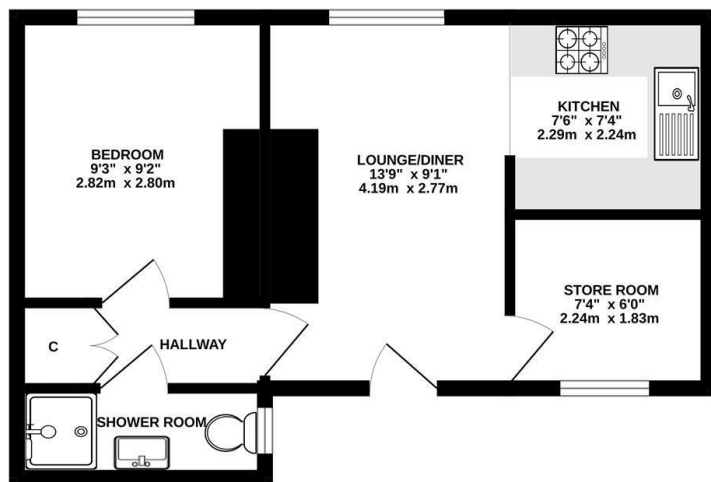

Whilst every attempt has been made to ensure the accuracy of the floorplan contained here, measurements of doors, windows, rooms and any other items are approximate and no responsibility is taken for any error, omission or mis-statement. This plan is for illustration purposes only and should be used as such by any prospective purchaser. The services, systems and appliances shown have not been tested and no guarantee as to their operability or efficiency can be given.
Made with Metropix ©2025



Directions

Viewings

Viewings by arrangement only. Call 01473 221 399 to make an appointment.

EPC Rating:

D

Energy Efficiency Rating		Current	Potential
<i>Very energy efficient - lower running costs</i>			
(92 plus)	A		
(81-91)	B		
(69-80)	C		77
(55-68)	D	60	
(39-54)	E		
(21-38)	F		
(1-20)	G		
<i>Not energy efficient - higher running costs</i>			
England & Wales		EU Directive 2002/91/EC	