



Court Mews, SE13

£550,000

This two-bedroom home is part of a contemporary gated development just a short walk from Hither Green Station. The open-plan ground floor features a kitchen with integrated appliances, a spacious living area, and access to a private courtyard garden. Upstairs, you'll find two double bedrooms and a stylish, fully tiled bathroom. Additional storage and a downstairs WC complete the home.

This area has blossomed in recent years, with a range of popular gastro pubs and restaurants opening up. It's also a hit with families, thanks to several local schools. Mountsfield Park, just a short walk away, offers a fantastic playground and various sports facilities. For

Features

Beautiful Contemporary Home
Two Double Bedrooms
Well Presented Throughout
Gated Development
Private Courtyard Garden
Close To Hither Green Station



Court Mews, SE13



Court Mews, London, SE13

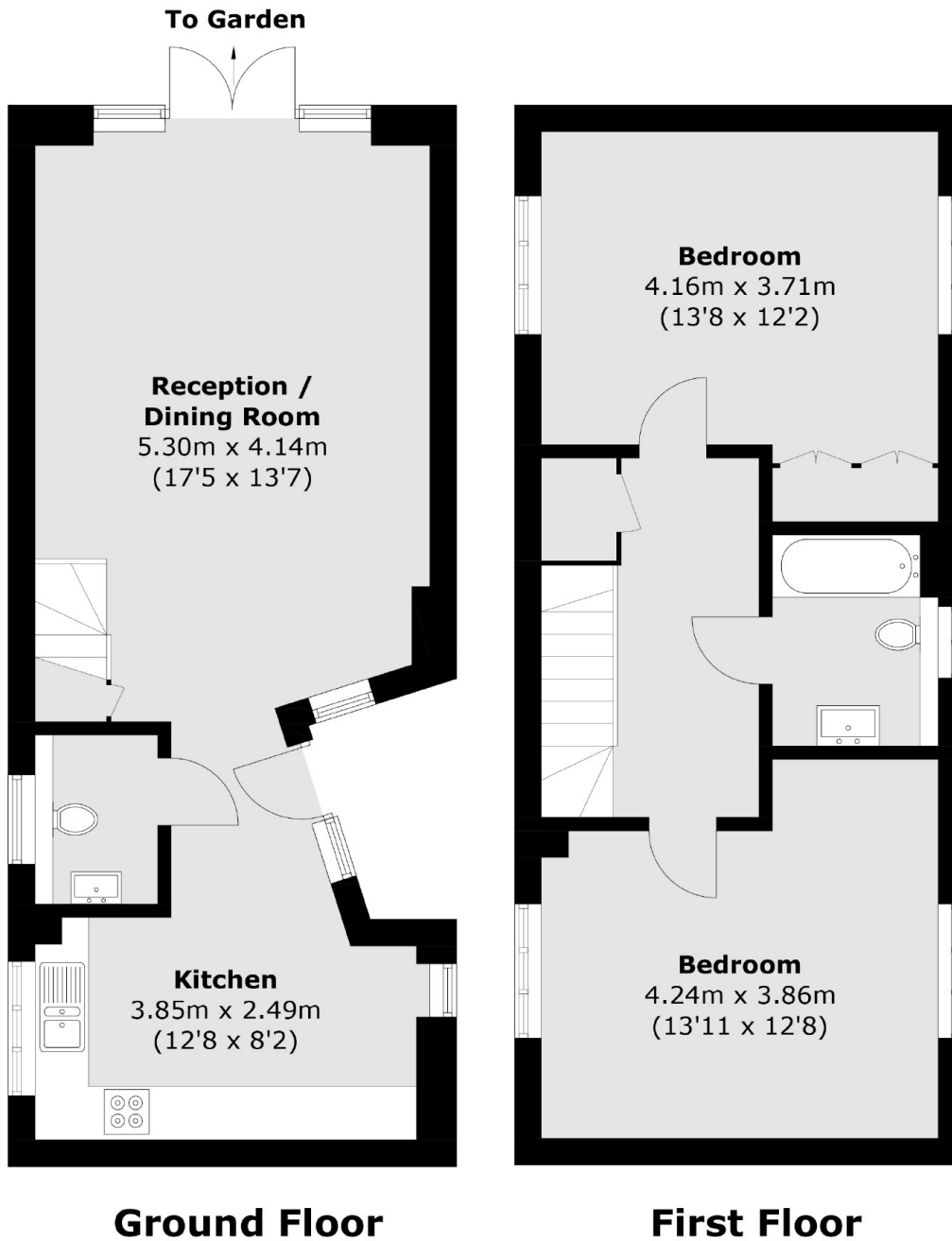

Total area (approx.): 96.1 sq. m (1,034.4 sq. ft)