



GIBBINS RICHARDS 
Making home moves happen

14 Saxon Close, Oake, Taunton TA4 1JA
Offers in Excess of £290,000

GIBBINS RICHARDS 
Making home moves happen

Extended family home* Open plan living area*Village location

This well presented three bedroom semi-detached home is situated in the desirable village of Oake, offering a peaceful setting while remaining conveniently located for nearby amenities and transport links.

Tenure: Freehold / Energy Rating: B / Council Tax Band: D

Saxon Close is located in the popular village of Oake, a friendly and welcoming community on the outskirts of Taunton. The village is particularly well-suited to families, benefiting from a well-regarded local primary school and an active village hall that regularly hosts events, clubs, and activities for all ages. Surrounded by attractive countryside, Oake offers a peaceful rural lifestyle with plenty of opportunities for outdoor walks and recreation. Despite its tranquil setting, the village is conveniently positioned for access to Taunton town centre, the M5 motorway, and mainline rail links, making it an excellent choice for commuters and families alike.

Approx 940 sq.ft/ 87.3 sq.m

Open plan living

Conservatory

Garage and parking

Cul-de-sac position

Village location





GIBBINS RICHARDS
Making home moves happen

Accommodation	
Entrance Hall	
Cloakroom	
Living Room	
Kitchen	15' 8" x 9' 7" (4.77m x 2.92m)
Conservatory	11' 9" x 9' 7" (3.58m x 2.92m)
First Floor Landing	
Bedroom	11' 9" x 8' 11" (3.58m x 2.72m)
Ensuite	
Bedroom	9' 7" x 8' 1" (2.92m x 2.46m)
Bedroom	8' 4" x 7' 2" (2.54m x 2.18m)
Bathroom	6' 9" x 6' 8" (2.06m x 2.03m)
Outside	Rear garden, single garage and off road parking



GIBBINS RICHARDS
Making home moves happen



GIBBINS RICHARDS
Making home moves happen



GIBBINS RICHARDS
Making home moves happen

GROUND FLOOR

1ST FLOOR

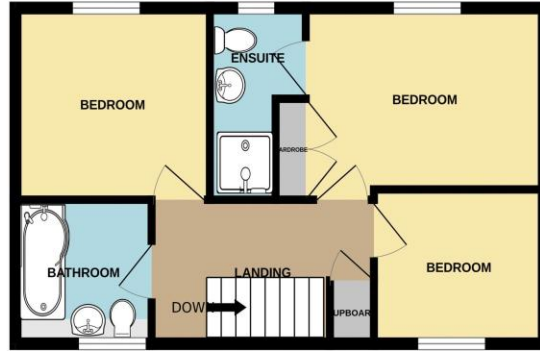

Whilst every attempt has been made to ensure the accuracy of the floorplan contained here, measurements of doors, windows, rooms and any other items are approximate and no responsibility is taken for any error, omission or mis-statement. This plan is for illustrative purposes only and should be used as such by any prospective purchaser. The services, systems and appliances shown have not been tested and no guarantee as to their operability or efficiency can be given.
Made with Metropix ©2025



The Agent has not tested any apparatus, equipment, fixtures and fittings or services and so cannot verify that they are in working order or fit for the purpose. A Buyer is advised to obtain verification from their Solicitor or Surveyor. References to the Tenure of a Property are based on information supplied by the Seller. The Agent has not had sight of the title documents. A Buyer is advised to obtain verification from their Solicitor.

Items shown in photographs are NOT included unless specifically mentioned within the sales particulars. They may however be available by separate negotiation. Buyers must check the availability of any property and make an appointment to view before embarking on any journey to see a property.



We routinely refer potential sellers and purchasers to a selection of recommended conveyancing firms – both local and national. It is their decision whether to use those services. In making that decision, it should be known that we receive a payment benefit of not more than £200 per transaction. We routinely refer potential sellers and purchasers to Mortgage Advice Bureau (MAB) for mortgage and protection advice. It's their decision whether to use those services. In making that decision, it should be known that we receive a payment benefit of not more than £250 per case. Once an offer is accepted by our client, an Administration Fee of £40 + VAT (£48) per buyer will be required in order for us to process the necessary checks relating to our compliance and Anti-Money Laundering obligations. This is a non-refundable payment and cannot be returned should a purchase cease to continue. It can be paid via a card machine, or via BACS transfer.