



94 Fairways Avenue, Harrogate

£279,950



**YOUR AWARD
WINNING AGENT**

#DARINGTOBEDIFFERENT



A well-presented two-bedroom semi-detached bungalow with garage and attractive gardens, enjoying open views over the adjoining countryside. This appealing bungalow offers well-proportioned and flexible accommodation, ideal for a range of buyers seeking comfortable single-level living in a highly regarded location. CHAIN FREE.

Fairways Avenue is a highly desirable location, positioned between Harrogate and Knaresborough, and conveniently placed for a wide range of local amenities, transport links and services.

OUTSIDE Externally, the property enjoys an enclosed and low-maintenance rear garden, laid mainly to paved seating areas with gravel borders, ideal for outdoor dining and entertaining. A particular highlight is the open aspect beyond the garden, with views over adjoining fields / paddock, offering a pleasant semi-rural outlook and a sense of space rarely found in such a convenient location.

To the side, there is a driveway providing off-street parking and access to the detached garage. The front of the property features a neat front garden, completing the attractive exterior.

Council Tax band: C

Tenure: Freehold

EPC Energy Efficiency Rating: D



ACCOMMODATION The accommodation comprises; entrance hall leading to a spacious sitting room providing ample space for both living and dining furniture. The room features a large window allowing plenty of natural light and a focal fireplace with inset gas fire.

The modern fitted kitchen is well appointed with a range of wall and base units, contrasting work surfaces, integrated oven with stainless steel extractor hood, and space for free-standing appliances. Recessed ceiling spotlights and a window provide good lighting and a pleasant outlook.

There are two double bedrooms. The principal bedroom benefits from a range of built-in wardrobes offering excellent storage. The second bedroom is a versatile space, suitable for use as a guest bedroom, dining room or home office, and enjoys French doors opening directly onto the rear garden.

The accommodation is completed by a contemporary shower room fitted with a walk-in shower enclosure, washbasin and low-flush WC, complemented by full tiling, a heated chrome towel radiator, and an opaque window providing natural light and ventilation.



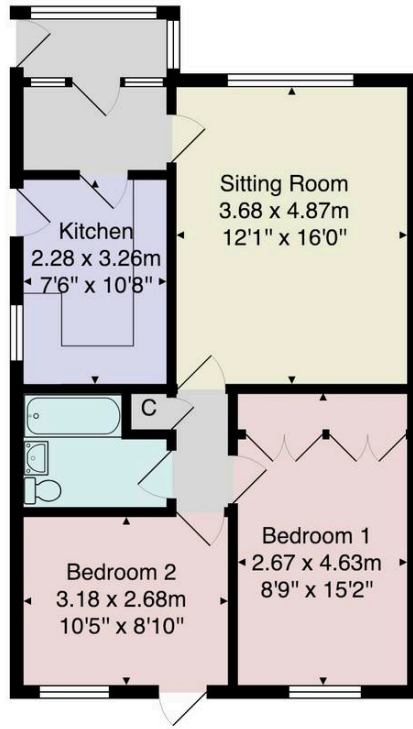

Total Area: 60.8 m² ... 655 ft²

All measurements are approximate and for display purposes only.

No liability is accepted by either the agency or Box Property Solutions Ltd as to the exact measurements of the rooms.

Box Property Solutions Ltd retains the copyright on this plan and allows agents to use it with agreed permission. Copyright 2017 Ac2

