



STEPHENSON BROWNE

**Rufford Close, Wistaston,  
Crewe**

CW2 6XP



**Offers Over £380,000**

## Description

Situated within a peaceful cul de sac in one of Crewe's most sought after residential areas, this impressive four bedroom detached family home offers spacious and versatile accommodation throughout, making it ideal for growing families and those seeking a well connected yet private setting.

Upon entering the property, you are welcomed by a bright and inviting entrance hallway leading to a generous lounge, perfect for relaxing and entertaining. A separate dining room provides an excellent additional reception space for formal dining, family gatherings, or flexible everyday use. To the rear of the property, the conservatory enjoys pleasant views over the private enclosed garden and creates a wonderful additional living area filled with natural light.

The fitted kitchen offers ample worktop and storage space and a useful downstairs WC completes the ground floor accommodation.

To the first floor, the spacious principal bedroom benefits from its own en suite shower room, while three further well proportioned bedrooms provide comfortable accommodation for family members, guests, or home office space. A family bathroom serves the remaining bedrooms.

Externally, the property enjoys driveway parking and a private rear garden, ideal for outdoor entertaining, children's play areas, or simply enjoying the peaceful surroundings. The cul de sac setting adds to the appeal, offering a quieter residential environment with minimal passing traffic.



Conveniently positioned close to a range of local amenities, highly regarded schools, and excellent transport links, this superb detached home combines space, comfort, and location, making it an excellent opportunity for prospective buyers. Early viewing is highly recommended to fully appreciate all that this property has to offer.



### Viewing

Please contact our office using the details provided on the final page if you are interested in booking a viewing or require further information.



STEPHENSON BROWNE



# Floorplans

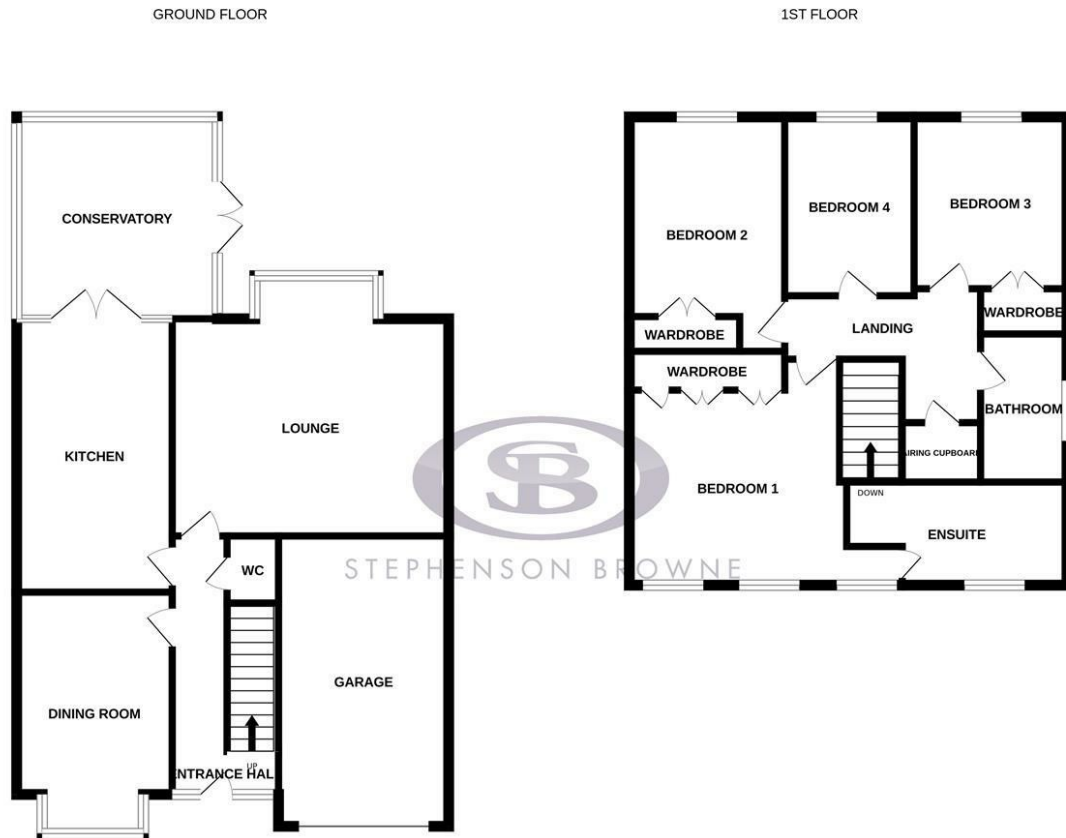

Whilst every attempt has been made to ensure the accuracy of the floorplan contained here, measurements of doors, windows, rooms and any other items are approximate and no responsibility is taken for any error, omission or mis-statement. This plan is for illustrative purposes only and should be used as such by any prospective purchaser. The services, systems and appliances shown have not been tested and no guarantee as to their operability or efficiency can be given. Made with Metropix ©2025

# Area Map



# EPC Rating

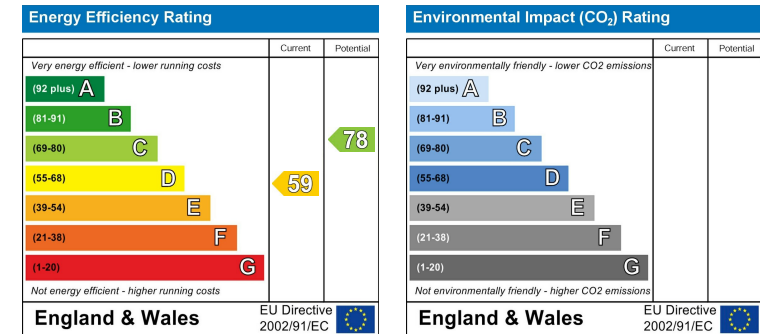

NOTICE: Stephenson Browne for themselves and for the vendors or lessors of this property whose agents they are give notice that: (1) the particulars are set out as a general guideline only for the guidance of intending purchasers or lessees, and do not constitute, nor constitute part of, an offer or contract; (2) all descriptions, dimensions, references to condition and necessary permissions for use and occupation, and other details are given in good faith and are believed to be correct but any intending purchasers or tenants should not rely on them as statements or representations of fact but must satisfy themselves by inspection or otherwise as to the correctness of each theme; (3) no person in the employment of Stephenson Browne has any authority to make representation or warranty whatever in relation to this property. (4) fixtures & fittings are subject to a formal list supplied by the vendors solicitors. **Referring to: Move with Us Ltd Average Fee: £123.64**

**T: 01270 252545 E: [crewe@stephensonbrowne.co.uk](mailto:crewe@stephensonbrowne.co.uk)**

[www.stephensonbrowne.co.uk](http://www.stephensonbrowne.co.uk)