



For Sale

20 The Gardens, Leamington Spa

Offers Over £365,000

3

1

3

3584 sq ft

979 sq ft

Nathaniel Cleaver

07793 363210

nathaniel@thepropertyexperts.co.uk

***** TRADITIONAL SEMI DETACHED PROPERTY SET IN THE HEART OF THIS EVER POPULAR VILLAGE LOCATION *****

This three bedroom family home is set right in the heart of the Village. Radford Semele is a very popular location and close to all local amenities / shops, Primary School, recreation ground, all major road networks, White Lion pub and Church.

In brief on the ground floor the property comprises; large and welcoming entrance hall, downstairs WC, lounge, separate dining room, study or playroom and kitchen.

Upstairs there are three bedrooms (two doubles with built in storage and a good sized single) and a family shower room, there is also access to the loft with pull down loft ladder.

Further benefits include a front lawn area and a large rear family garden with large shed with power and a further smaller shed. There is driveway parking for two cars to the side and a detached single garage, again with power, there is also gas central heating with combination boiler that was re fitted five years ago, along with new radiators to the ground floor.

CALL NOW TO BOOK YOUR VIEWING!



The Property Experts UK

01926436105



Floor area 60.1 sq.m. (647 sq.ft.) approx

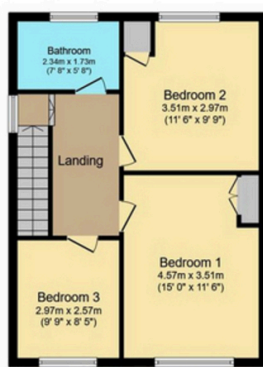

Floor area 51.4 sq.m. (554 sq.ft.) approx

Total floor area 111.6 sq.m. (1,201 sq.ft.) approx

This Floor Plan is for illustration purposes only and may not be representative of the property. The position and size of doors, windows and other features are approximate. Unauthorized reproduction prohibited. © PropertyBOX

- Traditional Semi Detached Property
- Three Bedrooms
- Separate Lounge & Dining Room
- Enclosed Large Rear Garden
- Front Garden, Driveway Parking & Single Detached Garage
- Downstairs WC
- Close To All Local Amenities
- Gas Central Heating & Double Glazed
- EPC Rating - D

