



## SOUTHERNGATE WAY, SE14

£350,000

Ground floor apartment  
Two bedrooms  
Chain free  
Communal garden  
Allocated parking space  
Energy rating: d

@marshandparsons  
marshandparsons.co.uk

MARSH &  
PARSONS



# ABOUT THE PROPERTY

A recently upgraded ground floor apartment that is offered chain free and benefits French doors from the lounge onto a small communal garden area.

To the rear of the development is a larger communal garden, and there is the further bonus of an allocated parking space. The lease is a fabulous 952 years and ground rent is peppercorn. For the busy commuter New Cross Overground is found a stroll away with a host of amenities in the bustling High Street.



# STEP INSIDE SOUTHERNGATE WAY

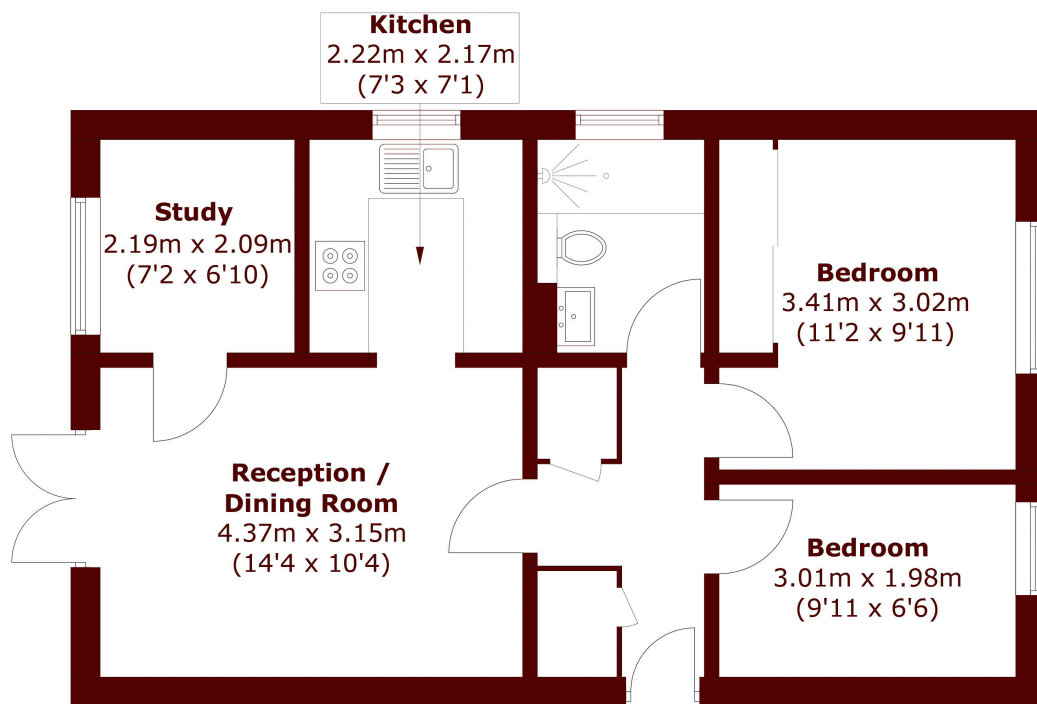

## Ground Floor

Total area (approx.): 51.3 sq. m (552.1 sq. ft)

**Brockley**  
020 8629 8164

Energy Rating: D We aim to make our particulars both accurate and reliable. However, they are not guaranteed; nor do they form part of an offer or contract. If you require clarification on any points then please contact us, especially if you're traveling some distance to view. Please note that appliances and heating systems have not been tested and therefore no warranties can be given as to their good working order

**MARSH &  
PARSONS**