



## Price

£1,750 PCM

Fees Apply



Available 28/03/26

Abbots Rise Redhill  
RH1

**cubitt&west**  
Helping you move forwards



## Main Features

2 Allocated Parking Spaces

Private Rear Garden

Two Bedroom House

Close to Station & Shops

Unfurnished House

NO PETS



**Deposit required is £2,019.23**

**Reigate and Banstead District - Council Tax Band Tax Band D**

Renting a property is a big commitment and we recommend that you visit the local authority website and these websites which offer helpful information and advice about letting

[www.gov.uk/government/publications/how-to-rent](http://www.gov.uk/government/publications/how-to-rent)

[www.gov.uk/private-renting](http://www.gov.uk/private-renting)

[www.cubittandwest.co.uk/renting/tenancy-fees-individuals/](http://www.cubittandwest.co.uk/renting/tenancy-fees-individuals/)

[www.gov.uk/green-deal-energy-saving-measures](http://www.gov.uk/green-deal-energy-saving-measures)

**Call Sutton 020 86426266 ■ [cubittandwest.co.uk](http://cubittandwest.co.uk)**

IMPORTANT INFORMATION: Please contact our Lettings Team who will confirm the total costs involved in renting this property. For clarification, we wish to inform the prospective tenant that we have prepared these details as a general guide. The agent has not carried out a detailed survey nor tested the services, appliances, or specific fittings (unless otherwise stated), and no warranty can be given as to their condition. All room measurements are taken at floor level. We strongly recommend that all the information which we provide about the property is verified by yourself and your advisers. The contents of this publication are © Cubitt & West, 2015. Cubitt & West is a trading name of Arun Estates Limited Registered in England No. 2597969

## Accommodation

**Lounge** 13x11'10

**Kitchen** 11'7x5'10

**Master bedroom** 11'9x9'1

**Second bedroom** 9'1x11'9

**Family bathroom**





GROUND FLOOR  
291 sq.ft. (27.0 sq.m.) approx.

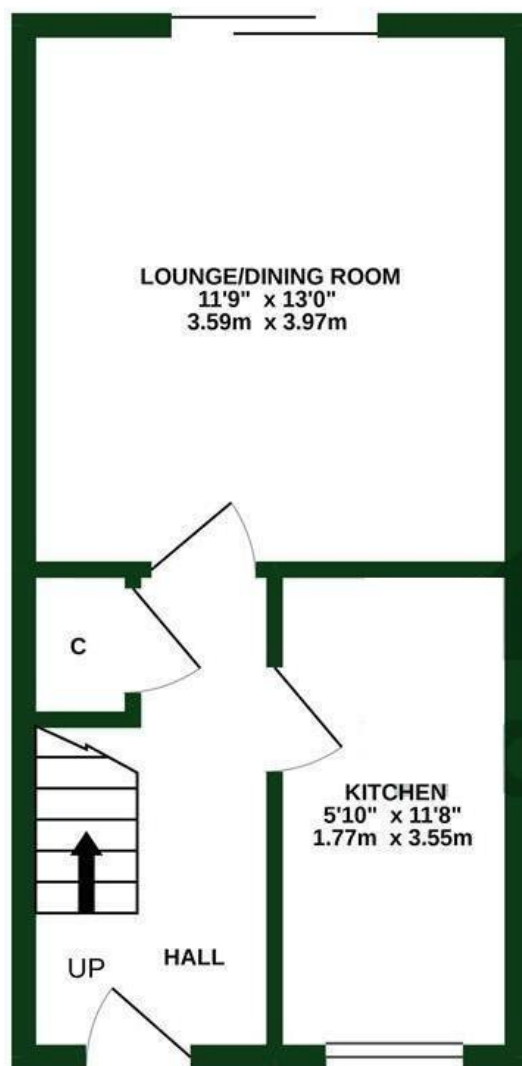

1ST FLOOR  
291 sq.ft. (27.0 sq.m.) approx.

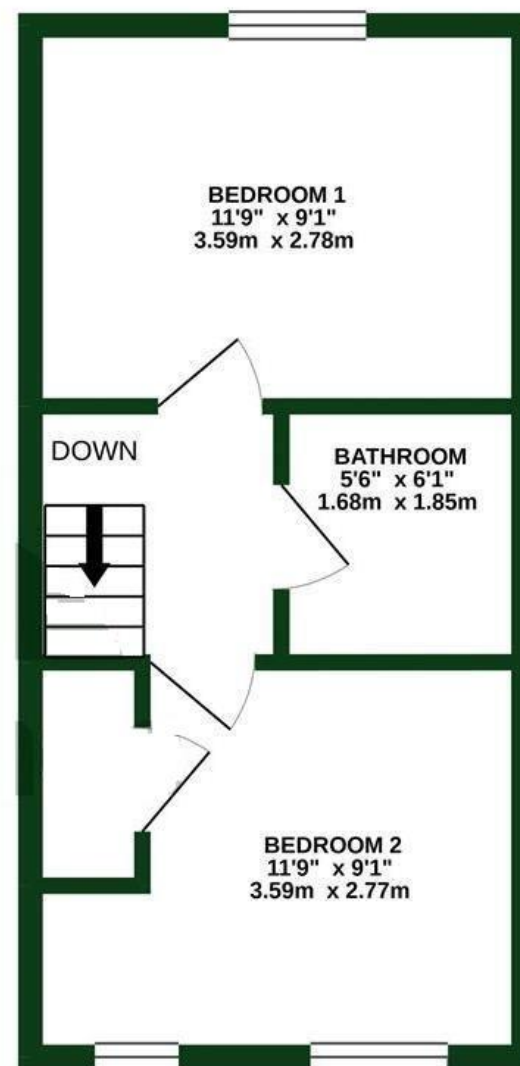

TOTAL FLOOR AREA : 582 sq.ft. (54.1 sq.m.) approx.

Whilst every attempt has been made to ensure the accuracy of the floorplan contained here, measurements of doors, windows, rooms and any other items are approximate and no responsibility is taken for any error, omission or mis-statement. This plan is for illustrative purposes only and should be used as such by any prospective purchaser. The services, systems and appliances shown have not been tested and no guarantee as to their operability or efficiency can be given.

Made with Metropix ©2020