



**1 Bed  
Apartment  
located in**

**AiHOMES.**

# Modern 1B1B Apartment | Affinity Living Riverside | M3 |150015ALRS



£230,000

Welcome to Affinity Living Riverside, a premier urban oasis nestled in the vibrant heart of Manchester. This exceptional 1-bedroom apartment offers a unique blend of contemporary design and luxurious living, making it an ideal choice for those seeking a refined urban lifestyle.

Spanning a generous 40 square feet, this meticulously crafted residence boasts an abundance of natural light, thanks to its expansive windows that frame breathtaking views of the cityscape. The interior is adorned with sleek laminate flooring, creating a modern and inviting atmosphere throughout. The fully fitted kitchen is a culinary delight, equipped with high-end appliances and stylish finishes, perfect for both cooking enthusiasts and casual diners alike.

The spacious double bedroom provides a serene retreat, while the modern bathroom, featuring a power shower, adds a touch of luxury to your daily routine.

Located in a prime area, Affinity Living Riverside places you within easy reach of a plethora of dining, shopping, and entertainment options. Immerse yourself in Manchester's rich cultural scene, explore its renowned landmarks, or indulge in the diverse culinary experiences available just moments from your doorstep.

Currently available for rent at £1,150 per month until 17th June 2024, this property also presents an attractive investment







**Modern 1B1B Apartment | Affinity Living Riverside | M3  
1150015AI PS**



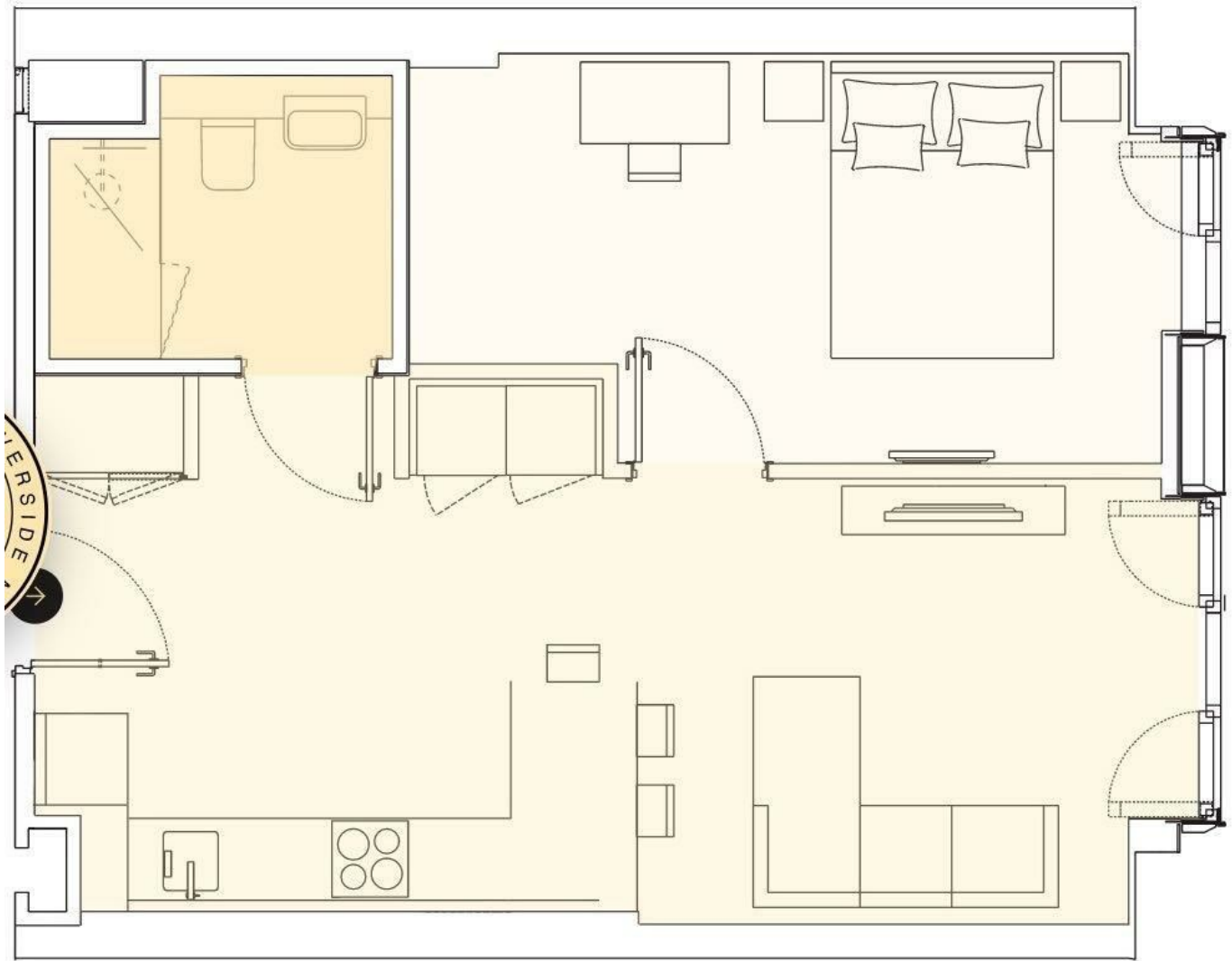

Energy Efficiency Rating		
	Current	Potential
<i>Very energy efficient - lower running costs</i>		
(92 plus) <b>A</b>		
(81-91) <b>B</b>		
(69-80) <b>C</b>		
(55-68) <b>D</b>		
(39-54) <b>E</b>		
(21-38) <b>F</b>		
(1-20) <b>G</b>		
<i>Not energy efficient - higher running costs</i>		
<b>England &amp; Wales</b>	EU Directive 2002/91/EC	

**EPC Rating:**  
**Council Tax Band: B**

**CONTACT**

5th floor, Empress Business Center  
380 Chester Road  
Manchester  
M16 9EA

E: [info@aihomes.uk](mailto:info@aihomes.uk)

T: 0127 332 8069

**AiHOMES.**