

All measurements are approximate and for display purposes only  
Total Area: 57.6 m<sup>2</sup> ... 620 ft<sup>2</sup>

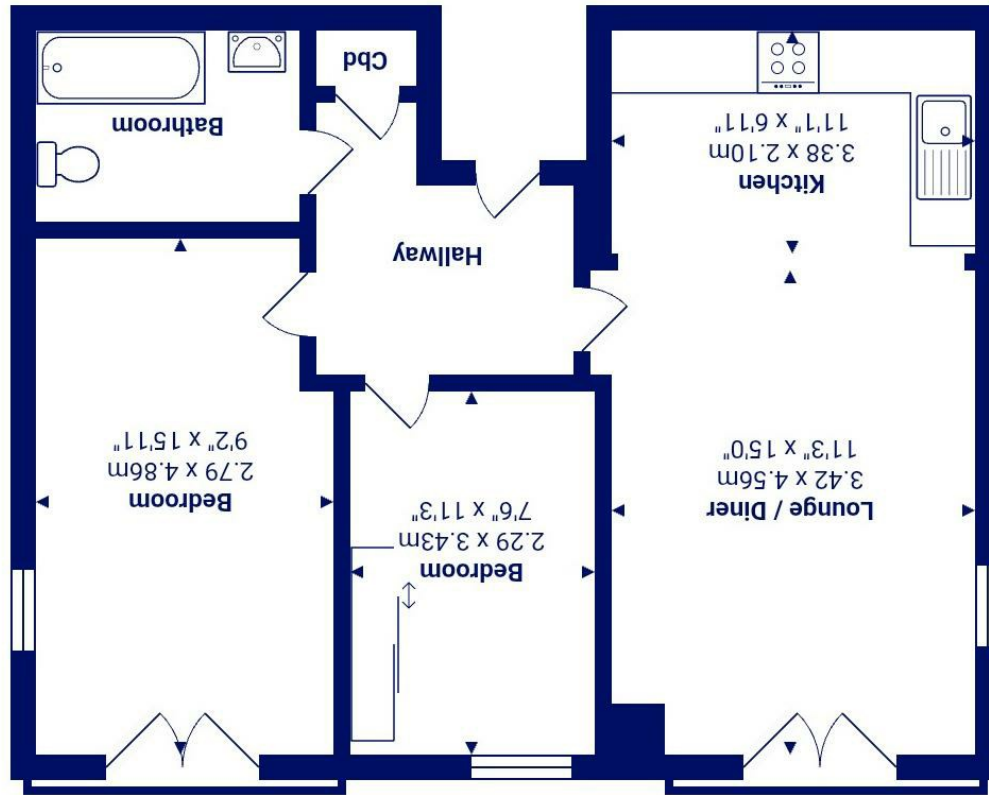

20 Twynham Road, Bournemouth, BH6 3EZ £240,000

**Mitchells**  
1963 — TODAY

A two bedroom first floor apartment situated in a modern, purpose built block in a highly sought after area, just a short walk from Southbourne Beach, High Street, Christchurch Town Centre and Hengistbury Head. Bus routes and other local amenities are also on your doorstep.

This well presented property benefits from an allocated parking space, secure bike shed and a 110 year lease. Ideal for a first time buyer or investor.

- Two bedroom first floor apartment
- Spacious lounge/dining room with Juliette balcony
- Modern kitchen with some integrated appliances
- Two double bedrooms
- Generous entrance hallway
- Family bathroom
- Allocated parking space and secure bike store
- Leasehold - lease length : 110 years
- Service charge : £1,100pa Ground rent : £150pa
- Walking distance to Southbourne Beach

EPC Rating Band: B  
Council Tax Band: B  
Leasehold

