



**POOLE
TOWNSEND**

3 Wilson House, Lindale Grange over Sands

£325,000

3 1 1



- Local Occupancy Clause Applies
- Charming mid-terrace barn conversion in a peaceful setting
- Sympathetically extended on the ground floor
- Enclosed patio garden
- First floor includes two double bedrooms, one single bedroom and a contemporary shower room
- Located on the southern edge of the Lake District National Park
- Enjoys superb views across open fields and surrounding farmland
- Bright and spacious open-plan living, dining and kitchen area
- Ideal layout for modern living and entertaining
- Benefits from off-road parking and a detached single garage for storage and practicality



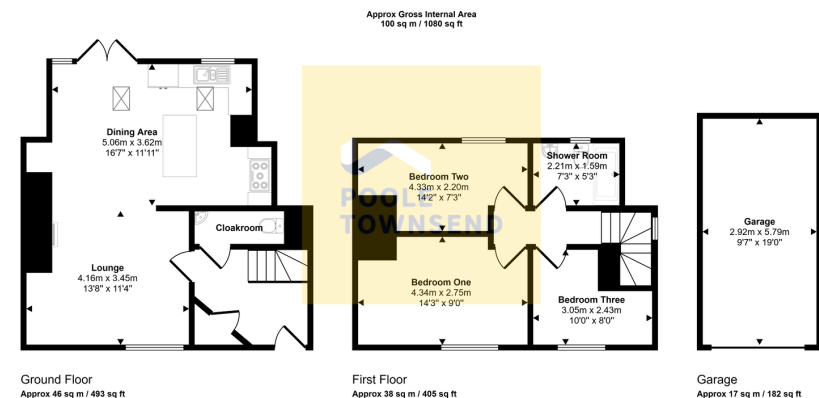

This floorplan is only for illustrative purposes and is not to scale. Measurements of rooms, doors, windows, and any items are approximate and no responsibility is taken for any error, omission or mis-statement. Icons of items such as bathroom suites are representations only and may not look like the real items. Made with Made Snappy 360.

Situated on the southern edge of the Lake District National Park, this delightful mid-terrace barn conversion occupies a peaceful setting and enjoys superb views across open fields and surrounding farmland. The property has been sympathetically extended on the ground floor to create a bright and spacious open-plan living, dining and kitchen area, which seamlessly connects to the enclosed patio garden, ideal for modern living and entertaining. To the first floor, there are two generous double bedrooms, a third single bedroom and a contemporary shower room. Externally, the property benefits from off-road parking and a detached single garage, offering excellent storage and practicality. Local Occupancy Clause Applies.

Visit us at
www.pooletownsend.co.uk
enquiries@pooletownsend.co.uk

We are open
 Monday – Friday 9.00 – 5.00
 Saturday 9.00 – 1.00

Barrow 01229 811811
 Ulverston 01229 588111
 Grange 015395 33316
 Kendal 01539 734455
 Milnthorpe 015395 62044