



## Bramhope Lane, SE7

£350,000

A beautifully presented two double bedroom, top floor apartment offering well-balanced living space throughout. The property features a generous semi open-plan kitchen, ideal for both everyday living and entertaining, which flows seamlessly into a large reception room with direct access to a private balcony. Both bedrooms are spacious doubles, complemented by a modern bathroom and excellent natural light throughout. Further benefits include an allocated private parking space, making this an ideal home for professionals or first-time buyers alike.

Situated minutes from Charlton Village for shops and amenities, bus routes to North Greenwich and the Elizabeth Line at Woolwich and close to Greenwich Park and Blackheath Royal Standard.

### Features

- Two Double Bedroom
- Top Floor Flat
- Private Parking
- Close To Shops & Bus Routes
- Private Balcony
- Lift Access

# Bramhope Lane, London, SE7

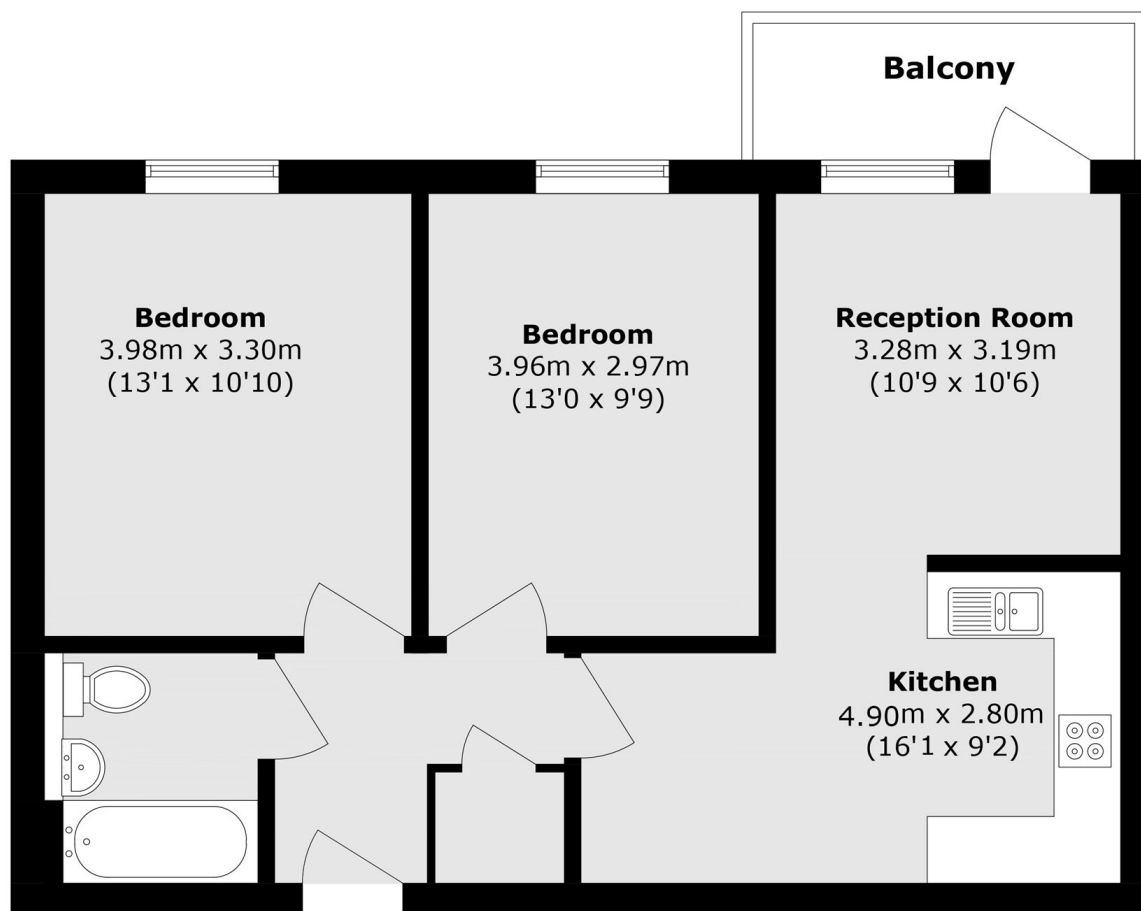

Total area (approx.): 59.9 sq. m (644.7 sq. ft)

Balcony area (approx.): 4.2 sq. m (45.2 sq. ft)