



RUSSEN & TURNER
www.russenandturner.co.uk

5 Manor Road, Heacham
King's Lynn PE31 7JZ

£299,995

Bedrooms: 3 | **Bathrooms:** 1 | **Receptions:** 1

Nestled close to Heacham Manor Golf Course and the beautiful Norfolk coastline, this three-bedroom detached chalet bungalow offers a rare opportunity to create a home that is entirely your own. Requiring updating throughout, it provides the perfect canvas for buyers with vision, a chance to re-imagine, redesign and transform it into something truly special.

Life here is all about location. Spend mornings walking along the sandy beach, afternoons exploring the surrounding countryside, or evenings enjoying a relaxing round of golf just moments from your door. Opportunities to secure a home in such a sought-after setting, with this level of potential, are few and far between.

Tucked away along a private lane, the property sits within a deceptively generous plot. Mature trees frame the plot, offering a wonderful sense of privacy and seclusion, while the driveway leads down to the house, garage and ample off-road parking.

Step inside and the possibilities immediately become clear. The rooms are bright, airy and well proportioned, ready for modernisation and a fresh vision. Whether you choose to enhance the existing layout or completely rework the flow of the home, the space available provides endless potential.

The current accommodation includes an entrance hall, a generous 22ft living/dining room, kitchen, cloakroom and a versatile fourth room on the ground floor, ideal as a study, snug or occasional bedroom. Upstairs, you will find two spacious double bedrooms along with a third room that would make an excellent nursery, dressing room or home office. A shower room and separate WC complete the accommodation.

Outside, the sense of opportunity continues. The plot stretches to over 180ft in length (SMTS) from front to back, with the rear garden offering fantastic privacy and space to create a wonderful outdoor retreat. Whether you dream of landscaped gardens, entertaining areas, or simply a peaceful place to relax in the sun, there is ample room to bring those ideas to life.

The front of the property also offers further possibilities. While the mature trees provide privacy, there is scope to reconfigure the space, perhaps creating additional parking, expanding the garden, or adding another garage or cart shed.

For those looking for a project in a superb coastal location, this is a home filled with potential, an opportunity to take something full of character and transform it into the lifestyle property you have always imagined.

Tenure: Freehold

Property Type: Detached Bungalow

- Detached Chalet Bungalow
- Three Bedrooms
- Two Reception Rooms
- Deceptively Large Plot
- No Onward Chain
- Field Views from First Floor
- Generous Living/Dining Room
- Off-road Parking and Garage
- Gas Central heating
- Close to Norfolk Coastline and Heacham Manor Golf Course

Disclaimer

1. To meet money-laundering regulations, all buyers will need to complete an ID check. We'll ask you to provide the necessary documents, and there's a small fee of £20.50 per client for this service.
2. We do our best to make sure our property details are fair, accurate, and up to date, but they're meant as a general guide only. If there's anything particularly important to you, please get in touch – we'll be happy to look into it further.
3. All measurements are provided as a guide and may not be exact.
4. We haven't tested any of the property's services, equipment, or appliances. We recommend that buyers arrange their own survey or service checks before making a final offer.
5. These details are provided in good faith, but they don't form part of any offer or contract. Buyers should verify any points that are important to them before proceeding.



GROUND FLOOR
758 sq.ft. (70.4 sq.m.) approx.

1ST FLOOR
441 sq.ft. (41.0 sq.m.) approx.

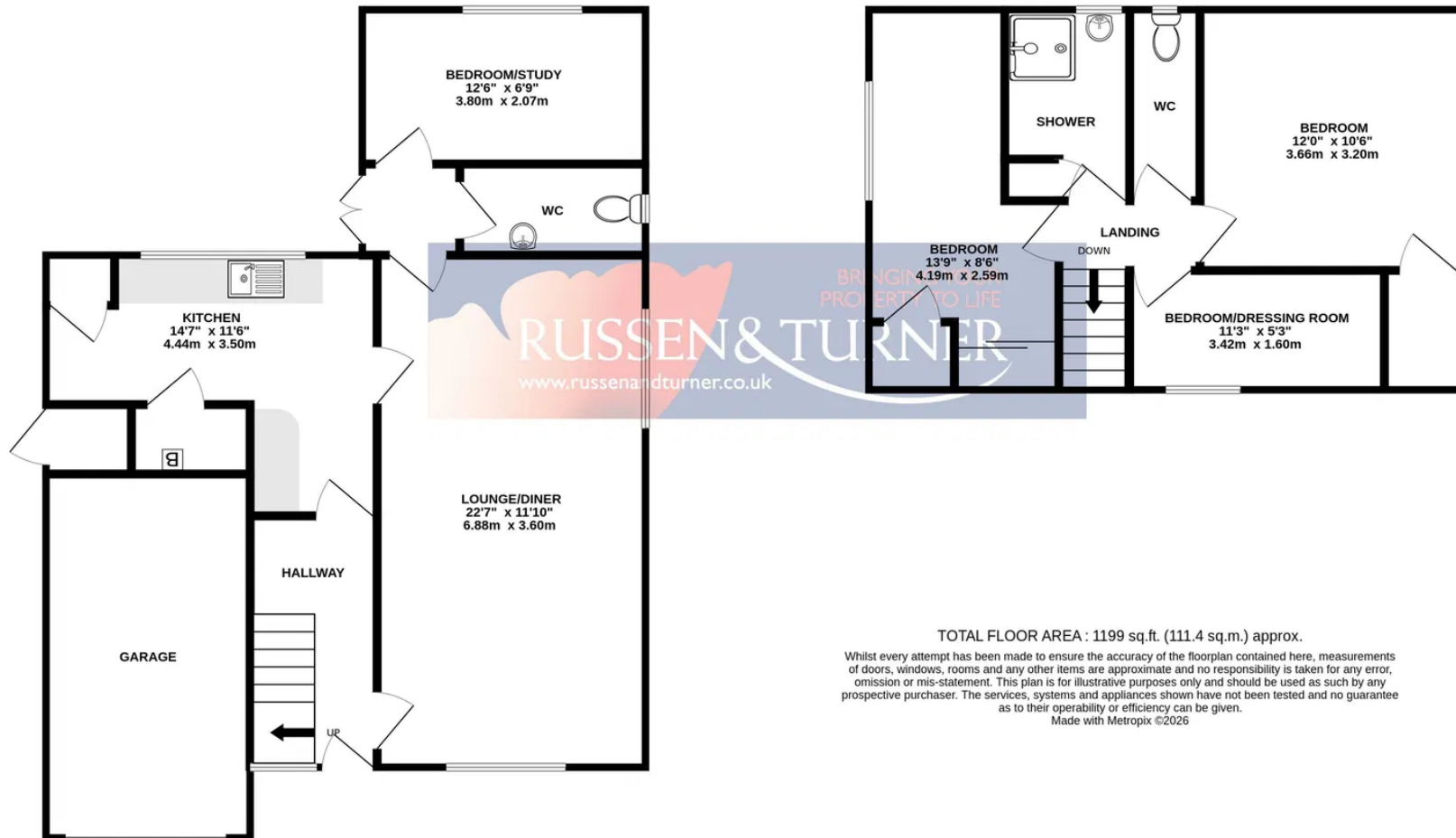

TOTAL FLOOR AREA : 1199 sq.ft. (111.4 sq.m.) approx.

Whilst every attempt has been made to ensure the accuracy of the floorplan contained here, measurements of doors, windows, rooms and any other items are approximate and no responsibility is taken for any error, omission or mis-statement. This plan is for illustrative purposes only and should be used as such by any prospective purchaser. The services, systems and appliances shown have not been tested and no guarantee as to their operability or efficiency can be given.
Made with Metropix ©2026