



## Argyle Road, W13

£430,000

A first floor two bedroom purpose built apartment with wonderful views over Cleveland Park from the living room and principal bedroom. Presented in excellent condition throughout with a large living room, newly renovated separate kitchen and modern bathroom.

Located on Cleveland Road, opposite Cleveland Park and half a mile to the new West Ealing rail station (Elizabeth Line). Pitshanger Lane shops and restaurants are within half a mile.

### Features

- Two Bedrooms
- First Floor
- Newly Modernised
- No Onward Chain
- Communal Gardens
- Garage

# Argyle Road, London, W13

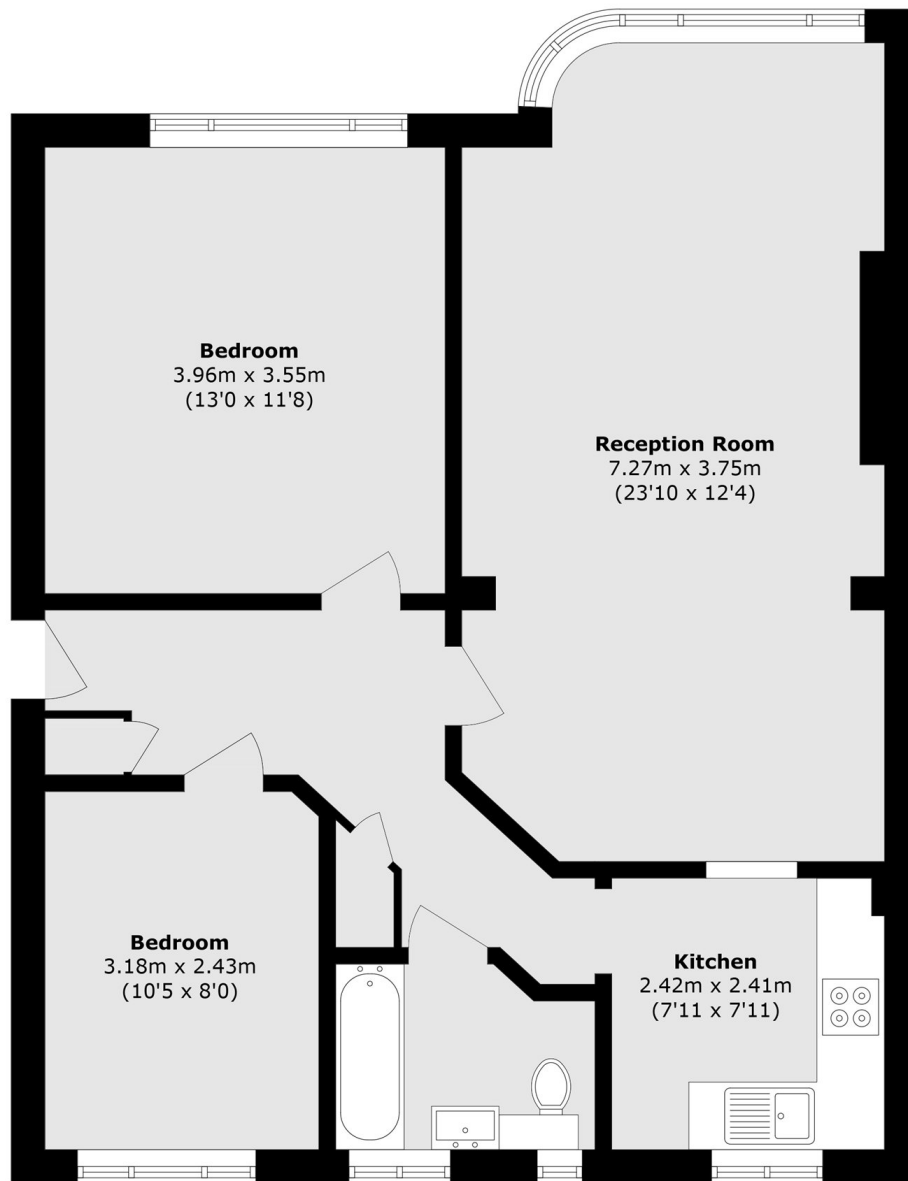

Total area (approx.): 68.9 sq. m (741.6 sq. ft)