



Cavendish Road, NW6

£450 Per week

A spacious one bedroom apartment with a separate kitchen, reception room, bathroom suite, double bedroom and access to a communal garden. Perfect for a professional couple or single occupant.

Cavendish Road is close to numerous shops, cafes and restaurants of Queens Park's Salusbury Road. Excellent transport links include both Brondesbury Park and Brondesbury Overground stations and Kilburn underground.

Features

- One Double Bedroom
- Victorian Property
- Large Living Room
- High Ceilings
- Separate Kitchen
- Communal Garden

Cavendish Road, London, NW6

Ground Floor

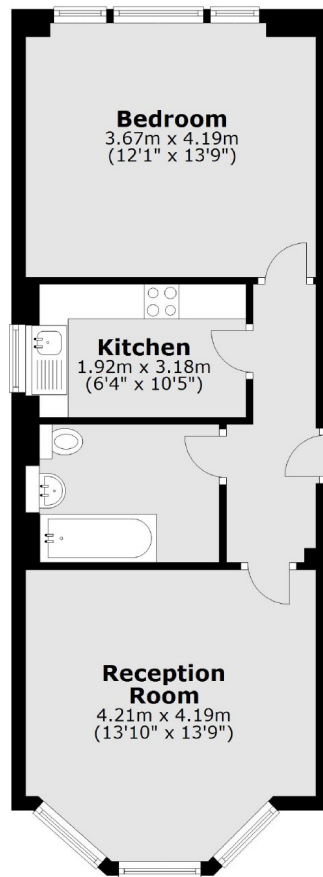

Total area: approx. 49.0 sq. metres (527.5 sq. feet)