



Forsdene Walk

Coalway, Coleford, GL16 7JZ

£340,000



A beautifully presented detached bungalow, ideally positioned on the edge of woodland in the popular village of Coalway. The property offers spacious and versatile accommodation, including a generous lounge, a stylish modern bathroom, two well-proportioned bedrooms, and a large kitchen/dining room ideal for everyday living and entertaining.

A standout feature of the home is the converted garage, now forming a self-contained annexe. This useful space comprises a bedroom/living area along with an additional room already fitted with plumbing, offering excellent potential for a bathroom or utility room.

Coalway itself is a well-served village, offering two convenience stores, a primary school, and regular bus links, along with access to scenic woodland walks. The nearby market town of Coleford, just approximately one mile away, provides a wider range of amenities including supermarkets, doctors' surgeries, dentists, independent shops, and a selection of cafés.

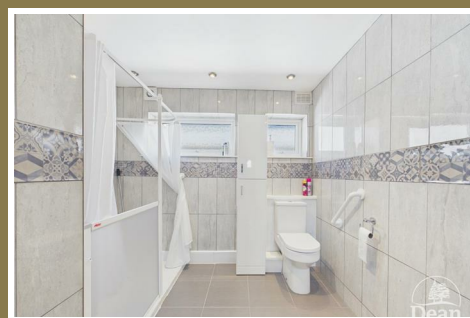

Approached via UPVC door with a double glazed stained glass frosted window into:

Entrance Porch:

4'5" x 2'5" (1.35m x 0.76m)

Lighting, tiled flooring, UPVC door with frosted glass into entrance hallway.

Entrance Hallway:

14'8" x 7'4" (4.49m x 2.26m)

Power & lighting, double panelled radiator, UPVC double glazed window, doors to bedrooms, lounge & kitchen, smoke alarm, thermostat.

Lounge:

17'5" x 13'9" (5.31m x 4.21m)

Feature gas fireplace, UPVC double glazed sliding doors with inset blinds to rear garden, TV point, power & lighting, double panelled radiator, TV aerial, three UPVC double glazed windows.

Kitchen/Dining Room:

13'10" x 12'10" (4.22m x 3.93m)

A range of base units, wall units and drawers, one & a half ceramic sink with drainer unit, tiled splashbacks, space & plumbing for washing machine, space & plumbing for dishwasher, space for fridge, space for oven, extractor fan, space for dining table and chairs, TV point, double panelled radiator, power

& lighting, UPVC double glazed French doors to patio, UPVC double glazed window, door to annexe.

Bedroom One:

13'7" x 9'6" (4.16m x 2.92m)

Built in wardrobes, power & lighting, UPVC double glazed window., double panelled radiator, TV point.

Bedroom Two:

9'6" x 7'4" (2.92m x 2.25m)

UPVC double glazed window, power & lighting, loft access, double panelled radiator.

Bathroom:

9'6" x 8'9" (2.91m x 2.67m)

A modern, floor to ceiling tiled suite benefitting from a large walk in shower with rainfall shower head and a hand rail, heated towel rail, W.C. with hand rail, vanity unit with inset wash hand basin, wall mounted mirrored cabinet, storage cupboards, two UPVC frosted double glazed windows, extractor fan, airing cupboard housing the combi boiler.

Annexe:

Open Plan Lounge/Bedroom:

15'8" x 8'8" (4.80m x 2.65m)

Power & lighting, built in storage, LED spotlights, double panelled radiator, UPVC double glazed door

to front aspect, two UPVC double glazed windows, door to utility room.

Utility Room:

8'11" x 5'1" (2.72m x 1.57m)

Power & lighting, plumbing fitted ready for a bathroom or a utility room, UPVC double glazed frosted window door to garden, double panelled radiator, UPVC double glazed window.

Outside:

The property is situated at the end of a cul-de-sac

close to woodland. You are met with a composite driveway for roughly four vehicles, to your right you will see a range of mature shrubs and a lawn.

As you enter the garden from the French doors through the kitchen, you are met with a patio area perfect for seating, above this there is a large electric awning perfect to use on a hot summers day. Beyond this you are met with an enclosed lawned area with maturing shrubs boarding the garden. To the side of the property there is a private patio area with a large shed.



Consumer Notes: Dean Estate Agents Ltd have prepared the information within this website/brochure with care and co-operation from the seller. It is intended to be indicative rather than definitive, without a guarantee of accuracy. Before you act upon any information provided, we request that you satisfy yourself about the completeness, accuracy, reliability, suitability or availability with respect to the website or the information, products, services, or related graphics contained on the website for any purpose.

These details do not constitute any part of any Offer, Contract or Tenancy Agreement.

Photographs used for advertising purposes may not necessarily be the most recent photographs, although every effort is made to update photographs at the earliest opportunity. Any reliance you place on such information is therefore strictly at your own risk. All photographic images are under the ownership of Dean Estate Agents Ltd and therefore Dean Estate Agents retain the copyright. You must obtain permission from the owner of the images to reproduce them.

Tenanted Property – we are not always able to show the most recent condition of a property due to tenants' privacy and we may choose to show the photographs of the property when it was last vacant to at least allow clients some idea of the internal condition. Therefore, we would of course, urge you to view before making any decisions to purchase or rent the property and before any costs.

Energy Performance Certificates are supplied to us via a third party and we do not accept responsibility for the content within such reports.

PRC Certificates – Some ex-local authority properties have been repaired in recent years using the PRC Scheme wherein a certificate has been produced by a qualified property engineer. This certificate does not imply the suitability for a mortgage approval and you must satisfy yourself of the work carried out that may meet your lenders criteria.

As with leasehold property or new build development sites, you are likely to be responsible for a contribution to management charges and/or ground rent or a contribution to the development service charge. Please enquire at the time of viewing.

You may also incur fees for items such as leasehold packs and, in addition, you will also need to check the remaining length of any lease before you complete a mortgage application form.

Please ask a member of our team for any help required before committing to purchase a property and incurring expense.

Road Map



Hybrid Map



Terrain Map



Floor Plan

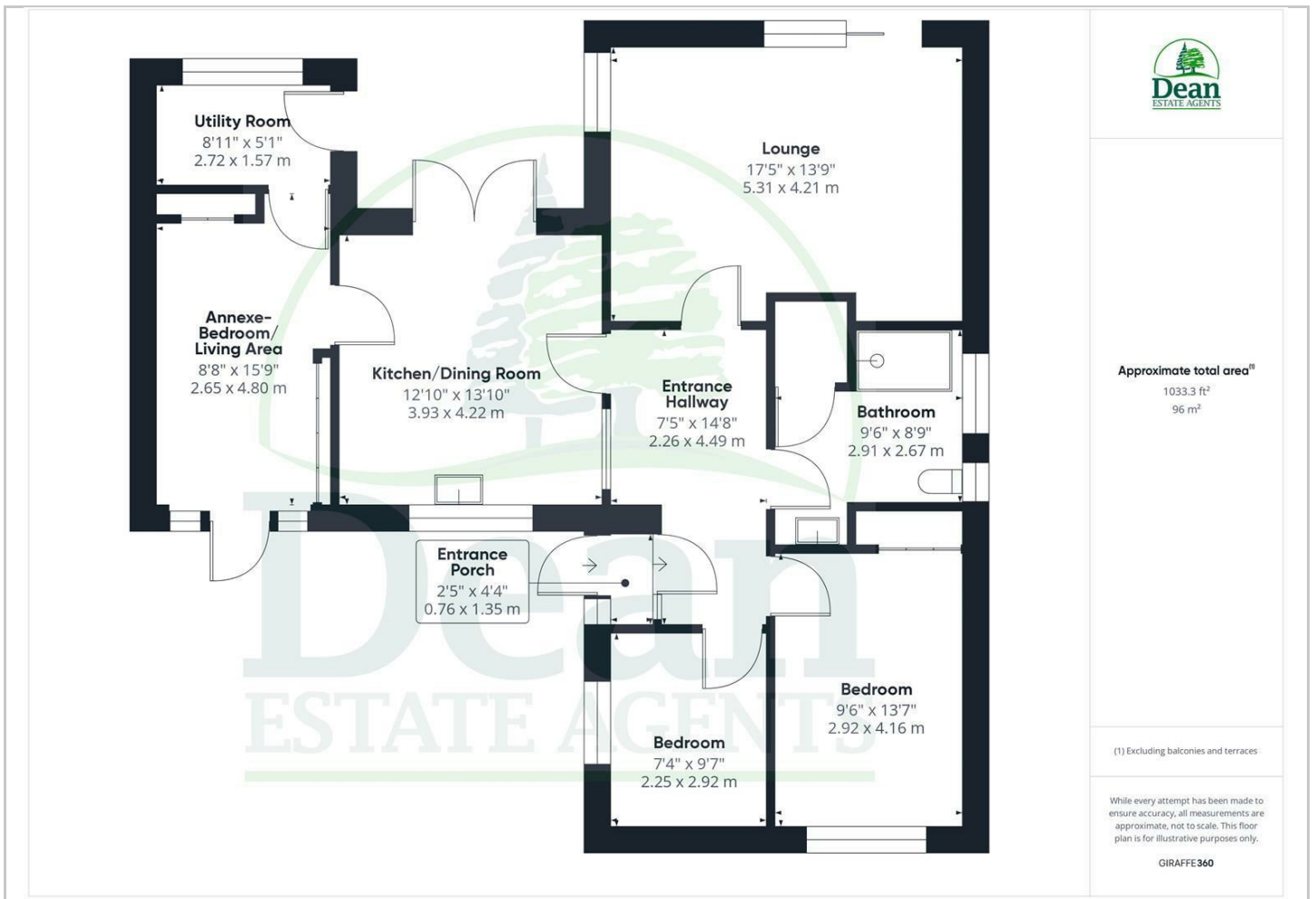

Viewing

Please contact our Coleford Office on 01594 835751 if you wish to arrange a viewing appointment for this property or require further information.

Energy Efficiency Graph

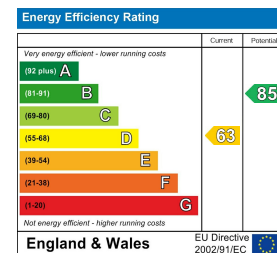

These particulars, whilst believed to be accurate are set out as a general outline only for guidance and do not constitute any part of an offer or contract. Intending purchasers should not rely on them as statements of representation of fact, but must satisfy themselves by inspection or otherwise as to their accuracy. No person in this firm's employment has the authority to make or give any representation or warranty in respect of the property.