



34, Heathclose Road, Dartford DA1 2PU
Guide Price £600,000



Guide Price Range £600,000-£625,000

Situated in the lovely Dartford Heath location, close to all popular schools and transport links, is this very well presented beautiful period 4 bedroom end of terrace family home. With accommodation comprising of entrance hall, downstairs WC, living room, fitted kitchen, large utility room and a dining room with French doors to a secluded landscaped garden with a secret door to a further garden area with a storage shed. There are 4 spacious bedrooms to the first floor and a family bathroom. In addition the property overlooks Dartford Heath and also features double glazing, gas central heating, off road parking, garage en bloc which includes a parking space at the front for one car and easy access from the front to the rear garden. Your earliest viewing would be very highly recommended of this lovely family home.

Local Authority: Dartford Borough Council
Council Tax Band: D



01322 553322

60-62 High Street, Bexley, Kent DA5 1AH

bexley@parkestates.co.uk
www.parkestates.co.uk

Heath Close Road, DA1

Approximate Gross Internal Area = 139.1 sq m / 1498 sq ft

Shed = 4.5 sq m / 48 sq ft

Total = 143.6 sq m / 1546 sq ft

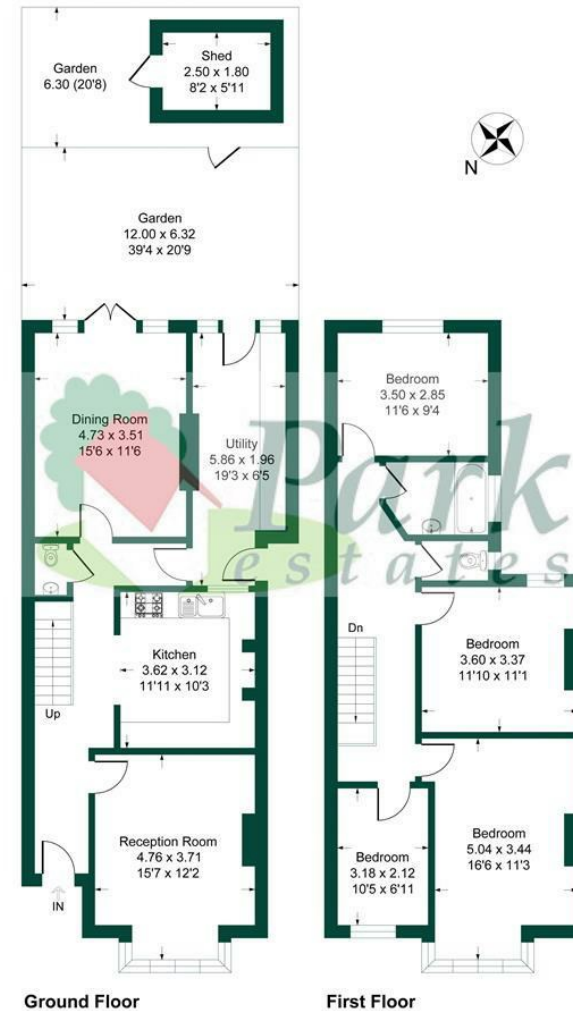

This plan is for layout guidance only. Not drawn to scale unless stated. Windows and door openings are approximate. Whilst every care is taken in the preparation of this plan, please check all dimensions, shapes and compass bearings before making any decisions reliant upon them.
Produced By Planpix

Every care has been taken with the preparation of details, but accuracy is in no way guaranteed. These particulars do not constitute a contract and are issued and accepted on the express understanding that all negotiations will be conducted through Park Estates. The seller does not make or give, nor do we or our employees have any authority to give a representation or warranty in relation to the property. Please contact this office before viewing the property. If there is any point which is of particular importance to you, we will be pleased to check the information for you and confirm that the property remains available. This is particularly important if you are contemplating travelling some distance to view the property. We would strongly recommend that all the information that we provide about the property is verified by yourself on inspection and also by your conveyancer, especially where statements have been made by us to the effect that the information provided by us has not been verified.