

# Towers Wills

Town & Country

📞 01935 577 032 | 01460 298 530 | ✉ info@towerswills.co.uk



8, Balmoral Road, Yeovil, Somerset BA21 5JH

Offers Over **£200,000**

A well presented three bedroom mid-terraced home with garage and garden, conveniently situated within easy reach of local amenities and Yeovil town centre.

**Accommodation:**

Towers Wills are pleased to welcome to the market this three bedroom mid-terraced house, conveniently situated within easy reach of local amenities and Yeovil town centre. The property has been very well maintained by the current owner and has been successfully utilised as a buy-to-let investment, but which would appeal to both investors and first-time buyers alike.

The property is presented in good order throughout, although some modernisation and updating would be required to better suit contemporary living requirements.

To the ground floor there is a useful utility room and a well-equipped kitchen. From the hallway, a generous lounge/dining room provides a bright and welcoming living space with access leading out to the rear garden.

To the first floor are three bedrooms, two of which are doubles, with the main bedroom benefiting from built-in storage. A family bathroom completes the first floor accommodation.

**Outside:**

Externally, the rear garden is of a low maintenance, hard landscaped design, ideal for ease of upkeep. To the front, the property enjoys a pleasant outlook across the local park.

An added benefit of the property is a single garage located in a separate block nearby.

Viewing is highly recommended to fully appreciate the space, condition and potential this property has to offer.

Key Features

- Well Presented
- Terraced Property
- Three Bedrooms
- Enclosed Garden
- Garage

Contact Us

**Towers Wills Estate  
Agents - Yeovil**  
114, Hendford Hill  
Yeovil  
Somerset  
BA202RF  
T: 01935 577032  
E: [info@towerswills.co.uk](mailto:info@towerswills.co.uk)

Energy Efficiency

Score	Energy rating	Current	Potential
92+	A		
81-91	B		86 B
69-80	C	74 C	
55-68	D		
39-54	E		
21-38	F		
1-20	G		



# Floor Plan

GROUND FLOOR

1ST FLOOR

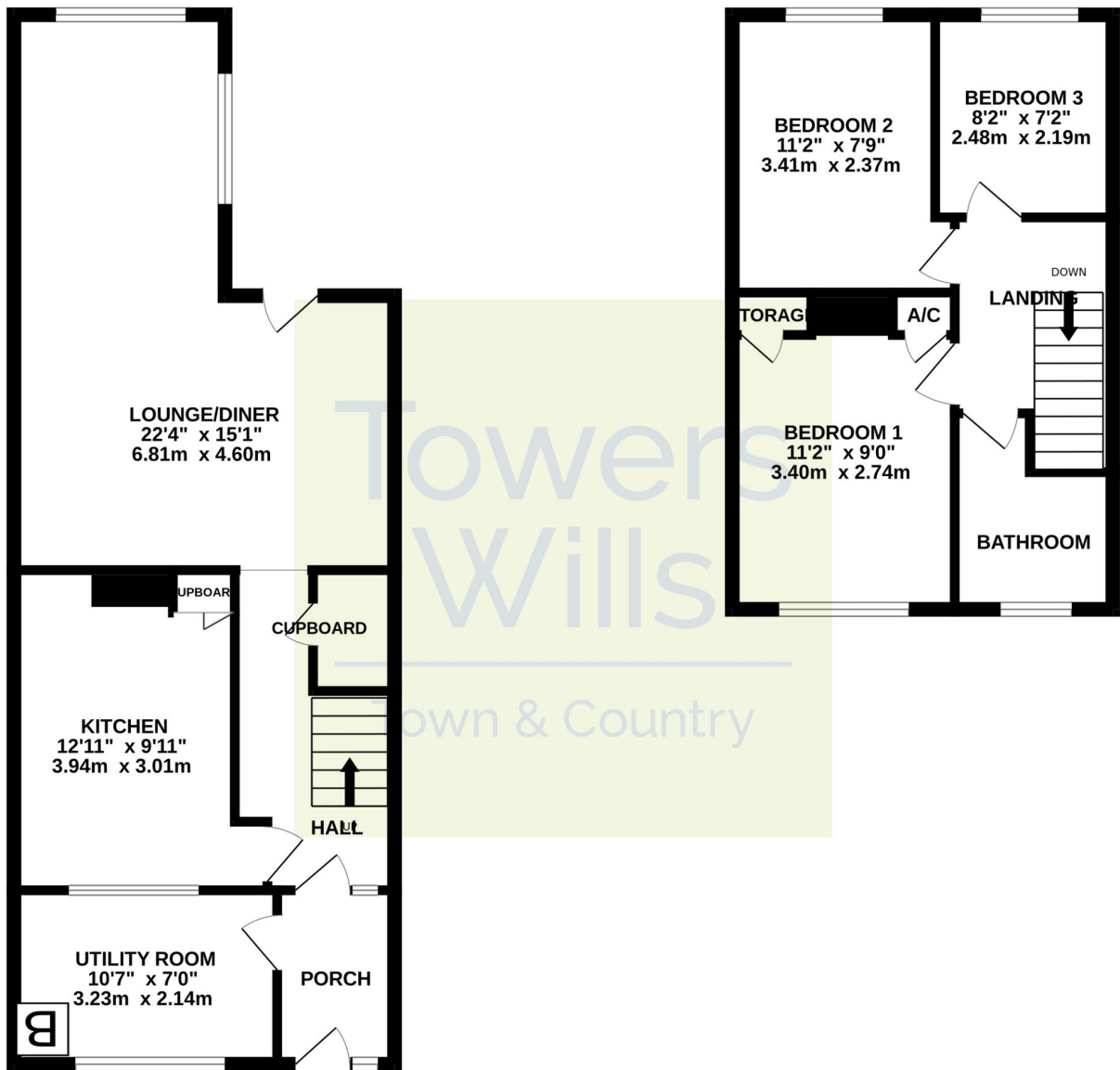

Whilst every attempt has been made to ensure the accuracy of the floorplan contained here, measurements of doors, windows, rooms and any other items are approximate and no responsibility is taken for any error, omission or mis-statement. This plan is for illustrative purposes only and should be used as such by any prospective purchaser. The services, systems and appliances shown have not been tested and no guarantee as to their operability or efficiency can be given.  
Made with Metropix ©2026

Please Note No tests have been undertaken of any of the services and any intending purchasers should satisfy themselves in this regard. Towers Wills Ltd for themselves and for the vendor of this property whose agents they are, give notice that, (i) these particulars do not constitute any part of an offer or contract, (ii) all statements contained within these particulars are made without responsibility on the part of Towers Wills or the vendor , (iii) whilst made in good faith, none of the statements contained within these particulars are to be relied upon as a statement of representation or fact , (iv) any intending purchaser must satisfy him/herself by inspection or otherwise as to the correctness of each of the statements contained within these particulars, (v) the vendor does not make or give either Towers Wills or any person in their employment any authority to make or give representation or warranty whatsoever in relation to this property.

Photographs / Floor Plans Photographs are reproduced for general information and it must not be inferred that any item is included for sale with this property. Please note