



Old Brompton Road, SW5

£480,000

Set on the first floor of an impressive Victorian residence, this beautifully presented one-bedroom apartment offers a rare combination of charm, space, and natural light. The property enjoys a bright and elegant outlook. Expansive sash windows flood the interior with daylight, while showcasing the apartment's remarkable ceiling height creating a wonderful sense of volume and grandeur throughout. This delightful home perfectly blends period character with comfortable modern living, making it an ideal choice for those seeking a stylish and tranquil retreat in a distinguished setting.

Located just moments from all of the amenities of Old Brompton Road, making it an ideal and convenient location. South Kensington underground is the closest tube, with the A4 making it convenient for car access in and out of London.

Features

- First Floor Apartment
- Highly Sought After Location
- No Ongoing Chain
- High Ceilings
- Share Of Freehold
- Close To Earls Court

Old Brompton Road, London, SW5

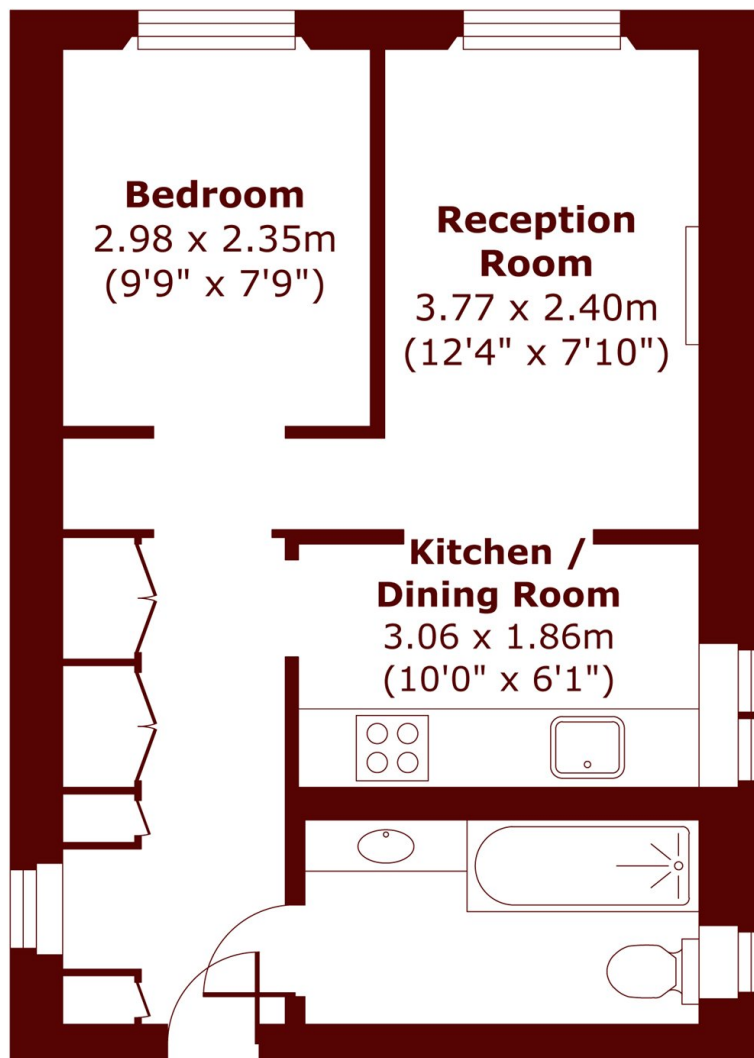

FIRST FLOOR

APPROX. GROSS INTERNAL FLOOR AREA
393 SQFT / 36.48 SQM