

Baxter Avenue , Southend-On-Sea SS2 6HX

- One bedroom ground floor flat
- Private west backing rear garden
- Close to town centre
 - Low charges
 - Utility Room
- Off-road parking for two cars
- Stunning and modern design
- Near Southend Victoria station
- Spacious bay fronted lounge
 - 147 Year Lease

Guide Price £220,000 Leasehold



Location

Entrance Hall

Living Room

13'10 x 11'6

Bedroom

12'4 x 11'5

Kitchen/dining

11'6 x 10'6

Utility

9'4 x 3'3

Bathroom

These particulars are accurate to the best of our knowledge but do not constitute an offer or contract. Photos are for representation only and do not imply the inclusion of fixtures and fittings. The floor plans are not to scale and only provide an indication of the layout.





Local Authority
Council Tax Band **B**
EPC Rating **D**

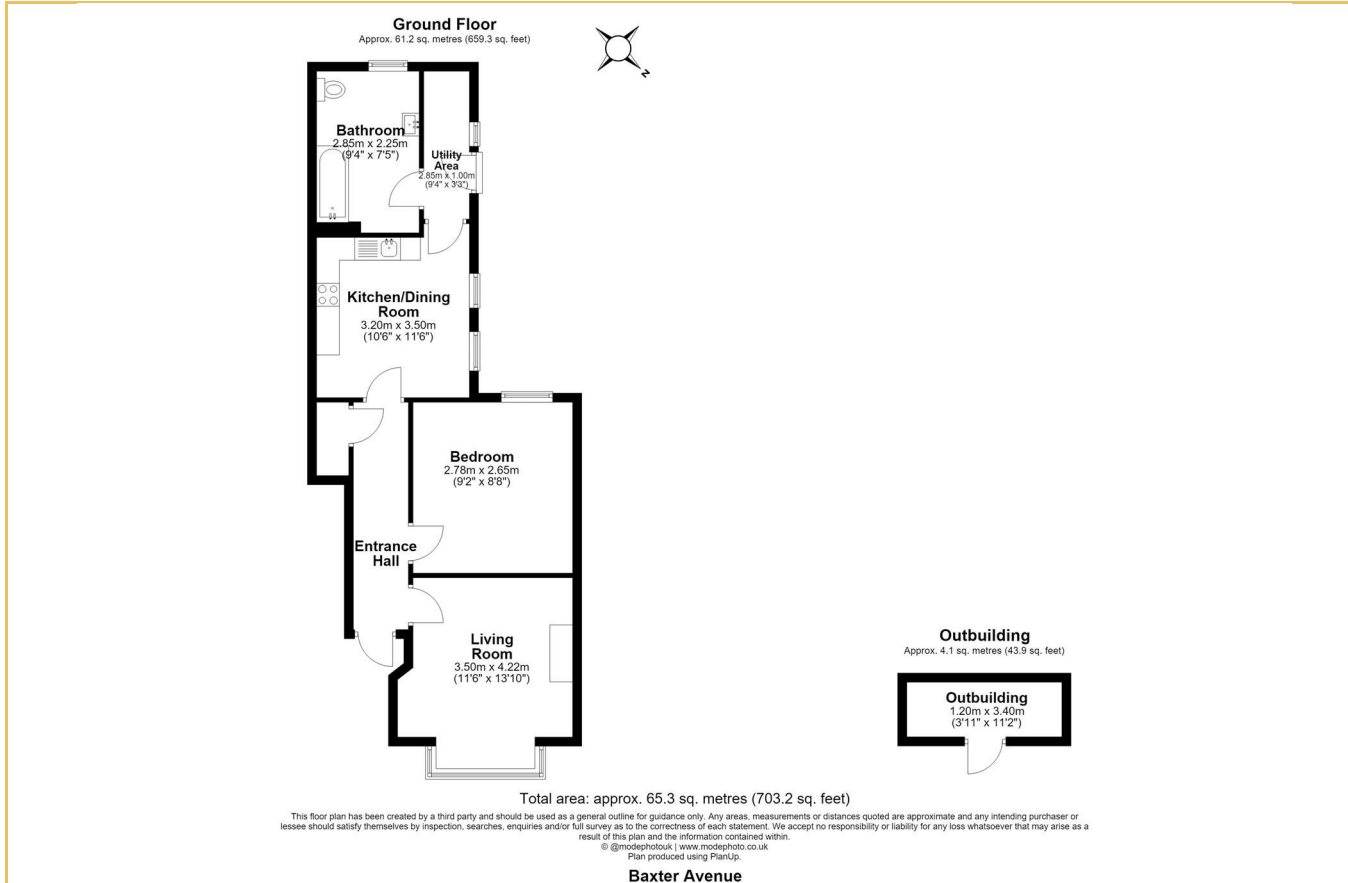

Sales Office
190 London Road
Southend-On-Sea
Essex
SS1 1PJ

Contact
01702 34 11 77
<https://hairandson.co.uk/>

Agents Note: Whilst every care has been taken to prepare these particulars, they are for guidance purposes only. All measurements are approximate and for general guidance purposes only and whilst every care has been taken to ensure accuracy, they should not be relied upon and potential buyers/tenants are advised to recheck the measurements.

