



**CARVER**  
RESIDENTIAL  
Sales · Lettings · Property Management

Northallerton Road  
Brompton, Northallerton, DL6 2QN

**Offers in the region of £185,000**

House - Terraced  
2 Bedroom/s  
1 Bathroom/s



A beautifully presented two double bed roomed mid terraced home benefitting from gas fired central heating and Upvc double glazing. The spacious accommodation includes an entrance hall, spacious living room with wood floor covering and gas fire with impressive period style fire place and under stairs storage cupboard. The kitchen is fitted with a lovely modern gray high gloss wall and base units with quartz work tops and integrated appliances including oven, hob, fridge and freezer. There is also a useful utility room with stable door to the rear courtyard. To the first floor there are two double bedrooms and a family bathroom fitted with a white suite including corner bath and shower cubical. The loft is accessible via a ladder and is partially boarded. Externally there is a rear courtyard garden, garden store and a pedestrian gate to the rear.







- Beautifully presented two double bedroomed terraced property
- Spacious living room with period style fire place
- Gas fired central heating and Upvc double glazing
- Modern grey high gloss fitted kitchen with integrated appliances
- First floor bathroom including shower cubicle

#### GENERAL INFORMATION

Tenure: Freehold

Services: Gas central heating, mains electric, water and drainage.

Double glazing.

Local Authority: North Yorkshire Band B

Buyer(s) Identification Checks

Should a purchaser(s) have an offer accepted on a property marketed by Carver Residential they will need to undertake an identification check. This is done to meet our obligation under Anti Money Laundering Regulations (AML) and is a legal requirement. We use a specialist third party service to verify your identity, this is not a credit check and will have no effect on credit history. The cost of these checks is £36 inc. VAT per buyer, which is paid in advance, when an offer is agreed and prior to a sales memorandum being issued. This charge is non-refundable.

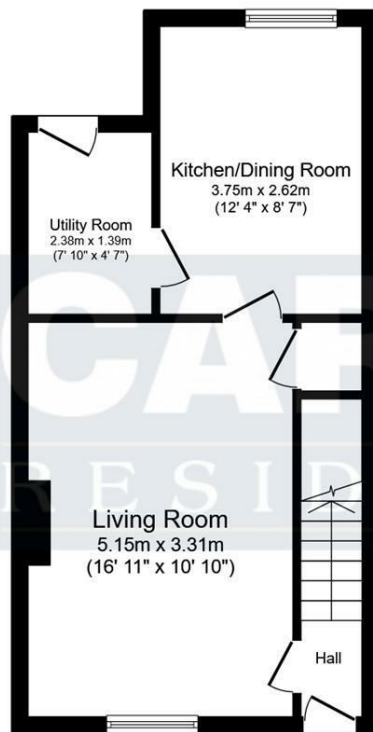

### Ground Floor

Floor area 36.9 sq.m. (397 sq.ft.)

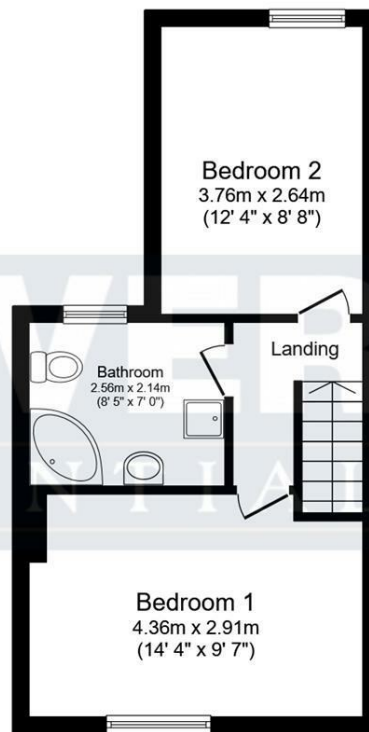

### First Floor

Floor area 32.6 sq.m. (351 sq.ft.)

Total floor area: 69.6 sq.m. (749 sq.ft.)

This floor plan is for illustrative purposes only. It is not drawn to scale. Any measurements, floor areas (including any total floor area), openings and orientations are approximate. No details are guaranteed, they cannot be relied upon for any purpose and do not form any part of any agreement. No liability is taken for any error, omission or misstatement. A party must rely upon its own inspection(s). Powered by [www.Propertybox.io](http://www.Propertybox.io)

Energy Efficiency Rating		
	Current	Potential
Very energy efficient - lower running costs		
(92 plus) A		86
(81-91) B		
(69-80) C		61
(55-68) D		
(39-54) E		
(21-38) F		
(1-20) G		
Not energy efficient - higher running costs		
England & Wales		EU Directive 2002/91/EC

**We can search 1,000s of mortgages for you**

It could take just 15 minutes with one of our specialist advisers:  
Call: 01325 380088. Visit: Any of our Offices. Online: [www.mortgageadvicebureau.com/carver](http://www.mortgageadvicebureau.com/carver)



Your home may be repossessed if you do not keep up repayments on your mortgage.  
There will be a fee for mortgage advice. The actual amount you pay will depend upon your circumstances.  
The fee is up to 1% but a typical fee is 0.3% of the amount borrowed

MAB 6202



These particulars do not constitute any part of an offer or contract. None of the statements contained in these particulars are to be relied on as statements or representations of fact and any intending purchaser must satisfy himself by inspection or otherwise to the correctness of each of the statements contained in these particulars. The vendor does not make or give, and neither Nick & Gordon Carver Residential or Commercial, Nick & Gordon Carver, nor any person in their employment has any authority to make or give any representation or warranty whatever in relation to this property



14 Duke Street, Darlington  
Co Durham, DL3 7AA  
01325 357807  
[sales@carvergroup.co.uk](mailto:sales@carvergroup.co.uk)

63 Dalton Way, Newton Aycliffe  
Co Durham DL5 4NB  
01325 320676  
[aycliffe@carvergroup.co.uk](mailto:aycliffe@carvergroup.co.uk)

41 Market Place, Richmond  
North Yorkshire, DL10 4QL  
01748 825317  
[richmond@carvergroup.co.uk](mailto:richmond@carvergroup.co.uk)

219 High Street, Northallerton  
North Yorkshire DL7 8LW  
01609 777710  
[northallerton@carvergroup.co.uk](mailto:northallerton@carvergroup.co.uk)

[www.carvergroup.co.uk](http://www.carvergroup.co.uk)