



Because property is personal with...

Pondcroft Road, Knebworth

BELVOIR!

£1,550 PCM



Key Features

- 2 Bedroom House
- Close to train station and local amenities
- 2 Bathrooms
- Good size garden
- Gas central heating
- Holding deposit - £357
- EPC rating D
- Council Tax Band - D





Belvoir Welwyn are delighted to offer this two-bedroom house, located in Knebworth. The property is conveniently situated close to the mainline rail link and local shopping facilities. The property comprises a spacious lounge/dinning room, kitchen and downstairs bathroom. Upstairs has two generously sized bedrooms and a family bathroom. The property further benefits from gas central heating and a good-sized rear garden.

Knebworth in Hertfordshire is a sought-after location, recognised for its excellent transport connections and well-established community infrastructure. The area offers a range of local amenities including shops, dining options, and recreational facilities, as well as convenient access to green spaces.





Ground Floor

Floor area 39.0 sq. m. (420 sq. ft.) approx

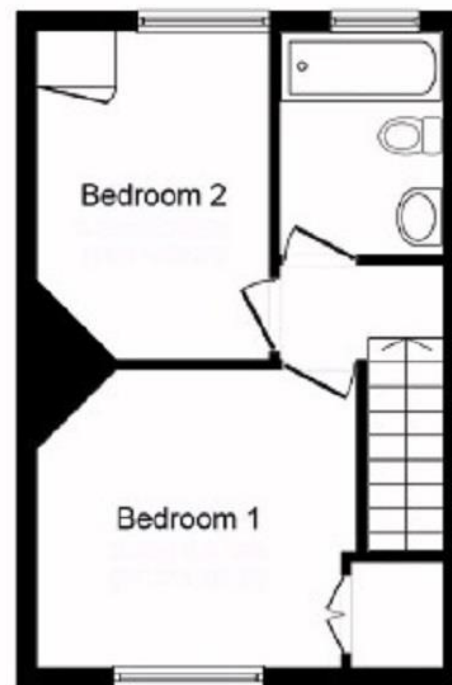

First Floor

Floor area 30.0 sq. m. (323 sq. ft.) approx

Total floor area 69.0 sq. m. (743 sq. ft.) approx



BELVOIR!