



Morris Road, South Nutfield

£950,000





“

A beautifully modernised four-bedroom detached home positioned on the highly sought-after Morris Road in South Nutfield village, offering spacious and versatile accommodation ideal for family living. With a modern kitchen/diner, multiple reception rooms, a principal bedroom with ensuite, substantial driveway and a south-facing rear garden, this is a turnkey home in a prime village setting.

”



Situated on Morris Road, one of the most sought-after addresses within South Nutfield village, this beautifully presented four-bedroom detached home offers generous and well-balanced accommodation, a substantial driveway, and a desirable south-facing rear garden. The property has been modernised throughout and is presented in excellent decorative order, ready for immediate occupation.

The accommodation begins with a welcoming reception hall, leading through to a bright and spacious through sitting room, providing an elegant main living area with excellent natural light. A separate family room offers additional versatility, ideal for more informal living or a playroom. The kitchen/diner is well-appointed and thoughtfully designed, with the added benefit of a utility room positioned behind, along with a convenient cloakroom.

Upstairs, the principal bedroom benefits from its own ensuite shower room, while three further well-proportioned bedrooms are served by a modern family bathroom, creating a layout perfectly suited to family life.

Externally, the property continues to impress with a substantial driveway providing ample off-street parking. To the rear, the south-facing garden offers a private and sunny aspect, with a terrace ideal for outdoor dining and a well-maintained lawn completing the space.



Need to know

- Detached family home on highly desirable Morris Road in South Nutfield village
- Four well-proportioned bedrooms including principal suite with ensuite shower room
- Modernised throughout with high-quality finish and move-in ready condition
- Spacious through lounge offering excellent natural light and versatile living space
- Separate family room ideal as snug, playroom or home office
- Front-aspect kitchen/diner designed for modern family living and entertaining
- Separate utility room and ground floor cloakroom for added practicality
- South-facing rear garden with terrace, perfect for outdoor dining and summer use
- Substantial driveway providing ample off-street parking for multiple vehicles
- Sought-after village location within easy reach of local amenities, countryside walks and transport links

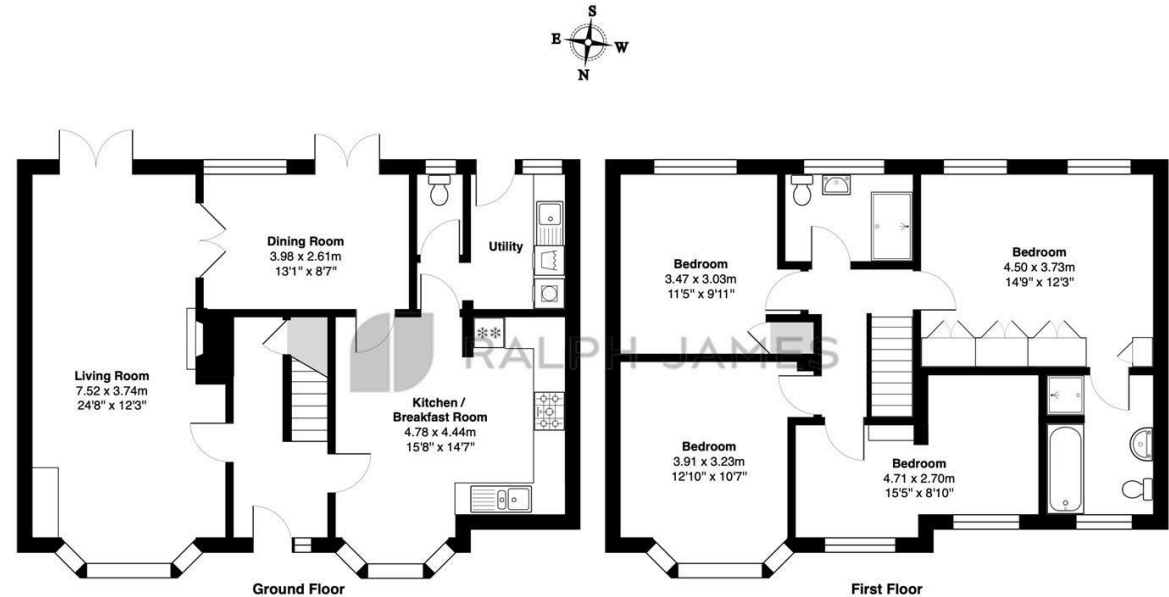

Morris Road, South Nutfield, Redhill
Total Area: 145.1 m² ... 1561 ft²
FOR ILLUSTRATIVE PURPOSES ONLY.

Whilst every attempt has been made to ensure the accuracy of the floor plan shown, all measurements, positioning, fixtures, features, fittings and any other data shown are an approximate interpretation for illustrative purposes only and are not to scale.

No responsibility is taken for any error, omission, miss-statement or use of data shown.

The above statement applies to both 'Still Moving London LTD' and the Company or individual displaying this floor plan.

Unauthorised reproduction prohibited.

© Still Moving London LTD (www.stillmoving.london)



Interested?

redhill@ralphjames.co.uk
01737 765 555

ralphjames.co.uk