



Clifton Place
Hyde Park, W2

CHESTERTONS





This beautifully refurbished 1,150 sqft apartment on Clifton Place, W2, offers three generous double bedrooms and two luxurious bathrooms, complemented by a spacious and naturally well-lit interior with wood floors throughout.

South-facing and finished to a high standard, the property features air-conditioning and a built-in Sonos sound system, ensuring comfort and entertainment at your fingertips. Residents benefit from a porter and access to a large communal roof terrace and garden on the top floor, boasting spectacular views over London and Hyde Park.

Enviably close to Paddington Station, Lancaster Gate, Hyde Park, and the charming Connaught Village, this home combines elegance, modern convenience, and a prime location.

- Three double bedrooms and two modern bathrooms
- South-facing, natural light
- 1,150 sqft space
- High standard refurbishment
- Air-conditioning throughout

£5,500 pcm

Additional tenant charges apply (fees apply to non-AST tenancies only)

Tenancy Agreement Fee: £300

References per Tenant/Guarantor: £60

Inventory check (approx. £100 – £250 inc. VAT)

chestertons.co.uk/property-to-rent/applicable-fees

Energy Efficiency Rating		
Most energy efficient - lower running costs	Current	Potential
92-100 A		
81-91 B		
69-80 C		
55-68 D		
49-54 E		
41-48 F		
31-39 G		
Not energy efficient - higher running costs		
EU Directive 2002/91/EC		

Minimum Term: 12 months
Deposit Required: Five weeks
Local Authority: Westminster
Council Tax Band: G
EPC Rating: D
Furnished

Chestertons Hyde Park & Marylebone Lettings

40 Connaught Street
 Hyde Park & Marylebone
 London
 W2 2AB

hydeparklettingsusers@chestertons.co.uk
 02072985950

Clifton Place,
Hyde Park, W2

○ - Ceiling Height

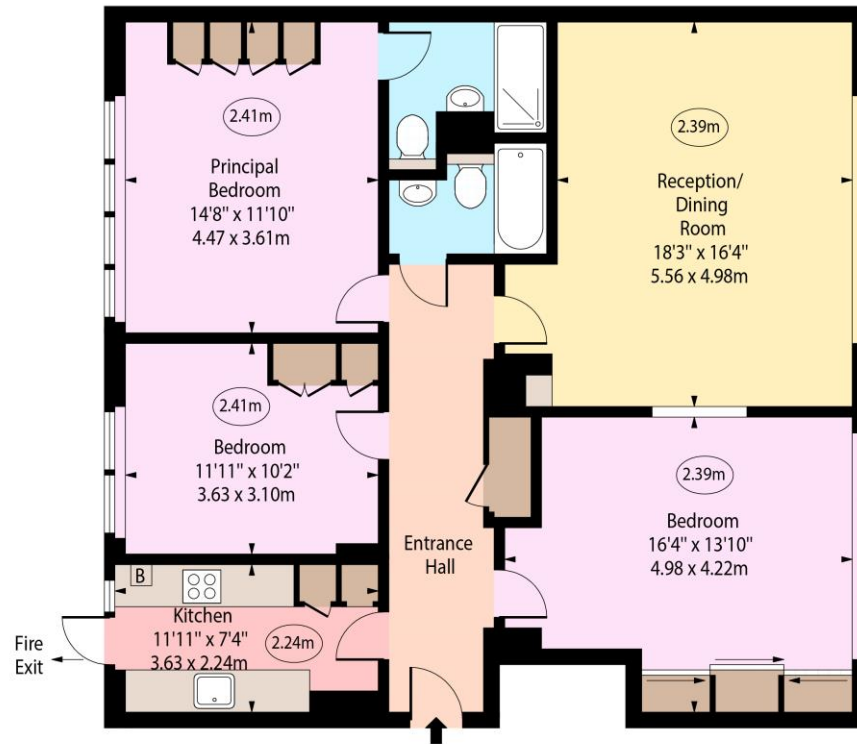
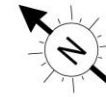

Raised Ground Floor

Approx Gross Internal Area 1150 Sq Ft - 106.83 Sq M

For Illustration Purposes Only - Not To Scale

Chesterton UK Services Limited trading as Chestertons for themselves and for the vendor of this property whose agents they are, give notice that (i) these particulars do not constitute any part of an offer or contract, (ii) all statements contained within these particulars are made without responsibility on the part of Chestertons or the vendor, (iii) whilst made in good faith, none of the statements contained within these particulars are to be relied upon as a statement or representation of fact, (iv) any intending purchasers must satisfy themselves by inspection or otherwise as to the correctness of each of the statements contained within these particulars, (v) the vendor does not make or give either Chestertons or any person in their employment any authority to make or give representation or warranty whatsoever in relation to this property. Wide angle lenses may be used. ©Copyright Chestertons | Chesterton Global Ltd | Registered Office 40 Connaught Street, Hyde Park, London W2 2AB Registered Company Number 05334580.



This paper is
100% recyclable