



PORTAL WAY, W3

£2,300 pcm

Perched on the 36th floor, this 566 sq/ft apartment offers breathtaking views from a private glass balcony. Features include wide-panelled oak flooring, energy-efficient underfloor

- High-Floor 36th Level
- Private Glass Balcony
- Gym & Yoga Suite
- 24-Hour Concierge Service
- Central & Elizabeth Lines
- Keyless Access Entry



ABOUT THE HOME

Located in the landmark Icon Tower, residents enjoy world-class amenities including a 24-hour concierge, gym, and private bar. Strategically positioned minutes from North Acton and Acton Mainline for rapid commuting.





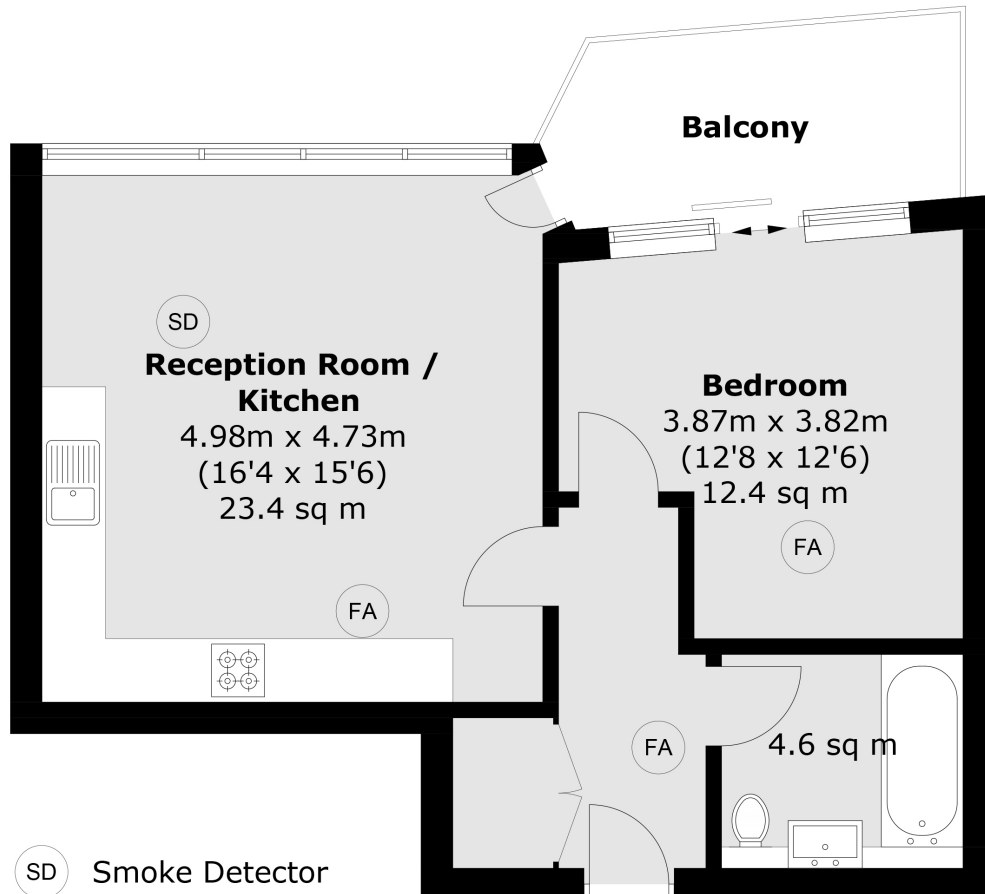

Total area (approx.): 48.5 sq. m (522.0 sq. ft)
Balcony area (approx.): 6.6 sq. m (71.0 sq. ft)

LiFE RESIDENTIAL

203 Trentham Court, Victoria
Road, London, W3 6BT
Sales: 020 3668 1112
Lettings: 020 3668 1111

Energy Rating: B. We aim to make our particulars both accurate and reliable. However they are not guaranteed; nor do they form part of an offer or contract. If you require clarification on any points then please contact us, especially if you're traveling some distance to view. Please note that appliances and heating systems have not been tested and therefore no warranties can be given as to their good working order.