

TO LET

Summerwood Road, Isleworth, TW7 7QZ
£1,400 Per Calendar Month

DBK
ESTATE AGENTS

- Available to Rent End of June!
- One Bedroom
- Fitted Kitchen
- Ample Parking for Residents and Visitors
- Circa 390 Sq.Ft
- First Floor Apartment
- Spacious Reception Room
- Stylish Bathroom
- Communal Gardens
- Twickenham Station 0.8 Miles

GROUND FLOOR

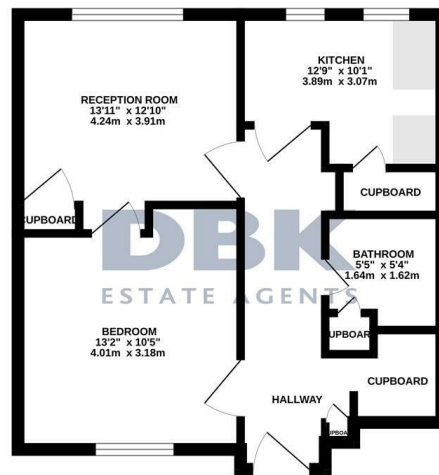

While every attempt has been made to ensure the accuracy of the floorplan contained herein, measurements of doors, windows, stairs and any other items are approximate and are not intended to be used for any specific purpose or measurement. The plan is for illustrative purposes only and should be used to guide the prospective purchaser. The services, systems and appliances shown have not been tested and no guarantee is to be given by the agent or the advertiser. Made with Metropix 2025

THE PROPERTY

Available to Rent End of June!

This well presented first floor apartment offers bright and comfortable living in a desirable Twickenham location. With approximately 390 sq. ft of accommodation, it is ideal for a professional or couple seeking a stylish and practical home.

The property features a spacious reception room, perfect for both relaxing and entertaining, along with a fitted kitchen designed to maximise storage and functionality. A generous double bedroom and a modern, stylish bathroom complete the accommodation.

Residents benefit from ample parking for both residents and visitors, as well as access to well-maintained communal gardens. For commuters, Twickenham Station is conveniently located just 0.8 miles away, providing excellent transport links into Central London and beyond.