



## Northbourne Road, SW4

### £650,000

A fantastic lateral period conversion with a private entrance, arranged over the ground floor of an impressive detached Victorian property. The property comprises a spacious reception room with ample space for both relaxing and dining, a separate well-equipped kitchen, and two well-proportioned double bedrooms with fitted wardrobes, alongside a modern bathroom. Outside there is a substantial, low maintenance private garden. Offered to the market with a share of freehold and no onward chain.

Northbourne Road is a quiet, tree lined street close to Clapham Common and a short distance from the charming shops, bars and restaurants of the Abbeville Village. Clapham High Street (Overground) and Clapham Common (Underground) stations close by serving the West End and City.

### Features

- Period Conversion
- Two Double Bedrooms
- Private Entrance
- Private Garden
- Share Of Freehold
- Chain Free

# Northbourne Road, London, SW4

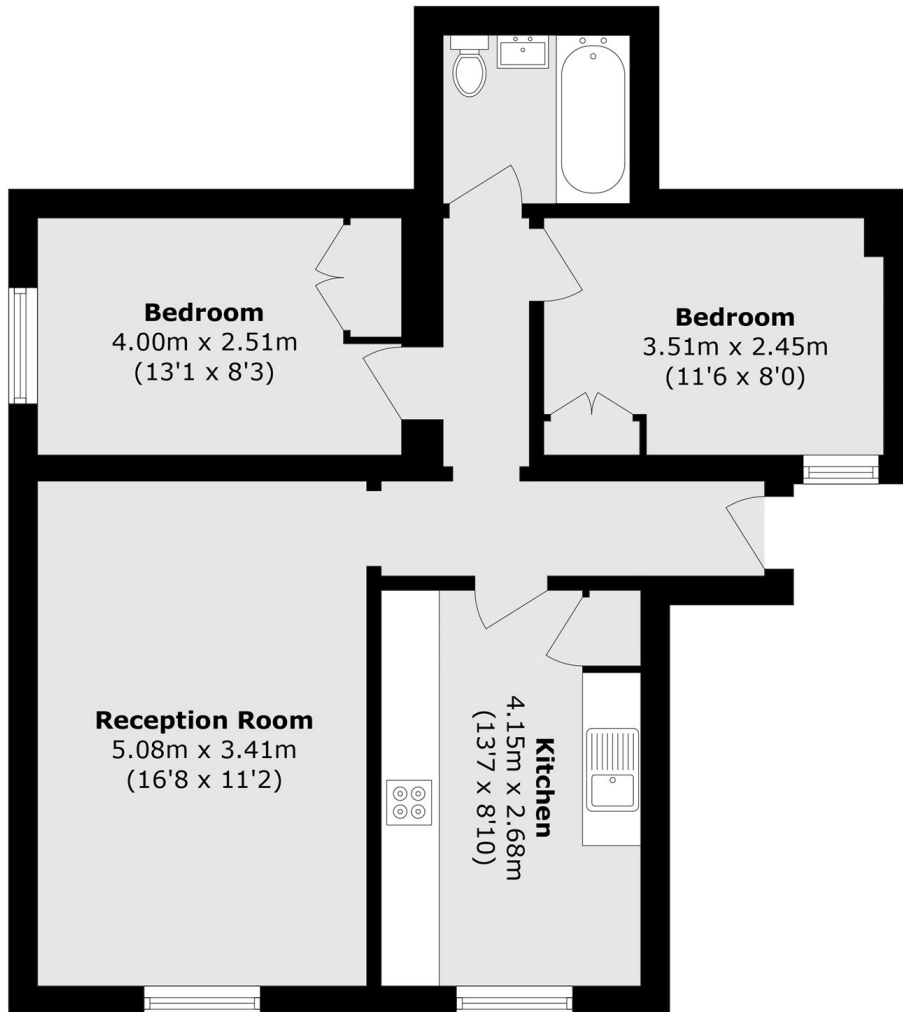

Total area (approx.): 60.9 sq. m (655.5 sq. ft)