



ST PAULS AVENUE

WILLEDEN GREEN, LONDON, NW2 5SX

£1,850 PER CALENDAR MONTH

A delightful ground floor flat with private street entrance is available to rent in St. Pauls Avenue, just a short stroll from Willesden Green Station. The accommodation comprises an open plan kitchen/reception, one double bedroom and shower/wc.

The property is exceptionally presented throughout and is available from 1st July 2026.

Located close to the ample amenities of Walm Lane & Willesden High Road. The ever popular Gladstone Park is within also within walking distance.

Offered: Furnished.

Council Tax: Brent Band C - £1,896 annually.

Energy Rating: 73/C

PRE-TENANCY PHOTOGRAPHS SHOWN

- GROUND FLOOR FLAT WITH PRIVATE ENTRANCE
- ONE DOUBLE BEDROOM
- OPEN PLAN KITCHEN / RECEPTION
- LOCATED CLOSE TO WILLEDEN GREEN STATION
- OFFERED: FURNISHED
- AVAILABLE FROM 1st JULY 2026
- PRE-TENANCY PHOTOGRAPHS SHOWN

VIEWING

Please contact our Wenlock & Taylor Office on 020 8969 0122 if you wish to arrange a viewing appointment for this property or require further information



FLOOR PLAN

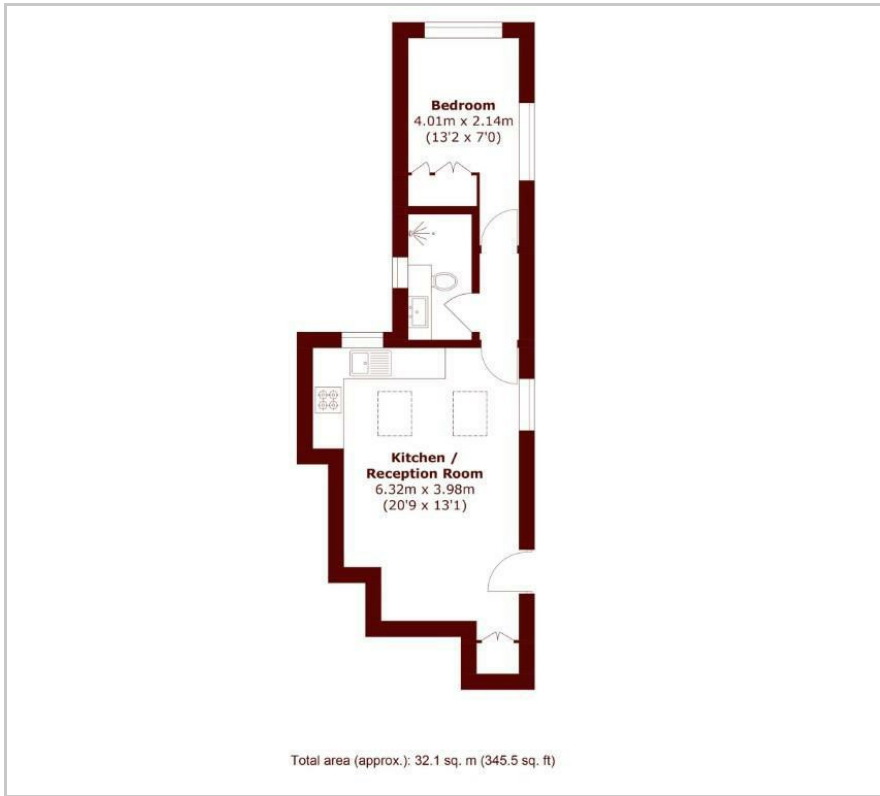

AREA MAP



ENERGY EFFICIENCY GRAPH

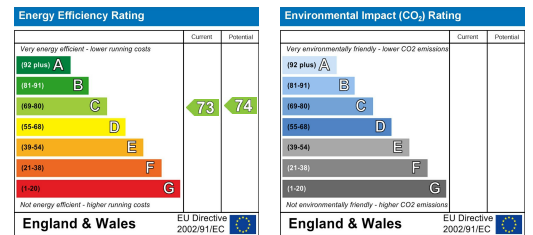

These particulars, whilst believed to be accurate are set out as a general outline only for guidance and do not constitute any part of an offer or contract. Intending purchasers should not rely on them as statements of representation of fact, but must satisfy themselves by inspection or otherwise as to their accuracy. No person in this firm's employment has the authority to make or give any representation or warranty in respect of the property.