



14 John Spencer Square, London, N1 2LZ

£950 Per Week

- Communal Garden
- Highbury & Islington Tube





# 14 John Spencer Square, London N1 2LZ

Alwyne Estates are proud to present this truly spectacular 2 double bedroom raised ground floor apartment. This property has been finished to a high standard and really is one of the most impressive properties in this development.

Tastefully designed, this property has an open-plan feel and is flooded with natural light throughout, the bespoke fitted kitchen is excellent for those who like to cook with plenty of worktop space, set off the kitchen is a spacious living space. The bathroom is fully tiled and finished with a large walk in shower. The property also has two excellent sized double bedrooms, equipped with an abundance of storage and views onto the picturesque communal garden square.

The property is ideally located in the highly sought-after John Spencer Square, a short walk from Highbury & Islington station and the various amenities of Upper Street.



Council Tax Band: E



John Spencer Square, N1  
 Approx gross internal area  
 769 Sq.Ft / 71.42 Sq.Mt  
 Raised Ground Floor

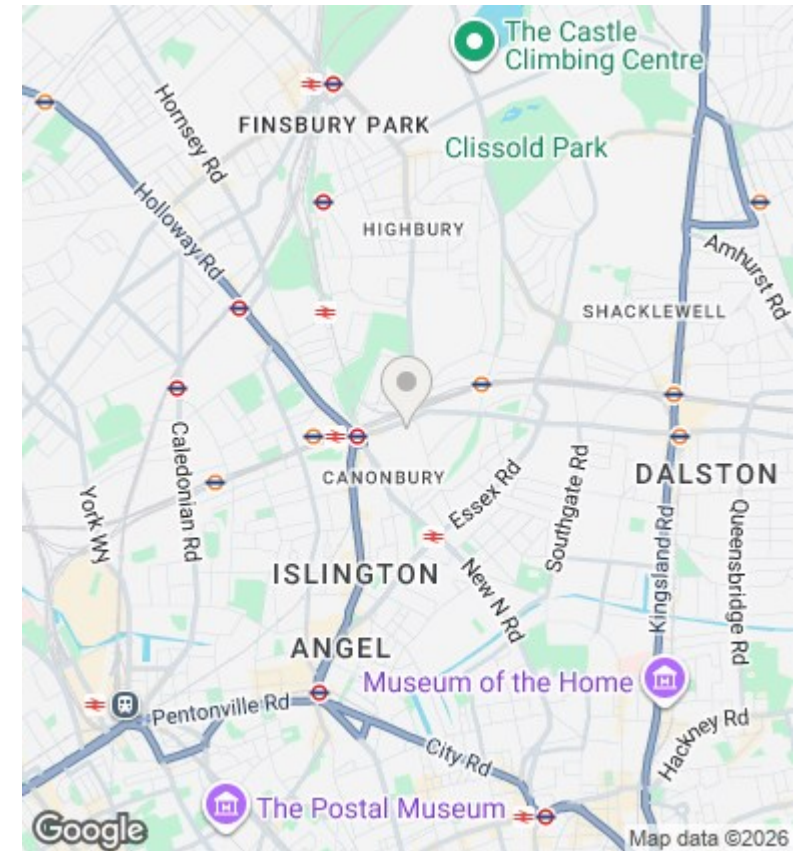
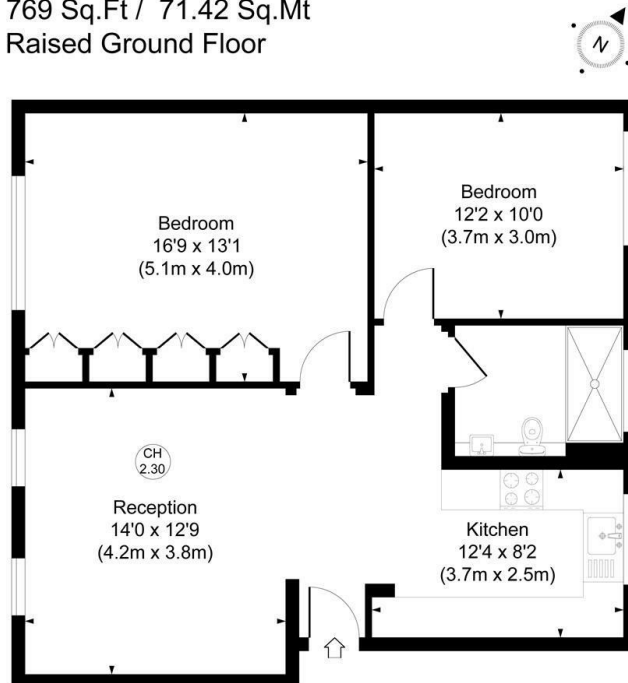

## Directions

## Viewings

Viewings by arrangement only. Call 02073593191 to make an appointment.

## Council Tax Band

E

Energy Efficiency Rating		
	Current	Potential
Very energy efficient - lower running costs		
(92 plus) A		
(81-91) B		82
(69-80) C		
(55-68) D	67	
(39-54) E		
(21-38) F		
(1-20) G		
Not energy efficient - higher running costs		
England & Wales	EU Directive 2002/91/EC	

### Full description

Alwyne Estates are proud to present this truly spectacular 2 double bedroom raised ground floor apartment. This property has been finished to a high standard and really is one of the most impressive properties in this development.

Tastefully designed, this property has an open-plan feel and is flooded with natural light throughout, the bespoke fitted kitchen is excellent for those who like to cook with plenty of worktop space, set off the kitchen is a spacious living space. The bathroom is fully tiled and finished with a large walk in shower. The property also has two excellent sized double bedrooms, equipped with an abundance of storage and views onto the picturesque communal garden square.

The property is ideally located in the highly sought-after John Spencer Square, a short walk from Highbury & Islington station and the various amenities of Upper Street.





