

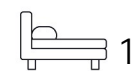

Living
made
better

Chenla Building
Lewisham, SE13 7FE



Offers In Excess Of £300,000

Chenla Building, Lewisham, SE13 7FE

Madison Brook

Property Summary

A larger-than-average one bedroom apartment set within the sought-after Chenla Building, offering 656 sq.ft. of living space with a bright open-plan kitchen/reception, double bedroom with built-in storage and modern bathroom. Residents benefit from a 24-hour concierge, gym, and allocated parking space. Lewisham Station is just 0.3 miles away, while Elverson Road DLR station is 0.1 miles away. Offered chain free.

Service Charge: £4,907.62 pa | Ground Rent: £350 pa | Lease Remaining: 982 years

Floorplan

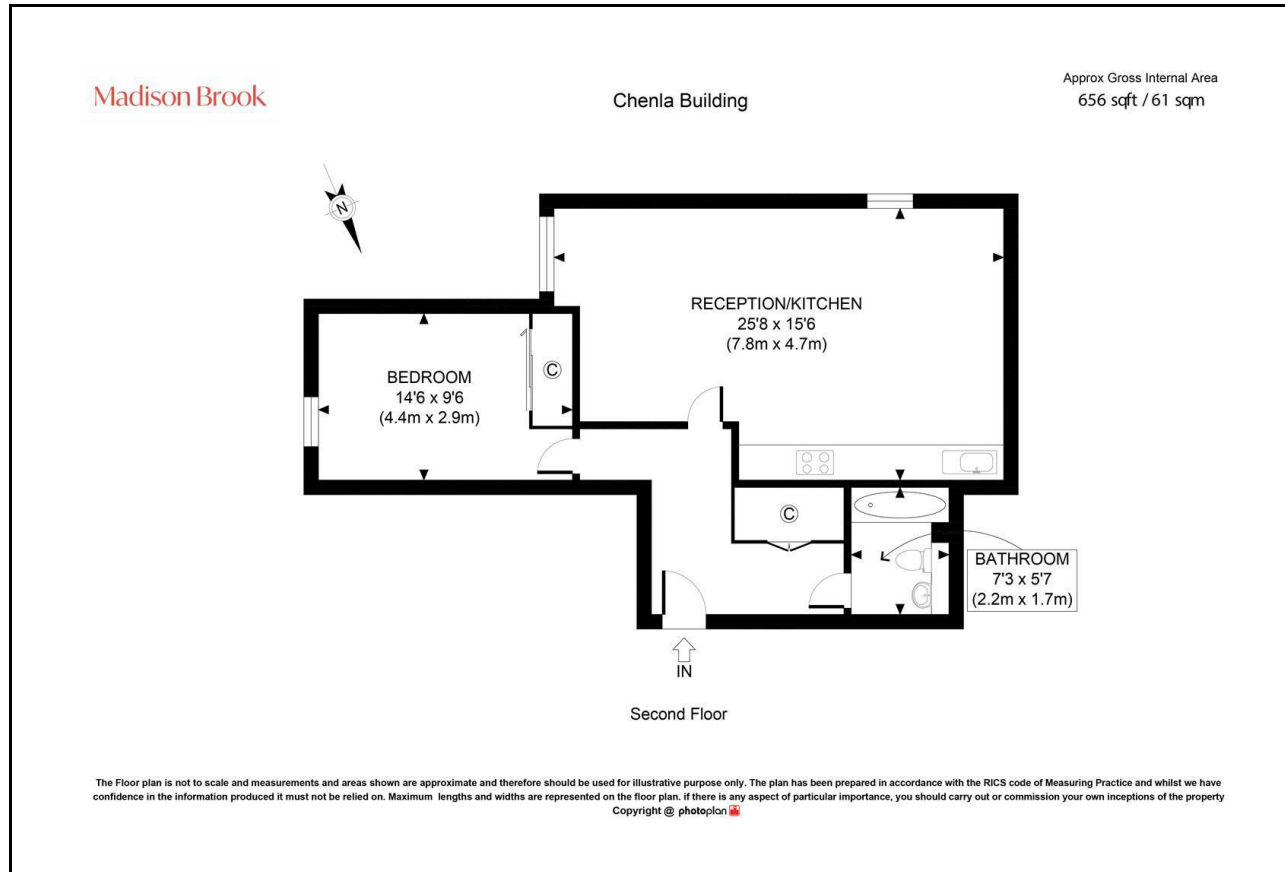

Area Map

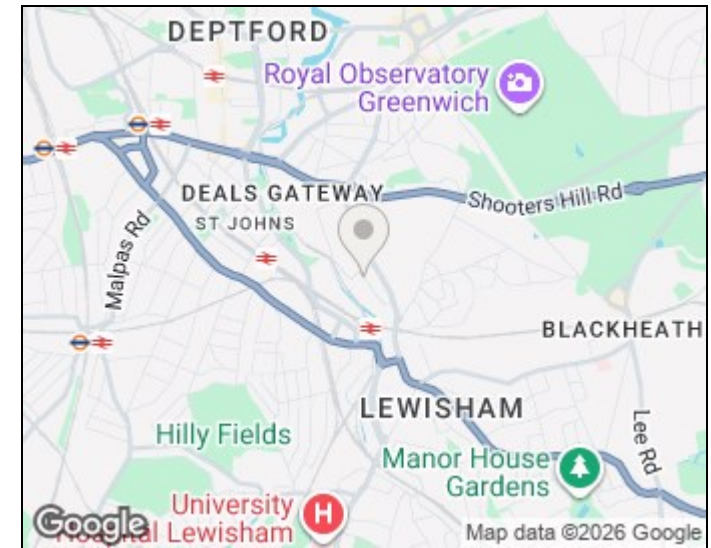

Energy Efficiency Graph

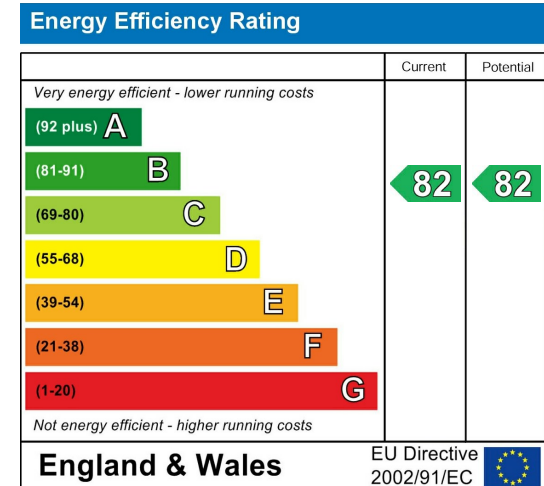

These particulars, whilst believed to be accurate are set out as a general outline only for guidance and do not constitute any part of an offer or contract. Intending purchasers should not rely on them as statements of representation of fact, but must satisfy themselves by inspection or otherwise as to their accuracy. No person in this firm's employment has the authority to make or give any representation or warranty in respect of the property.

43 Loampit Vale, Lewisham, London, SE13 7FT

Tel: 020 3946 6200 Email:

lewisham@madisonbrook.com

<https://madisonbrook.com/>