

Indescon Square, E14

£323 Per week

A bright studio apartment on the fourth floor of this sought after development. This modern apartment has wooden flooring, a separate sleeping area and a private balcony.

Indescon Square is in the heart of South Quay, moments from Millharbour Dock and a selection of shops, bars and restaurants in Canary Wharf.

Features

- Studio Apartment
- Fourth Floor
- Concierge
- Private Balcony
- Wooden Flooring
- Ample Storage

Indescon Square, London, E14

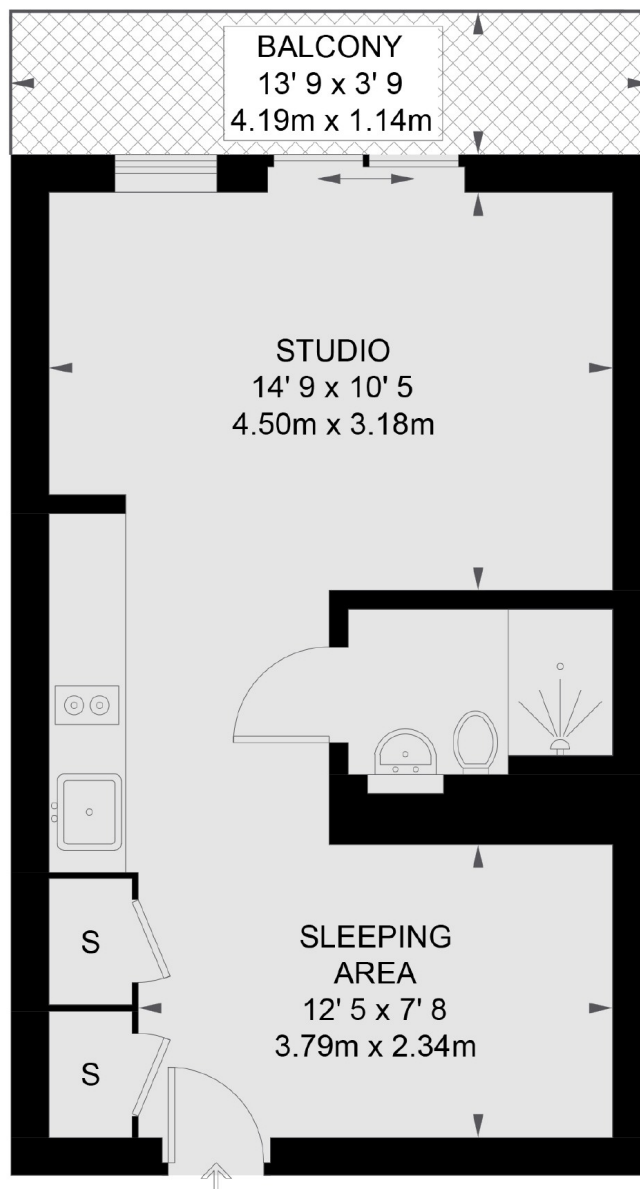

FIRST FLOOR

TOTAL APPROX. FLOOR AREA 370 SQ. FT. (34.4 SQ. M.)

TOTAL APPROX. BALCONY AREA 51 SQ. FT. (4.7 SQ. M.)